

ADDENDUM NO. 3
TO THE CONTRACT DOCUMENTS
for the construction of the
NAMPA WWTP PHASE I UPGRADES:
GROUP A—LIQUID STREAM UPGRADES

Date: February 27, 2015
Project No.: 480770

To All Planholders and/or Prospective Bidders:

The following changes, additions, and/or deletions are hereby made a part of the Contract Documents for the construction of the Nampa WWTP Phase I Upgrades: Group A—Liquid Stream Upgrades, dated December 2014, as fully and completely as if the same were fully set forth therein:

A. PART 1—PROCUREMENT REQUIREMENTS

1. Section 00 11 00, Advertisement: In the paragraph that starts “A pre-bid conference will...”, ADD the following at the end of the second sentence of the paragraph: “and March 17, 2014.”

B. DRAWINGS

1. Drawing 050-D-108¹: REPLACE the drawing in its entirety.
2. Drawing 050-D-109²: REPLACE the drawing in its entirety.
3. Drawing 050-D-114³: REPLACE the drawing in its entirety.
4. Drawing 050-D-301⁴: REPLACE the drawing in its entirety.
5. Drawing 050-D-302⁵: REPLACE the drawing in its entirety.
6. Drawing 423-M-111: CHANGE the callout in General Sheet Note 2 from “Detail 2” to “Detail 1”.

D. OTHER INFORMATION

1. Project Site Visit and Tour Documentation⁶: A Project site visit and tour was held on February 25, 2015. REFERENCE attached documentation from the meeting for the use of the bidders.
2. As described in Part 1 of this addendum, an additional Project site visit and tour has been scheduled. Attendance is not a requirement of bidding. The Site visit will be similar to the previous events. Including this additional site visit, the remaining site visits are March 4, 2015 and March 17, 2015 from 9:00 a.m. to 12:00 p.m.
3. Bidders’ Questions/Engineer Responses⁷: REFERENCE attached list of Bidders’ questions (written) and the associated response from the Engineer.

All Bidders shall acknowledge receipt and acceptance of this Addendum No. 3 in the Bid Form or by submitting the Addendum with the bid package. Bid Forms submitted without acknowledgment or without this Addendum will be considered in nonconformance.

CH2M HILL

Project Manager

END OF ADDENDUM

¹ Drawing 050-D-108

² Drawing 050-D-109

³ Drawing 050-D-114

⁴ Drawing 050-D-301

⁵ Drawing 050-D-302

⁶ Project Site Visit and Tour Documentation

- Site Visit Sign In Sheet
- Contractor Plant Site Visit Questions

⁷ Bidders' Questions/Engineer Responses

A
B
C
D

MATCH LINE, SEE 050-D-113

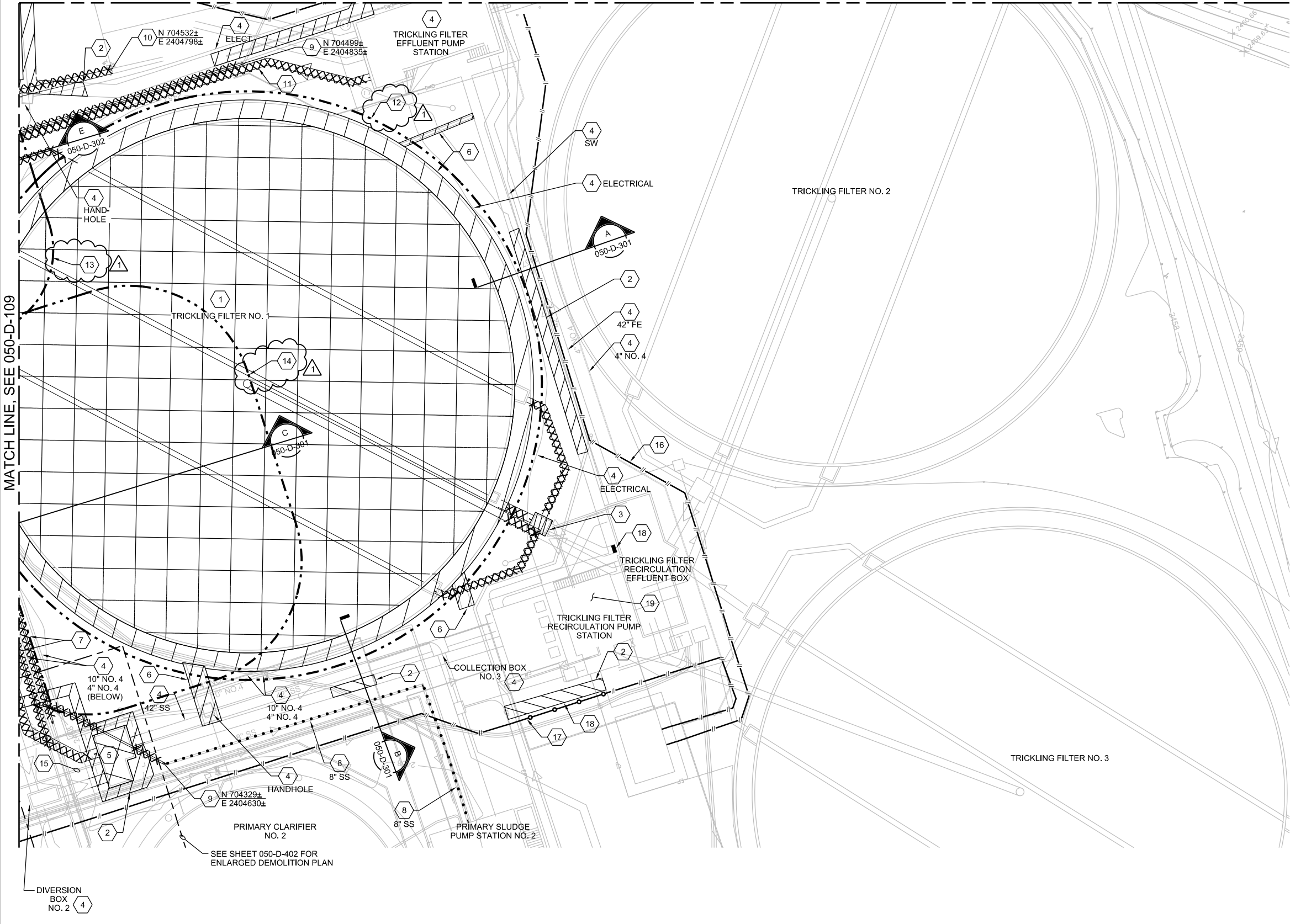

SHEET KEYNOTES

1. DEMOLISH TRICKLING FILTER NO. 1. REFER TO RECORD DRAWINGS FOR MORE INFORMATION INCLUDING, BUT NOT LIMITED TO, DEPTH. SEE SPECIFICATIONS FOR SALVAGE INFORMATION.
2. SAWCUT AND DEMOLISH CONCRETE SIDEWALK.
3. DEMOLISH CONVEYANCE STRUCTURE/CONCRETE VAULT. CAP AND ABANDON PIPES IN PLACE.
4. RETAIN AND PROTECT.
5. DEMOLISH PRIMARY EFFLUENT SPLITTER BOX CONCRETE STRUCTURE INCLUDING INTERNAL PIPING AND VALVES. BYPASS PER 050-CY-108.
6. DEMOLISH CONCRETE RIBBON CURB. REMOVE AND STOCKPILE GRAVEL SURFACE TREATMENT FOR REUSE.
7. DEMOLISH 8" SS PIPE.
8. ABANDON IN PLACE.
9. DEMOLISH 8" SS PIPE TO FITTING SHOWN AND PLUG, FIELD LOCATE.
10. DEMOLISH NO. 4 WATER SERVICE PER 050-CY-108. REROUTE TO SECONDARY CLARIFIER NO. 2.
11. DEMOLISH 30' FE BETWEEN TRICKLING FILTER EFFLUENT PUMP STATION AND SECONDARY CLARIFIER NO. 1. PLUG AT FITTING NEAREST TRICKLING FILTER EFFLUENT PUMP STATION.
12. APPROXIMATE EXCAVATION LIMITS OF TRICKLING FILTER NO. 1 DEMOLITION.
13. APPROXIMATE LIMITS OF EXCAVATION FOR AERATION BASIN 3 CONSTRUCTION.
14. APPROXIMATE LIMITS OF EXCAVATION FOR PEPS CONSTRUCTION.
15. 8" LINE IS CONNECTED TO A FLEXIBLE HOSE FROM THE SUMP IN THE DIGESTER CONTROL BUILDING. CONTRACTOR TO REROUTE THE HOSE TO FACILITATE THE ABANDONMENT OF THE 8" LINE.
16. SILT FENCE PER BMP-36.
17. STRAW WATTLES PER BMP-36.
18. SAWCUT AND REMOVE ASPHALT PAVEMENT IN ORDER TO PROVIDE ADEQUATE ROOM FOR CONTRACTOR FOR FUTURE INSTALLATION OF ELECTRICAL DUCTBANK PER DETAIL (2805-400).
19. INSTALL CONCRETE PLUG IN 36" RETURN PIPE FROM TRICKLING FILTER NO. 1 AT EFFLUENT BOX.
20. REMOVE WEIR GATE TO TRICKLING FILTER NO. 1 AT HEAD BOX AND SALVAGE TO OWNER.

ORIGINAL DOCUMENT SIGNED BY REGISTRANT ON DECEMBER 16, 2014.

PROFESSIONAL ENGINEER
REGISTERED
13300
STATE OF IDAHO
AMANDA MARIE SMITH

ORIGINAL DOCUMENT STORED AT CH2MHILL/BOISE, ID.

NO.	DATE	REVISION	BY	APVD
1	2015/02/23	ADDENDUM 3	AT	AT

DR: A THOMPSON
CHK: B ROBERTS
APVD: G THOMPSON

NAMPA WWTP PHASE 1 UPGRADES
PROJECT GROUP A
CITY OF NAMPA
NAMPA, IDAHO

CH2MHILL
CIVIL

**DEMOLITION PLAN
AREA 8**

AS NOTED
VERIFY SCALE
BAR IS ONE INCH ON ORIGINAL DRAWING.
DATE: DECEMBER 2014
PROJ: 480770
DWG: 050-D-108
SHEET: 26 of 157

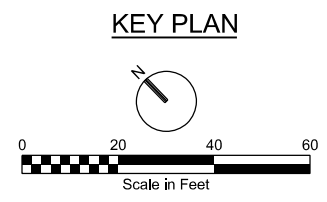
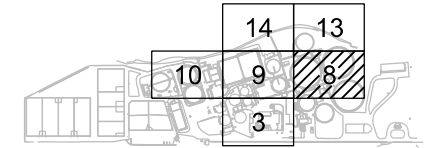

SHEET KEYNOTES

1. DEMOLISH SECONDARY CLARIFIER NO. 1.
2. DEMOLISH SECONDARY EFFLUENT PUMP STATION.
3. DEMOLISH SECONDARY SLUDGE PUMP STATION.
4. DEMOLISH PARSHALL FLUME NO. 3.
5. SAWCUT AND DEMOLISH CONCRETE SIDEWALK.
6. DEMOLISH 15" TOF AND REROUTE TO PEPS, SEE 050-CY-109.

SHEET KEYNOTES

7. DEMOLISH 48" ML TO APPROXIMATE LOCATION SHOWN.
8. RETAIN AND PROTECT.
9. DEMOLISH NO. 4 WATER SERVICE AND REROUTE TO SECONDARY CLARIFIER NO. 2, SEE 050-CY-113 AND 114.
10. DEMOLISH NO. 4 WATER SERVICE TO EXISTING CONNECTION AND CAP.
11. DEMOLISH 8" SS AND REROUTE TO HEADWORKS, SEE 050-CY-108.
12. DEMOLISH 8" SS.

SHEET KEYNOTES

13. DEMOLISH CONCRETE RIBBON CURB AND GRAVEL SURFACE TREATMENT.
14. SAWCUT AND DEMOLISH ASPHALT PAVEMENT.
15. APPROXIMATE LOCATION OF SOIL BENTONITE WALL, REMOVE AS REQUIRED TO PROVIDE WORK.
16. APPROXIMATE LIMITS OF EXCAVATION FOR TRICKLING FILTER DEMOLITION.
17. DEMOLISH 21" SI.
18. DEMOLISH 42" SI.
19. DEMOLISH 6" NO. 4.
20. DEMOLISH 8" UD TO APPROXIMATE LOCATION SHOWN.
21. DEMOLISH 42" PE BETWEEN PARSHALL FLUME NO. 3 AND PRIMARY EFFLUENT SPLITTER BOX.
22. CONTRACTOR TO PROVIDE TEMPORARY REROUTE OF 10" NO. 4 AS NEEDED FOR EXCAVATION OF AERATION BASIN 3 AND EXCAVATION OF PEPS AND TEMPORARY REROUTE OF 8" NO. 4 FOR EXCAVATION OF PEPS.
23. DEMOLISH 8" UD AND ASSOCIATED STORM WATER PIPING MANHOLES AND CATCH BASINS.
24. DEMOLISH 42" PE.
25. DEMOLISH 30" ALP AND FITTINGS.
26. DEMOLISH ABOVE GRADE 30" ALP AND 90° FITTINGS.
27. DEMOLISH CONCRETE VALLEY GUTTER.
28. APPROXIMATE LIMITS OF EXCAVATION FOR CONSTRUCTION OF AERATION BASIN 3.
29. APPROXIMATE EXCAVATION LIMITS FOR CONSTRUCTION OF PEPS.
30. DEMOLISH LIGHT POLE AND REMOVE CONDUCTORS TO PREVIOUS LIGHT POLE IN CIRCUIT.
31. REMOVE ALL CONDUCTORS TO PUMP STATION BACK TO PRIMARY SLUDGE PUMP STATION NO. 1.
32. DEMOLISH HANDHOLE.
33. REMOVE ALL CONDUCTORS TO SECONDARY SLUDGE PUMP STATION BACK THROUGH HANDHOLES TO ADMINISTRATION BUILDING.
34. REMOVE AND RETAIN FOR REUSE.
35. APPROXIMATE LIMITS OF EXCAVATION FOR SECONDARY CLARIFIER NO. 1 DEMOLITION.
36. PRIOR TO THE DEMOLITION OF THE SECONDARY EFFLUENT PUMP STATION, CONTRACTOR TO CONSTRUCT TEMPORARY UTILITY PUMP STATION AND PIPING TO DIVERT TOF AND UD/SD PIPING TO AERATION BASINS 1 AND 2, SEE 050-CY-109 AND 110. SEE SPECIFICATION SECTION 01 57 28 - TEMPORARY FLOW CONTROL, FOR DESIGN CRITERIA.
37. INLET PROTECTION PER BMP-34.
38. STRAW WATTLES PER BMP-35.
39. SILT FENCE PER BMP-36.
40. PREVENT RUNOFF FROM TRAVELING DOWN RAMP TO DIGESTER.
41. SEE SHEETS 421-D-111, 421-D-112, 421-D-301, 422-D-111, 422-D-112 AND 422-D-301 FOR DETAILED DEMOLITION INFORMATION ON PIPING IMMEDIATELY ADJACENT TO AERATION BASINS 1 AND 2.
42. RETAIN AND PROTECT PUMP STATION. CAP OR PLUG THE WET WELL WALL PENETRATION FOR THE 4-INCH DIAMETER DRAIN LINE FROM AB 1 AND 2 WALKWAY THAT ENTERS PUMP STATION FROM THE SOUTH SIDE AT A DEPTH OF ABOUT 5 FEET.

MATCH LINE, SEE 050-D-114

MATCH LINE, SEE 050-D-103

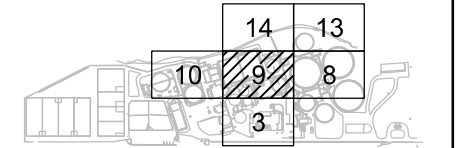
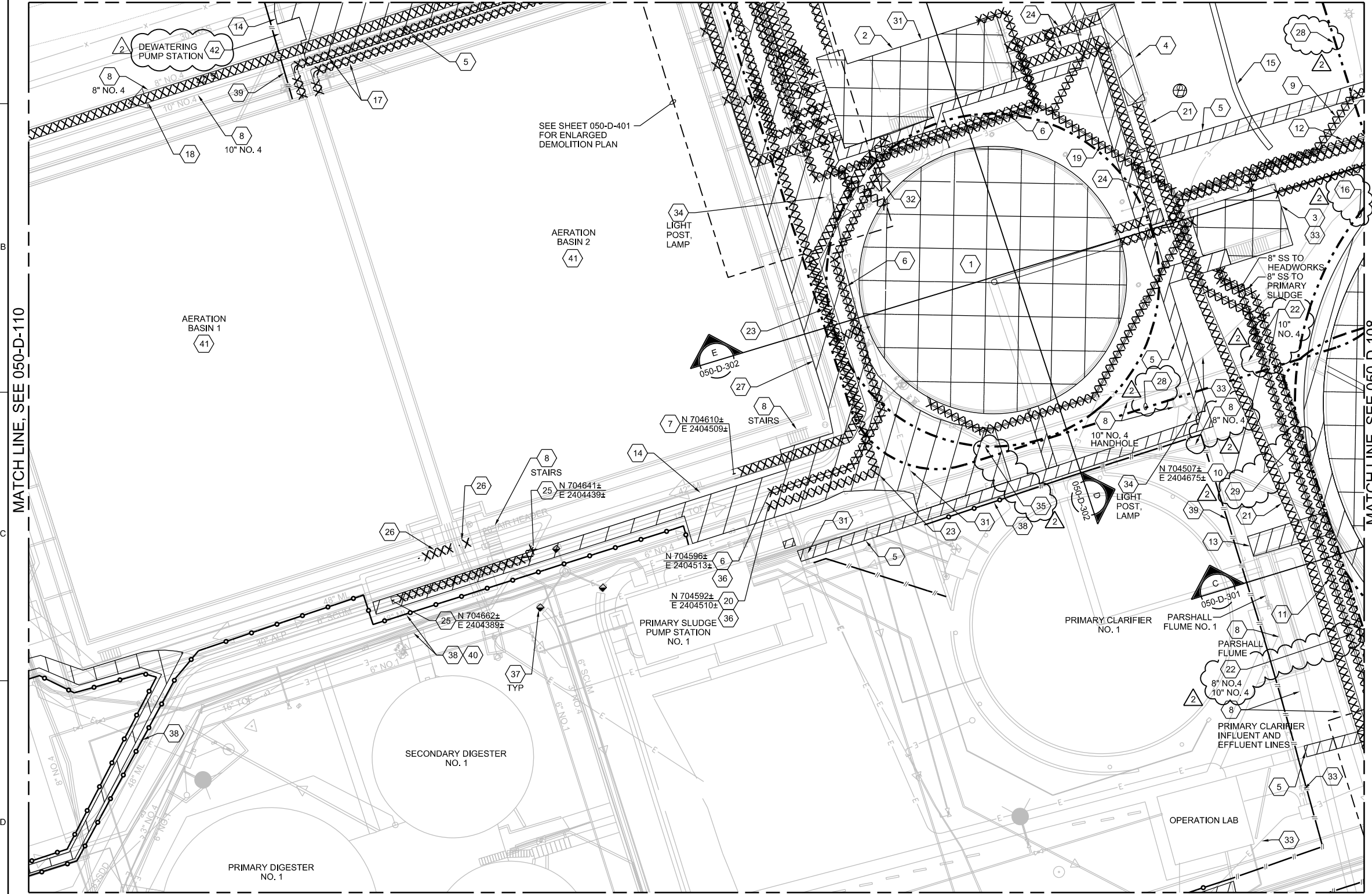

KEY PLAN

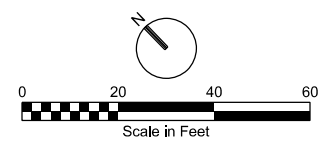

ORIGINAL DOCUMENT SIGNED BY REGISTRANT ON DECEMBER 16, 2014.

ORIGINAL DOCUMENT STORED AT CH2MHILL/BOISE, ID.

NO.	DATE	REVISION	CHK	APVD
2	20150223	ADDENDUM 3		
1	20150211	ADDENDUM 1		

NO.	DATE	DR	APVD
2	20150223	A THOMPSON	
1	20150211	B ROBERTS	

CH2MHILL

CIVIL
DEMOLITION PLAN
AREA 9

NAMPA WWTP PHASE 1 UPGRADES
PROJECT GROUP A
CITY OF NAMPA
NAMPA, IDAHO

AS NOTED
VERIFY SCALE
BAR IS ONE INCH ON ORIGINAL DRAWING.

DATE	DECEMBER 2014
PROJ	480770
DWG	050-D-109
SHEET	27 of 157

A
B
C
D

SHEET KEYNOTES

1. DEMOLISH 42" SI.
2. DEMOLISH CONCRETE SIDEWALK.
3. RETAIN AND PROTECT.
4. DEMOLISH 30" SI.
5. DEMOLISH ASPHALTIC CONCRETE PAVEMENT.
6. APPROXIMATE LOCATION OF SOIL BENTONITE WALL, REMOVE AS REQUIRED TO PROVIDE WORK.
7. DEMOLISH SEGMENT OF EXISTING PERIMETER FENCE, SEE 050-CY-114.
8. DEMOLISH EXISTING UNDERGROUND CONCRETE CHLORINE CONTACT BASIN.
9. APPROXIMATE LIMITS OF EXCAVATION FOR AERATION BASIN 3 CONSTRUCTION.
10. DEMOLISH CMP VAULT AND CONCRETE COLLAR.
11. SILT FENCE PER BMP-36.
12. SEE SHEETS 421-D-111, 421-D-112, 421-D-301, 422-D-111, 422-D-112 AND 422-D-301 FOR DETAILED DEMOLITION INFORMATION ON PIPING IMMEDIATELY ADJACENT TO AERATION BASINS 1 AND 2.
13. CONTRACTOR TO PROVIDE TEMPORARY REROUTE OF 10" NO. 4 AS NEEDED FOR EXCAVATION OF AERATION BASIN 3.

ORIGINAL DOCUMENT SIGNED BY REGISTRANT ON DECEMBER 16, 2014.

PROFESSIONAL ENGINEER
REGISTERED
13300
STATE OF IDAHO
AMANDA MARIE SMITH

ORIGINAL DOCUMENT STORED AT CH2MHILL/BOISE, ID.

NO.	DATE	REVISION	BY	APVD
1	2015/02/23	ADDENDUM 3	AT	AT

DGN	DR	CHK	APVD
A THOMPSON	A THOMPSON	B ROBERTS	G THOMPSON

CH2MHILL
CIVIL

NAMPA WWTP PHASE 1 UPGRADES
PROJECT GROUP A
CITY OF NAMPA
NAMPA, IDAHO

DEMOLITION PLAN
AREA 14

AS NOTED
VERIFY SCALE
BAR IS ONE INCH ON ORIGINAL DRAWING.
0 1"

DATE	DECEMBER 2014
PROJ	480770
DWG	050-D-114
SHEET	30 of 157

BID DOCUMENTS

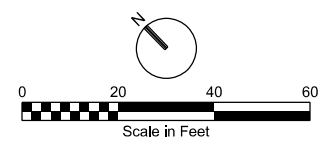
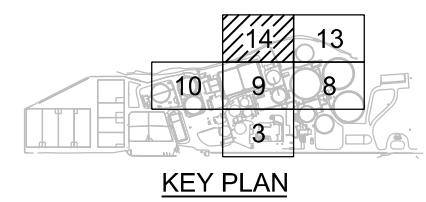
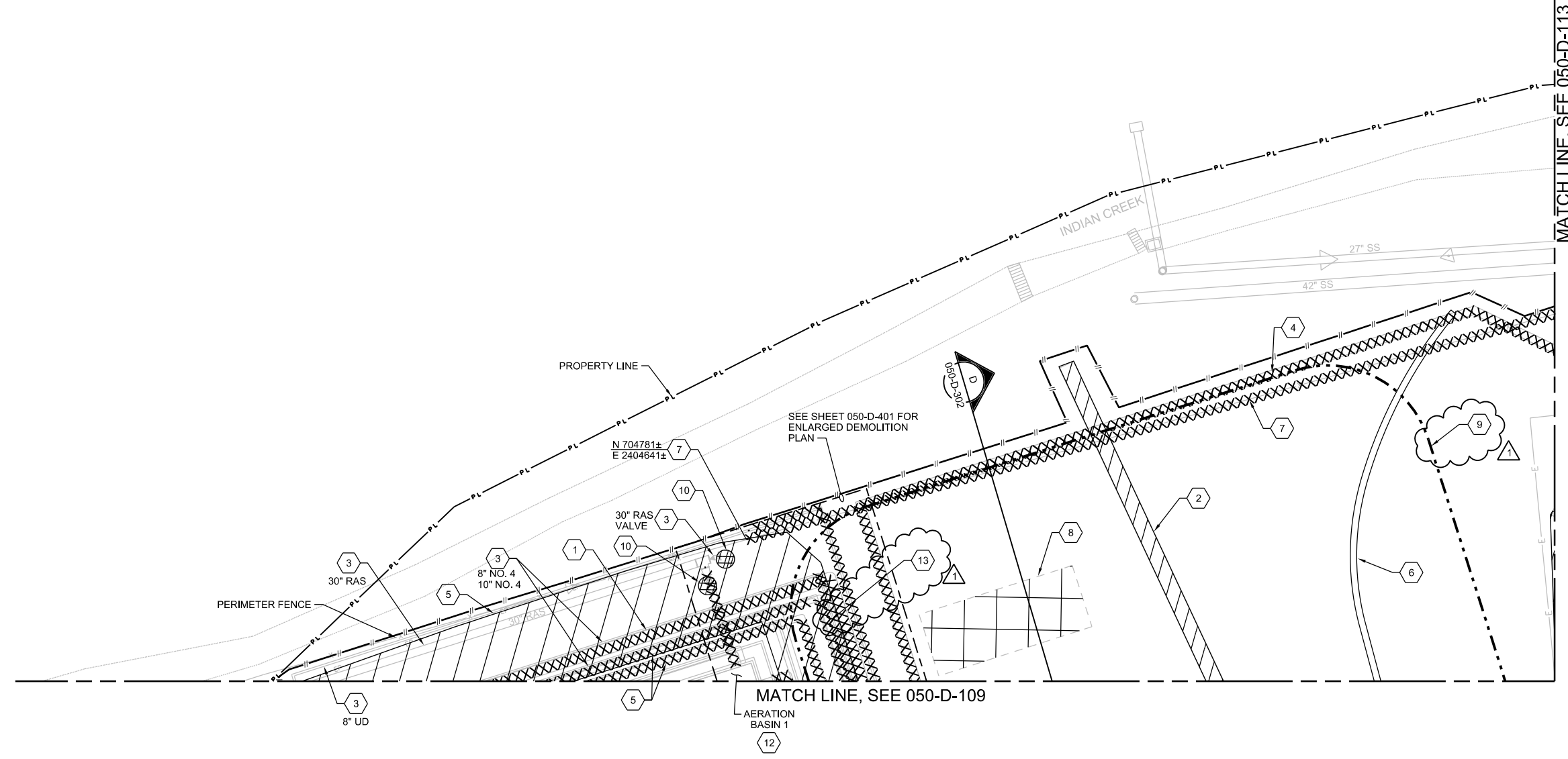

A
B
C
D

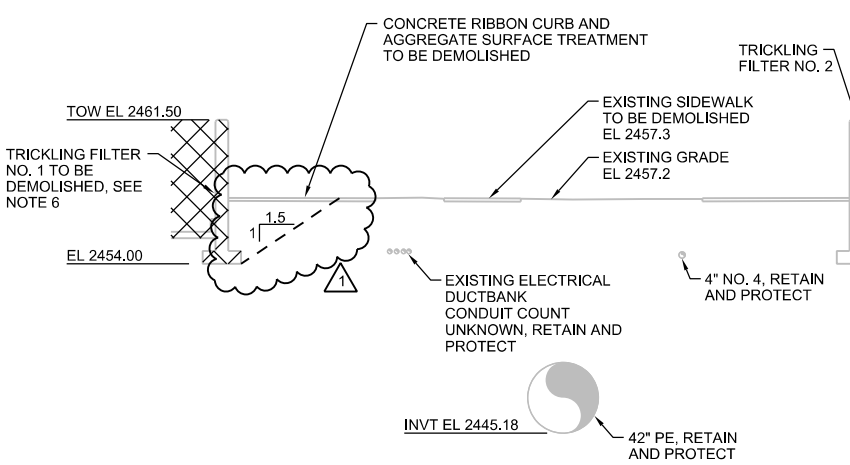

A SECTION
1" = 5'
050-D-108

- NOTES:
- ELEVATIONS AND LOCATIONS OF EXISTING STRUCTURES AND UTILITIES ARE APPROXIMATE. CONTRACTOR TO FIELD VERIFY PRIOR TO CONSTRUCTION.
 - UTILITIES TO THE EAST OF THE TRICKLING FILTER ARE TO BE RETAINED AND PROTECTED DURING DEMOLITION OF THE TRICKLING FILTER.
 - CONTRACTOR TO LOCATE EXISTING UTILITIES PRIOR TO CONSTRUCTION AND PROVIDE DESIGN FOR SHORING IF IT IS DEEMED NECESSARY FOR PROTECTION OF UTILITIES.
 - EXISTING YARD UTILITIES TO BE RETAINED AND PROTECTED UNLESS CALLED OUT AS DEMOLISHED.
 - NO. 4 PIPE ASSUMED TO HAVE 4' OF COVER. CONTRACTOR TO FIELD LOCATE.
 - CONTRACTOR TO SEE REFERENCE DRAWINGS FOR INFORMATION ON EXISTING FACILITIES TO BE DEMOLISHED.

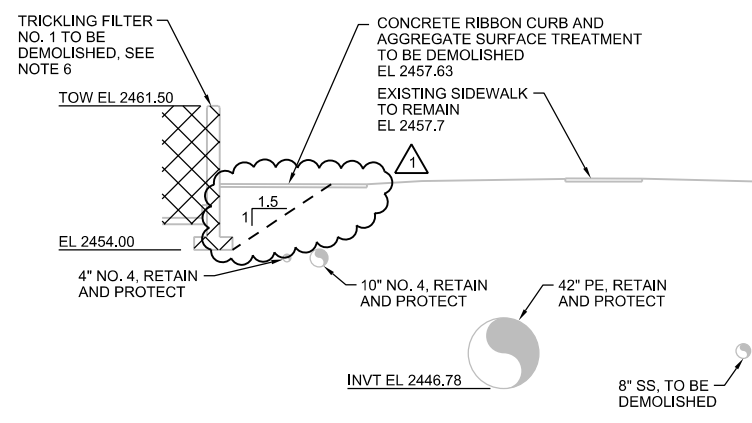

B SECTION
1" = 5'
050-D-108

- NOTES:
- ELEVATIONS AND LOCATIONS OF EXISTING STRUCTURES AND UTILITIES ARE APPROXIMATE. CONTRACTOR TO FIELD VERIFY PRIOR TO CONSTRUCTION.
 - 4" AND 10" NO. 4 TO BE RETAINED AND PROTECTED DURING DEMOLITION OF TRICKLING FILTER, PROVIDE SHORING AS NEEDED. 8" SS TO BE PLUGGED AND ABANDONED.
 - CONTRACTOR TO LOCATE EXISTING UTILITIES PRIOR TO CONSTRUCTION AND PROVIDE DESIGN FOR SHORING IF IT IS DEEMED NECESSARY FOR PROTECTION OF UTILITIES.
 - EXISTING YARD UTILITIES TO BE RETAINED AND PROTECTED UNLESS CALLED OUT AS DEMOLISHED.
 - NO. 4 PIPES ASSUMED TO HAVE 4' OF COVER. CONTRACTOR TO FIELD LOCATE.
 - CONTRACTOR TO SEE REFERENCE DRAWINGS FOR INFORMATION ON EXISTING FACILITIES TO BE DEMOLISHED.

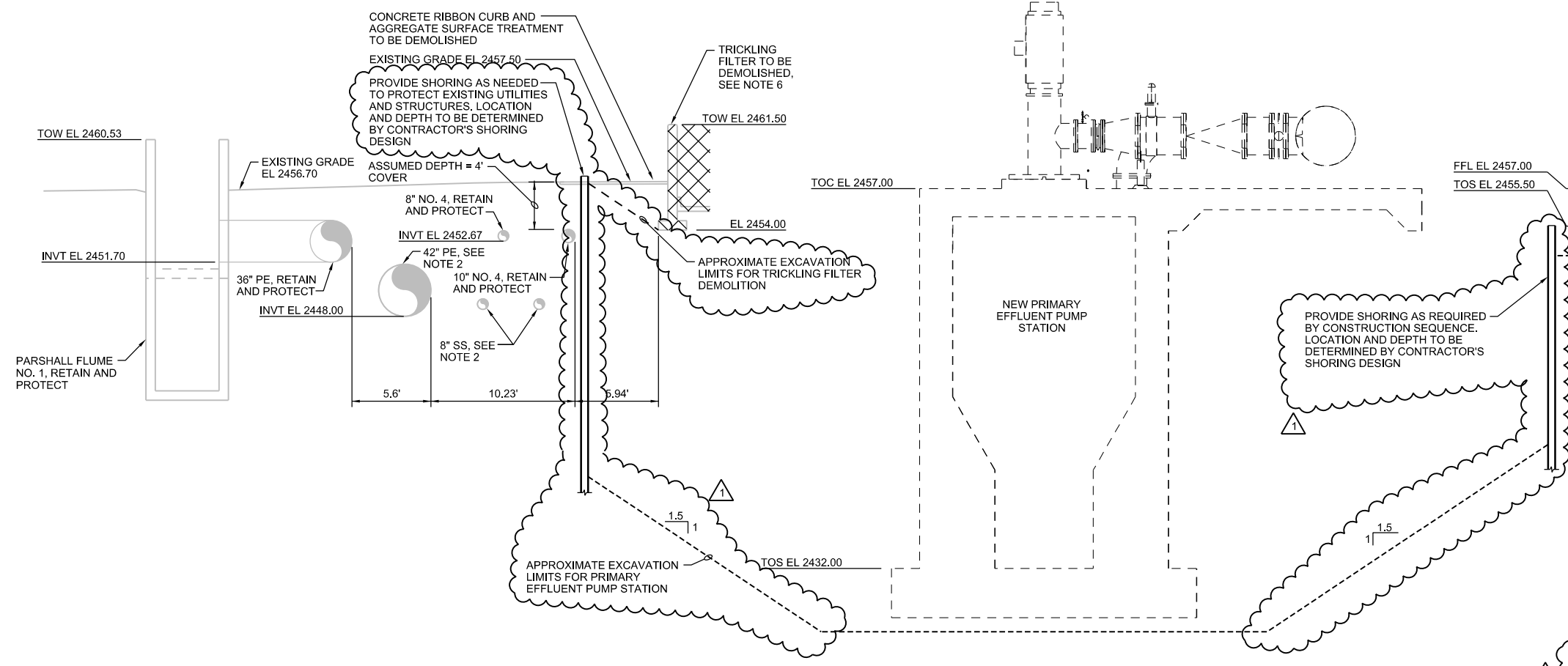

C SECTION
1" = 5'
050-D-109

- NOTES:
- ELEVATIONS AND LOCATIONS OF EXISTING STRUCTURES AND UTILITIES ARE APPROXIMATE. CONTRACTOR TO FIELD VERIFY PRIOR TO CONSTRUCTION.
 - PLAN SHEETS SHOW DEMOLITION OF 42" PE AND BOTH 8" SS PIPES, HOWEVER, ALL PIPING SHOWN IN THIS DETAIL TO BE RETAINED AND PROTECTED DURING DEMOLITION OF TRICKLING FILTER. DEMOLITION TO OCCUR AT A LATER DATE. SEE SPECIFICATION SECTION 01 31 00 CONSTRUCTION SCHEDULE AND CONSTRAINTS, FOR DEMOLITION AND CONSTRUCTION SEQUENCING. CONTRACTOR TO PROVIDE A PLAN FOR THE TEMPORARY REROUTING OF THE 8" AND 10" NO. 4 WATER LINES TO FACILITATE THE DEMOLITION OF THE 2-8" SS PIPES.
 - SHORING IS SHOWN FOR INFORMATION ONLY. CONTRACTOR TO LOCATE EXISTING UTILITIES PRIOR TO CONSTRUCTION AND PROVIDE DESIGN FOR SHORING IF IT IS DEEMED NECESSARY FOR PROTECTION OF UTILITIES AND STRUCTURES AND PER CONSTRUCTION SEQUENCING OF PEPS AND PEPS ELECTRICAL BUILDINGS.
 - EXISTING YARD UTILITIES TO BE RETAINED AND PROTECTED UNLESS CALLED OUT AS DEMOLISHED.
 - NO. 4 PIPES ASSUMED TO HAVE 4' OF COVER. CONTRACTOR TO FIELD LOCATE.
 - CONTRACTOR TO SEE REFERENCE DRAWINGS FOR INFORMATION ON EXISTING FACILITIES TO BE DEMOLISHED.

ORIGINAL DOCUMENT SIGNED BY REGISTRANT ON DECEMBER 16, 2014.



ORIGINAL DOCUMENT STORED AT CH2MHILL/BOISE, ID.

NO.	DATE	REVISION	BY	APVD
1	2015/02/23	ADDENDUM 3	AT	APVD

NAMPA WWTP PHASE 1 UPGRADES
PROJECT GROUP A
CITY OF NAMPA
NAMPA, IDAHO

CH2MHILL
CIVIL
DEMOLITION SECTIONS

DATE	DECEMBER 2014
PROJ	480770
DWG	050-D-301
SHEET	31 of 157

ORIGINAL DOCUMENT SIGNED BY REGISTRANT ON DECEMBER 16, 2014.
 ORIGINAL DOCUMENT STORED AT CH2MHILL/BOISE, ID.
 A THOMPSON A TOLMAN B ROBERTS G THOMPSON
 DSGN DR REVISION CHK APVD
 2015/02/23 ADDENDUM 3 AT APVD
 THIS DOCUMENT, AND THE IDEAS AND DESIGNS INCORPORATED HEREIN, AS AN INSTRUMENT OF PROFESSIONAL SERVICE, IS THE PROPERTY OF CH2M HILL AND IS NOT TO BE USED, IN WHOLE OR IN PART, FOR ANY OTHER PROJECT WITHOUT THE WRITTEN AUTHORIZATION OF CH2M HILL.
 © CH2M HILL 2013. ALL RIGHTS RESERVED.
 BID DOCUMENTS

ORIGINAL DOCUMENT SIGNED BY REGISTRANT ON DECEMBER 16, 2014.

PROFESSIONAL ENGINEER REGISTERED 13300 STATE OF IDAHO AMANDA MARIE SMITH

ORIGINAL DOCUMENT STORED AT CH2MHILL/BOISE, ID.

NO.	DATE	REVISION	BY	APVD
1	2015/02/23	ADDENDUM 3	AT	AT
DR			CHK	APVD
A THOMPSON			B ROBERTS	G THOMPSON

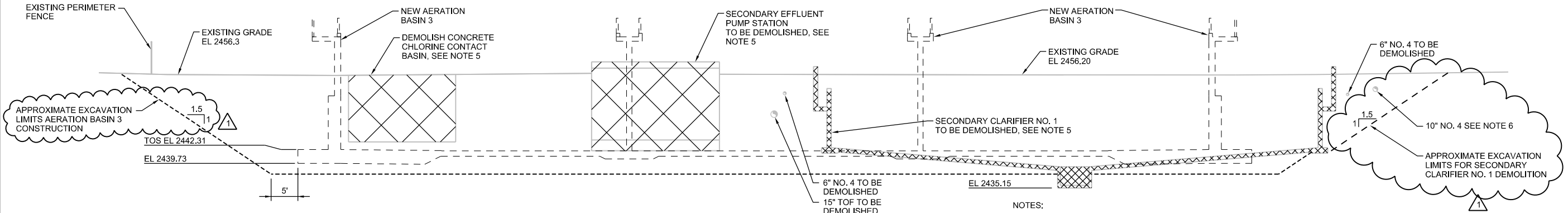

D AB 3 DEMOLITION SECTION
1" = 10'
050-D-109

- NOTES:
- ELEVATIONS AND LOCATIONS OF EXISTING STRUCTURES AND UTILITIES ARE APPROXIMATE. CONTRACTOR TO FIELD VERIFY PRIOR TO CONSTRUCTION.
 - CONTRACTOR TO LOCATE EXISTING UTILITIES PRIOR TO CONSTRUCTION AND PROVIDE DESIGN FOR SHORING IF IT IS DEEMED NECESSARY FOR PROTECTION OF UTILITIES.
 - EXISTING YARD UTILITIES TO BE RETAINED AND PROTECTED UNLESS CALLED OUT AS DEMOLISHED.
 - CONTRACTOR TO COORDINATE DEMOLITION OF SECONDARY EFFLUENT PUMP STATION WITH CONSTRUCTION OF TEMPORARY PUMP STATIONS AND PIPING AS REQUIRED BY SPECIFICATION SECTION 01 57 28 - TEMPORARY FLOW CONTROL PRIOR TO CONSTRUCTION.
 - CONTRACTOR TO SEE REFERENCE DRAWINGS FOR INFORMATION ON EXISTING FACILITIES TO BE DEMOLISHED.
 - CONTRACTOR TO PROVIDE A PLAN FOR THE TEMPORARY REROUTING OF THE 10" NO. 4 WATER LINE TO FACILITATE THE EXCAVATION OF AERATION BASIN 3 AND FUTURE CONSTRUCTION OF PROCESS PIPING IN THIS CORRIDOR.

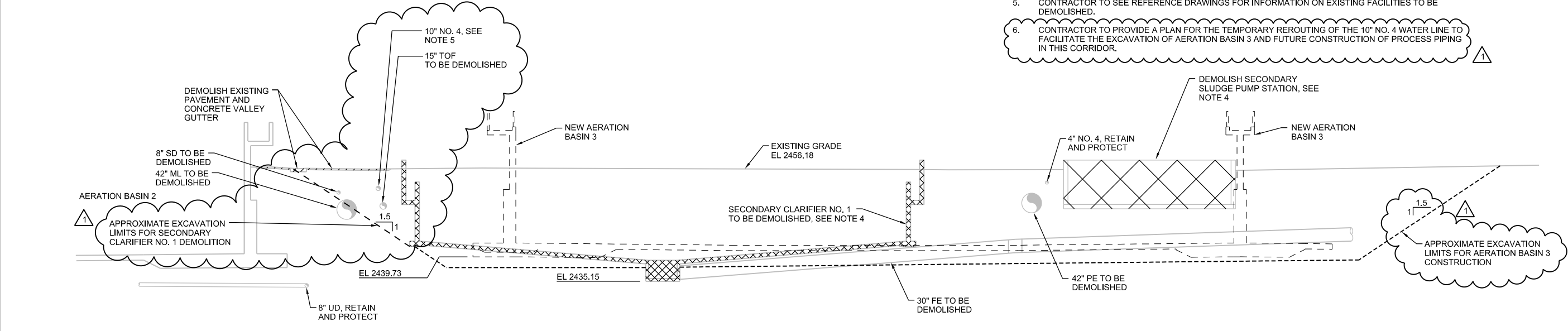

E AB 3 DEMOLITION SECTION
1" = 10'
050-D-109

- NOTES:
- ELEVATIONS AND LOCATIONS OF EXISTING STRUCTURES AND UTILITIES ARE APPROXIMATE. CONTRACTOR TO FIELD VERIFY PRIOR TO CONSTRUCTION.
 - SHORING IS SHOWN FOR INFORMATION ONLY. CONTRACTOR TO LOCATE EXISTING UTILITIES PRIOR TO CONSTRUCTION AND PROVIDE DESIGN FOR SHORING IF IT IS DEEMED NECESSARY FOR PROTECTION OF UTILITIES.
 - EXISTING YARD UTILITIES TO BE RETAINED AND PROTECTED UNLESS CALLED OUT AS DEMOLISHED.
 - CONTRACTOR TO SEE REFERENCE DRAWINGS FOR INFORMATION ON EXISTING FACILITIES TO BE DEMOLISHED.
 - CONTRACTOR TO PROVIDE A PLAN FOR THE TEMPORARY REROUTING OF THE 10" NO. 4 WATER LINE TO FACILITATE THE EXCAVATION OF AERATION BASIN 3 AND FUTURE CONSTRUCTION OF PROCESS PIPING IN THIS CORRIDOR.

NAMPA WWTP PHASE 1 UPGRADES
PROJECT GROUP A
CITY OF NAMPA
NAMPA, IDAHO

CH2MHILL
CIVIL
DEMOLITION SECTIONS

AS NOTED
VERIFY SCALE
BAR IS ONE INCH ON ORIGINAL DRAWING.

DATE	DECEMBER 2014
PROJ	480770
DWG	050-D-302
SHEET	32 of 157

City of Nampa Wastewater Treatment Plant Phase 1 Upgrades

Group A - Liquid Stream Upgrades

Site Visit Sign in Sheet

2/24/2015

Name	Company	Phone Number	Email Address	Plan Holder Y/N	General Contractor or Subcontractor
Travis Conger	Performance Systems	405-8344	tconger@psigc.com	Y	General
David Arriola	IDEAL DEMO	369-0311			SUB
NORMAN NIEBUHR	IDEAL DEMOLITION	365-1514	norman@ideal-demolition-services.com	N	SUB
BRUCE DESPAIN	COP CONSTRUCTION	801-298-9560	4tbid@copconstruction.com	Y	GENERAL
Elliot Shippy	AME Electric	208-965-5144	Elliot@ameelectric.com Jamre@ameelectric.com	Y	SUB
Benji Young	Ewing	(208) 377-1500	bids@ewingcompany.com	Y	General
JEFF BLACK	ALDER CONST	801 266-8856	jblack@alderconstruction.com	Y	GC
M. WOODWORTH	STRATA	552-3884	mwoodworth@stratageotech.com		-
Jim Cox	JC CONST	850-1325	jim@jcboise.com	Y	GC
MATT NEUKOM	JC CONSTRUCTORS	965-3244	matt@jccboise.com	Y	GC
John Laible	Rain Forest	919-38918	jlaible@rainforest.com	N	SUB
SABINO PAPAIDOMO	RSCI	208-447-0730	SABINO @ RSCI GROUP.COM	Y	GC

Nampa Waste Water Treatment Plant Phase 1 Upgrades

Group A – Liquid Stream Upgrades

2/25/2015 Contractor Plant Site Visit Questions

1. Is the waste water treatment plant staff going to clean the aeration basins prior to contractor modifications?

The Plant Operation staff intend to drain facilities that are identified in Deactivation Requests. The Operators will drain facilities within 6 inches of the highest point of the floor. The Contractor shall be responsible for the remaining dewatering, removal of residual sludge, and any cleaning required.

2. Which Davis Bacon Classification is expected to be followed for bidding purposes (Heavy Civil, Building etc.)? There are conflicting rates between classifications.

The General Decision provided in the Contract Documents is Heavy Construction and is considered the appropriate Construction Type for this scope of work.

3. What are the sources and capacity of power for the temporary pumping facilities that are part of the project?

The capacity and requirements for temporary power are identified in several locations including the yard electrical plans. Drawing 050-E-108 Keynote 8 and Drawing 050-E-109 Keynote 7 answer the specific question.

4. Can you clarify the sources of the temporary flows called out in the Process Flow Diagrams?

See future addendum.

5. Is the 600 day Milestone a firm/fixed deadline or is there some flexibility?

Section 00 52 00 Agreement includes Contract Times for Milestone 1. For Milestone 1 only, there are no liquidated damages and the progress towards Milestone would be evaluated compared to the Contractor's Baseline CPM Schedule.

6. Would it be possible to have a third site visit prior to the bid opening?

See Addendum 3.

Nampa Wastewater Treatment Plant Phase I Upgrades: Group A-Liquid Stream Upgrades

Response to Written Bidder Questions

<u>Internal Tracking</u>	<u>Spec/Drawing</u>	<u>Bidder Question/Comment</u>	<u>Response</u>
36		Contractor is requesting waiver from requirements for bona fide Idaho Residents as employees for the project.	The City of Nampa has been asked if compliance with Idaho Code §§ 44-1001 and 1002 (requiring the successful bidder to employ 95% bona fide Idaho residents for work on the project) can be waived. The requirements of statutes governing public works construction in Idaho cannot be waived by the City. The City has also reviewed the exceptions listed in the statutes themselves and concluded that they do not apply. For these reasons the requirements of Idaho Code §§ 44-1001 and 1002 will not be waived. If any interested party believes there is a legal basis for waiver, they are encouraged to provide a legal analysis for the City's further consideration.
13		It is unclear if seal water drains shall be the same material as other drain piping. Please clarify.	Seal water drains should be considered flow stream SI.
14	40 27 01	It is unclear if buried flexible couplings shall have special coatings. (either factory or field applied)	Section 40 27 01 paragraph 2.03.A specifies coating and lining of flexible couplings, and these will also be bagged along with the DI piping.
15	40 27 01	It is unclear if double proprietary restrained mechanical joints on DIP Systems will be acceptable as flexible couplings. (Installed at the recommended intervals).	Double proprietary restrained joints are acceptable as flexible couplings.
16	40 27 01	There does not seem to be a detail showing proper installation of restrained flexible couplings, please provide a detail.	See Addendum 2.
17	40 27 01	Please clarify the intent of having double flexible couplings on all systems entering and leaving concrete structures. Mechanical and Yard Pipe drawings do not seem to show the installation of the couplings, some piping arrangements will not allow for double couplings as currently drawn. Should couplings be omitted on those installations? Please provide drawings that show coupling placement if required.	The intent of the double flexible connection is to allow for differential settlement at the structure. One of the joints can be right at the wall as shown in standard detail 4027-602. The joints can be mechanical joints as shown in that detail, rather than actual flexible couplings.

