

# TOWN OF LONGMEADOW, MASSACHUSETTS

## Plan of

# FISCAL YEAR 2020 RESURFACING PROJECT

**SELECT BOARD**  
**MARK P. GOLD, CHAIRMAN**  
**MARIE ANGELIDES, VICE-CHAIRMAN**  
**THOMAS LACHIUSA**  
**RICHARD FOSTER**  
**WILLIAM LOW**

**TOWN MANAGER**  
**STEPHEN J. CRANE**

**DEPARTMENT OF PUBLIC WORKS**  
**MARIO MAZZA, DIRECTOR**  
**ANDREW KRAR, P.E., TOWN ENGINEER**

**Longmeadow**  
**Engineering**  
**Department**

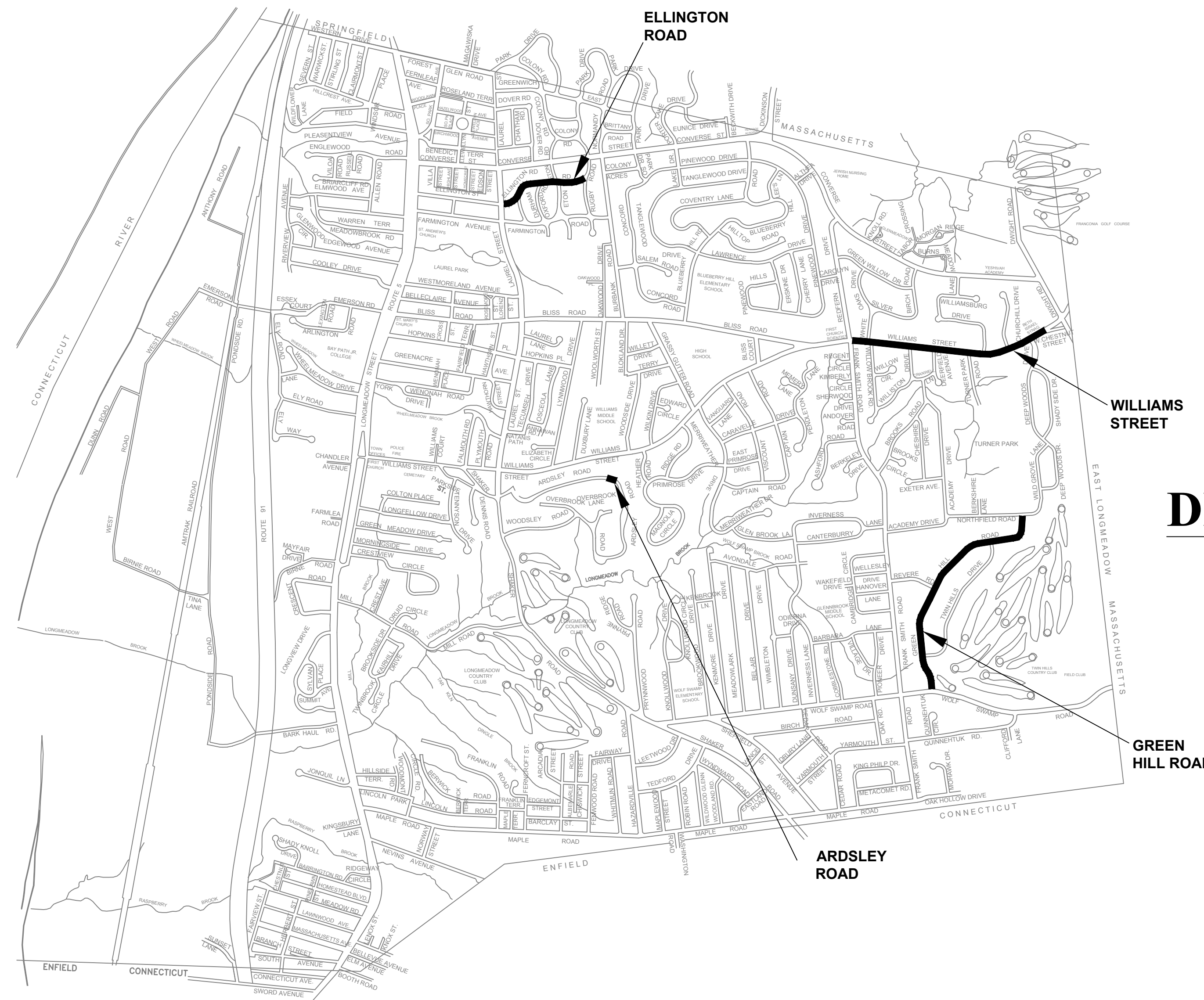

**LOCUS MAP**  
 Not To Scale

**INDEX**

SHEET NUMBER	DESCRIPTION
1	COVER SHEET
2	ARDSLEY ROAD
3	ELLINGTON ROAD
4-5	GREEN HILL ROAD
6-7	WILLIAMS STREET
8-9	DETAILS

**COMPLETE SET 9 SHEETS**

LIMIT OF WORK

189 ARDSLEY RD.

LOWER FRAME 3-1/4"

R/R BERM

R/R STONE INCIDENTAL

SEE DETAIL SHEET 9 FOR VARIABLE MILL

2405

1046

LIMIT OF WORK

LIMIT OF WORK

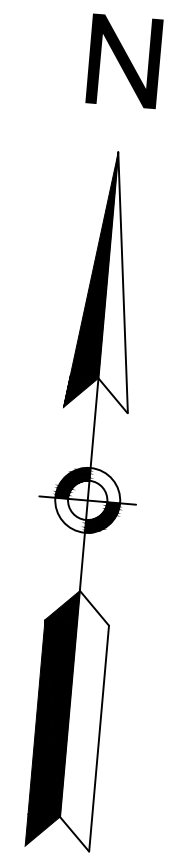

TOWN of LONGMEADOW ENGINEERING DEPARTMENT  
F.Y. 2020 STREET RESURFACING PROJECT

Ardsley Road  
Variable Mill & 1-1/2" Base  
1-1/2" Top

SCALE: N.T.S.

DATE: 2019

2020 Resurfacing Plans Bid Doc.dwg

Drawn by: CM Approved by: AK

SHEET 2 of 9

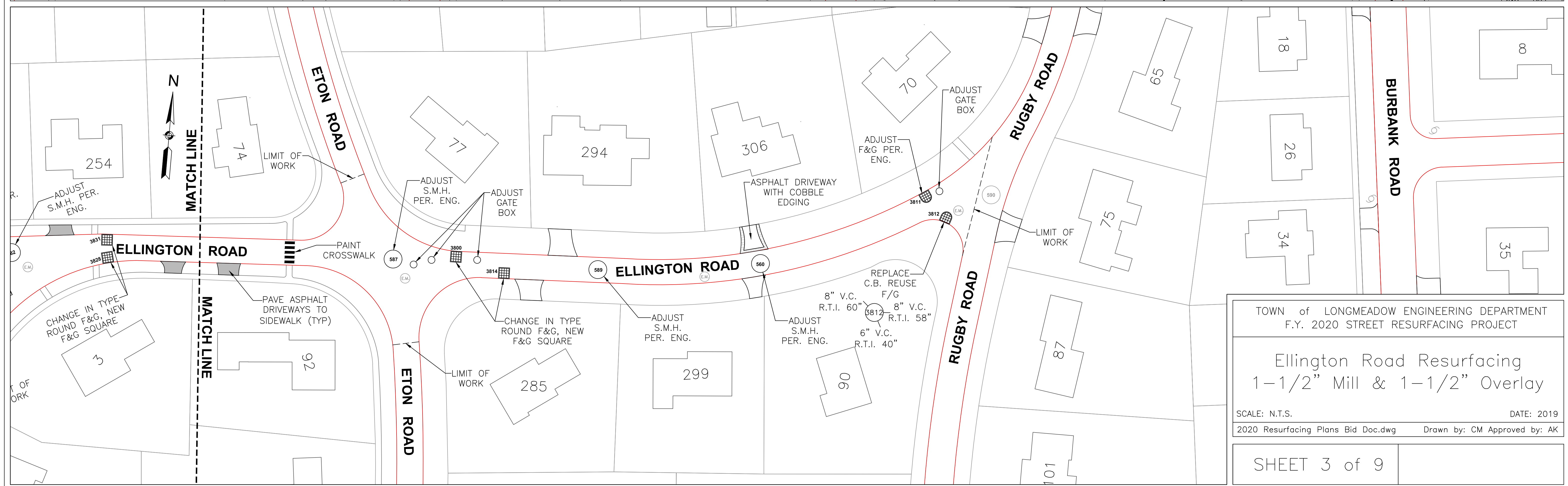
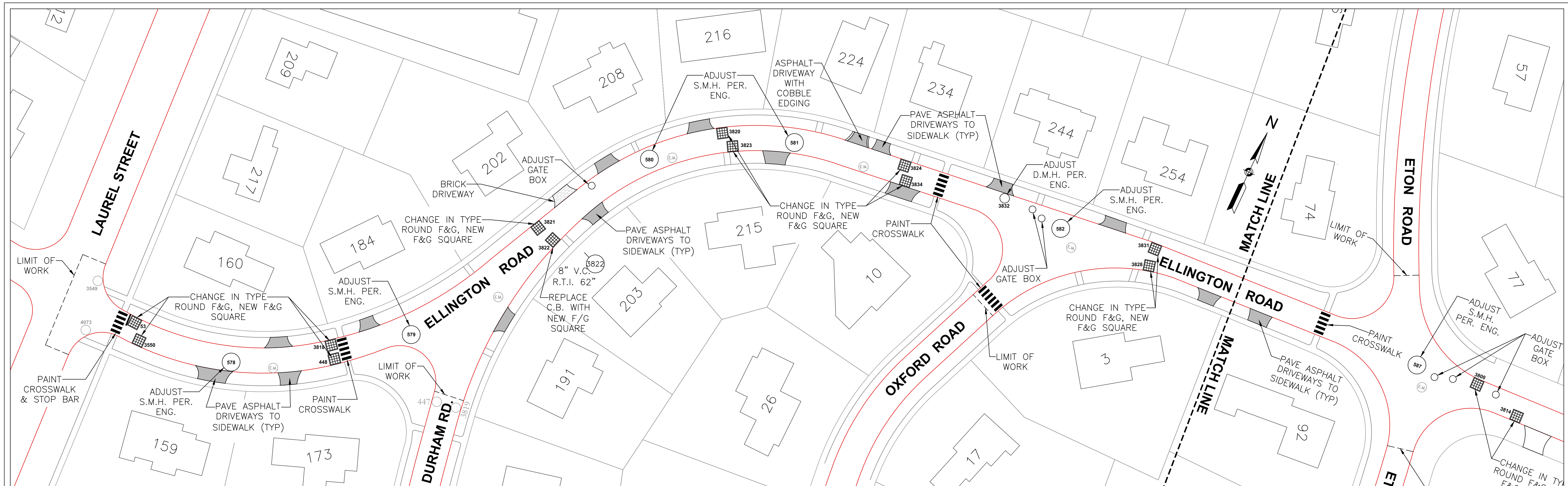

TOWN of LONGMEADOW ENGINEERING DEPARTMENT	
F.Y. 2020 STREET RESURFACING PROJECT	
<h3>Ellington Road Resurfacing</h3> <h3>1-1/2" Mill &amp; 1-1/2" Overlay</h3>	
SCALE: N.T.S.	DATE: 2019
2020 Resurfacing Plans Bid Doc.dwg	Drawn by: CM Approved by: AK
SHEET 3 of 9	

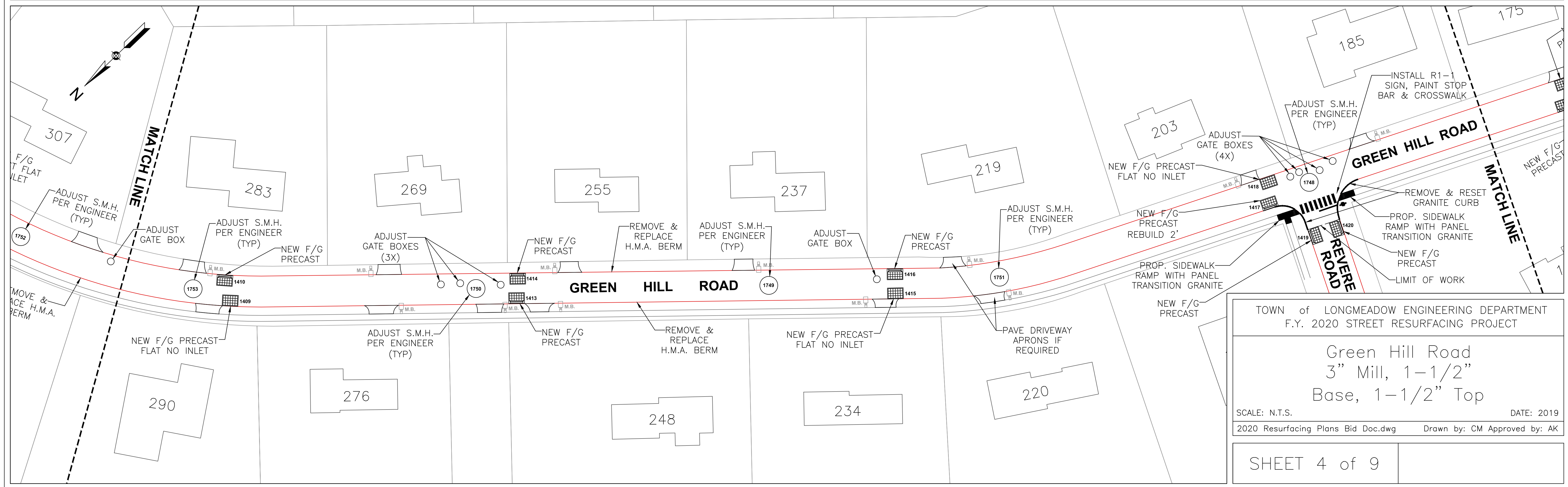
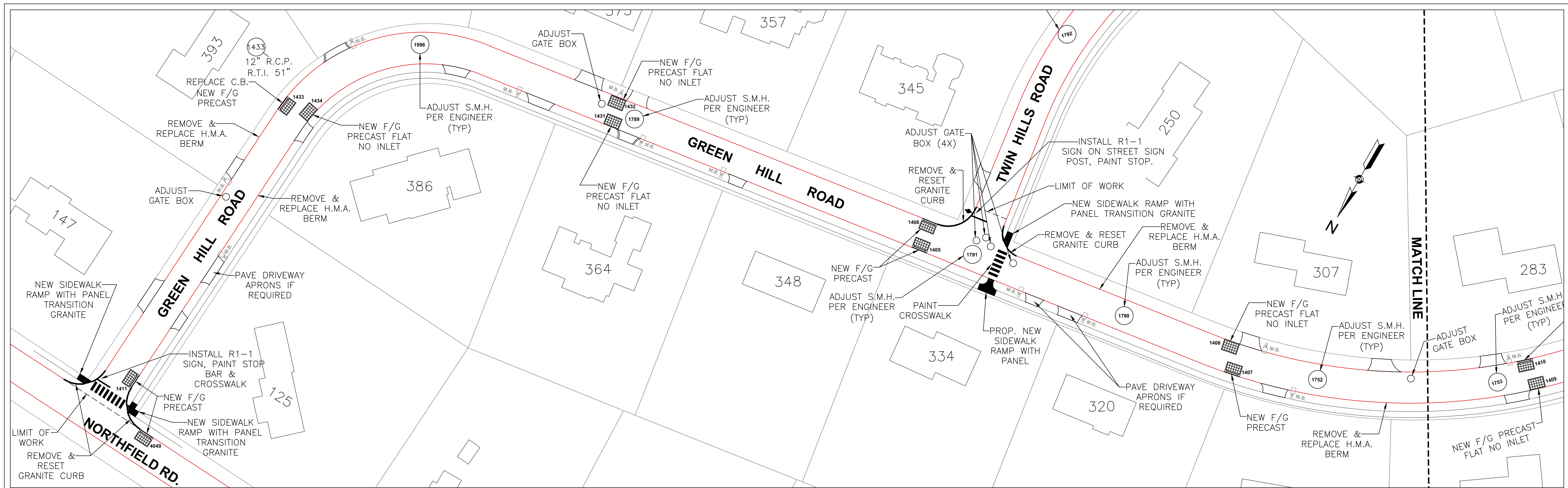

TOWN of LONGMEADOW ENGINEERING DEPARTMENT  
 F.Y. 2020 STREET RESURFACING PROJECT

**Green Hill Road**  
 3" Mill, 1-1/2"  
 Base, 1-1/2" Top

SCALE: N.T.S. DATE: 2019  
 2020 Resurfacing Plans Bid Doc.dwg Drawn by: CM Approved by: AK

SHEET 4 of 9

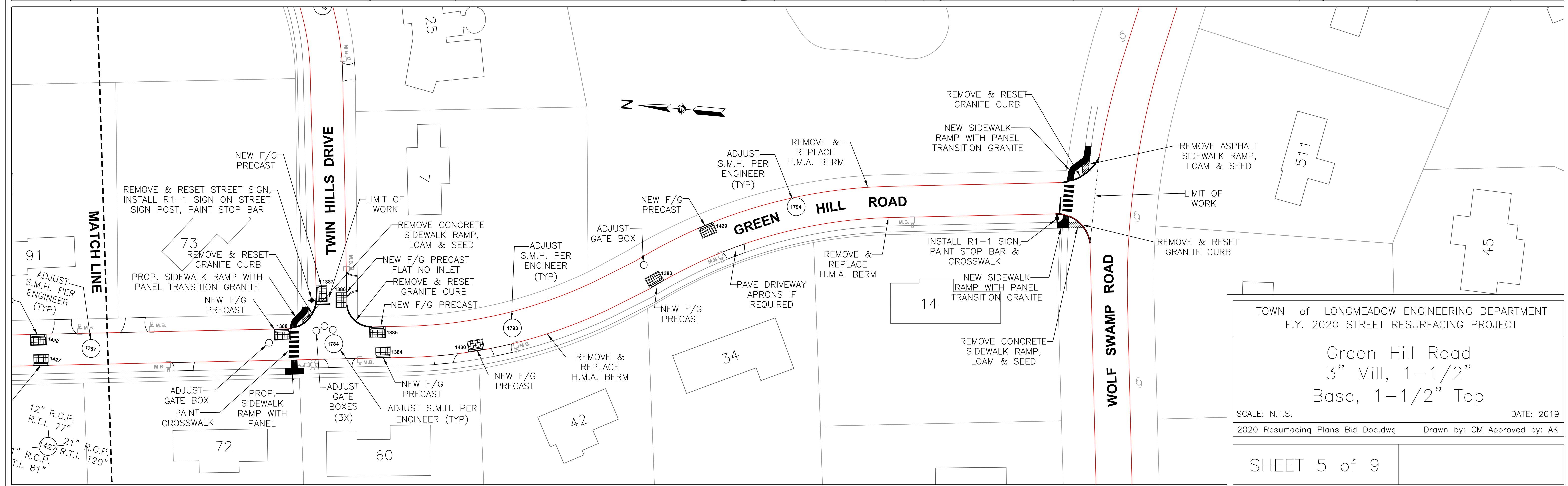
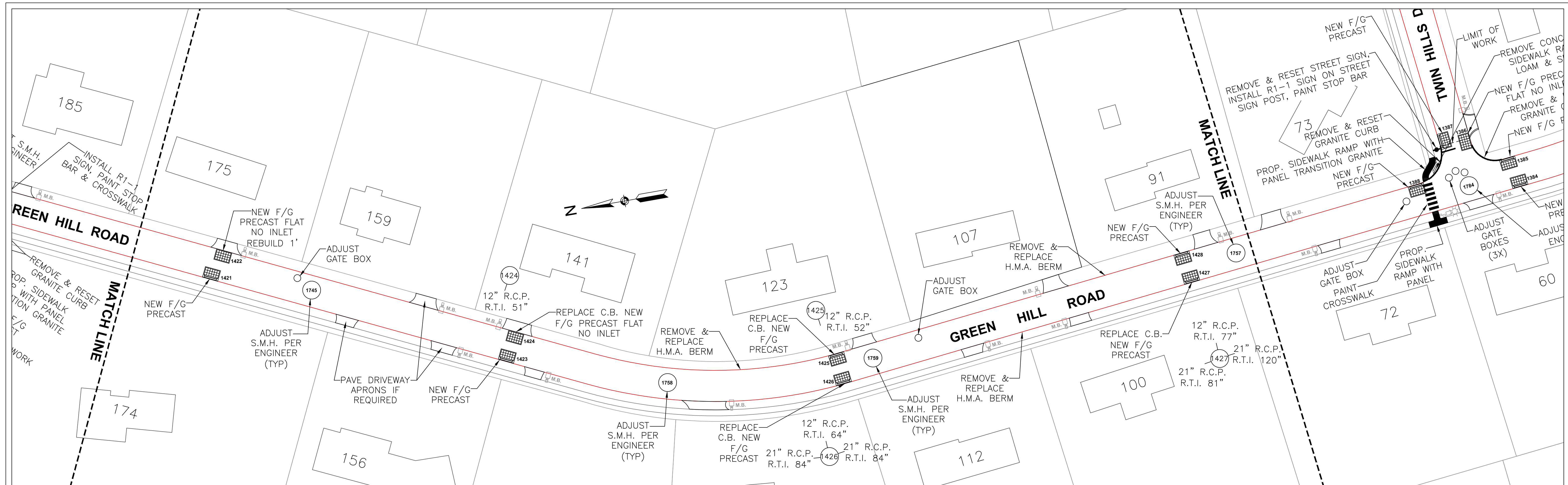

TOWN of LONGMEADOW ENGINEERING DEPARTMENT  
 F.Y. 2020 STREET RESURFACING PROJECT

Green Hill Road  
 3" Mill, 1-1/2"  
 Base, 1-1/2" Top

SCALE: N.T.S. DATE: 2019  
 2020 Resurfacing Plans Bid Doc.dwg Drawn by: CM Approved by: AK

SHEET 5 of 9

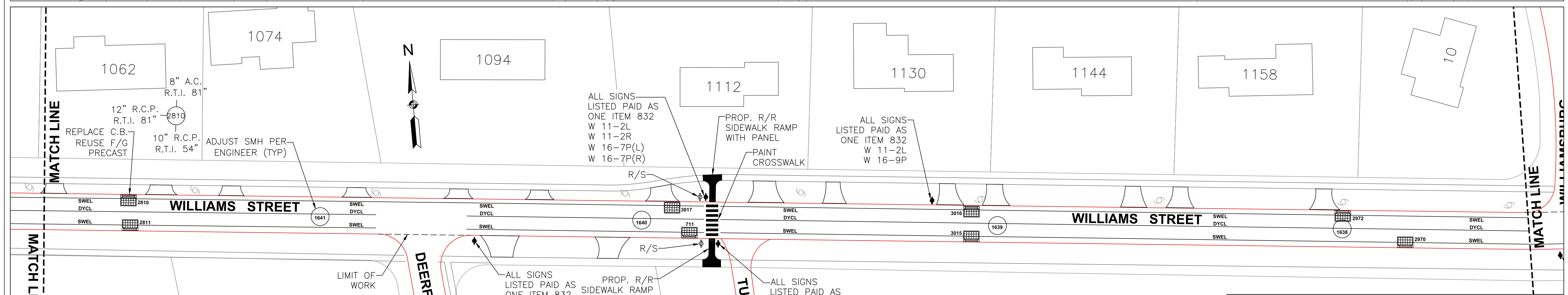
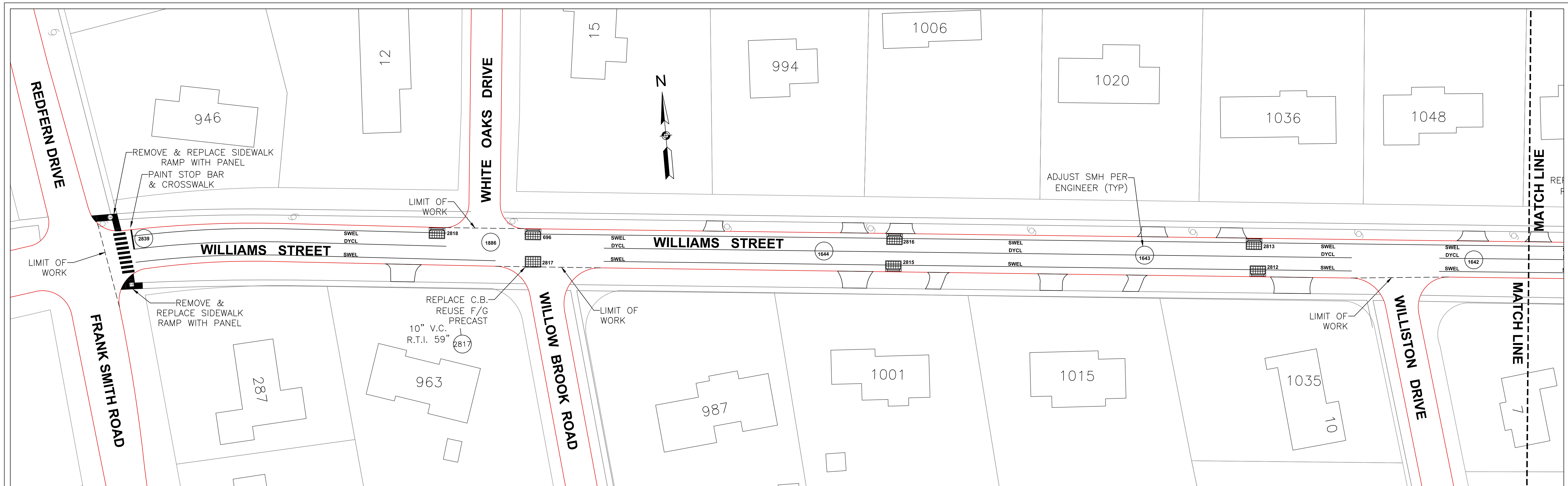

TOWN of LONGMEADOW ENGINEERING DEPARTMENT F.Y. 2020 STREET RESURFACING PROJECT	
Williams Street 2" Mill, 2" Top	
SCALE: N.T.S.	DATE: 2019
2020 Resurfacing Plans Bid Doc.dwg	Drawn by: CM Approved by: AK
SHEET 6 of 9	

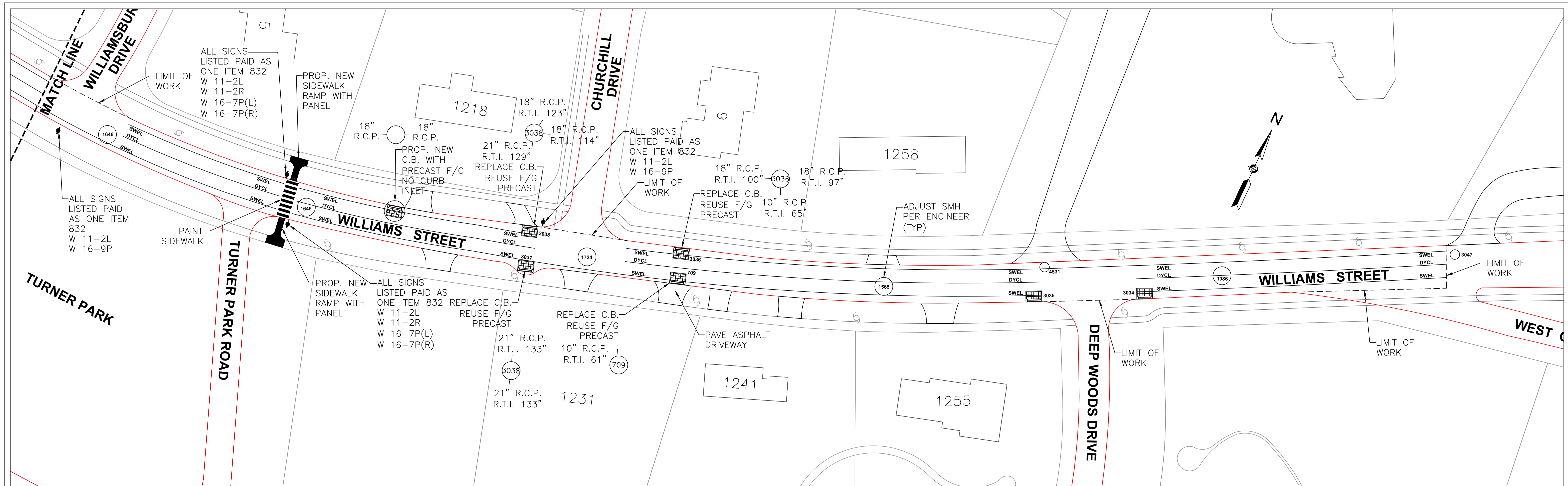

TOWN of LONGMEADOW ENGINEERING DEPARTMENT F.Y. 2020 STREET RESURFACING PROJECT	
Williams Street 2" Mill, 2" Top	
SCALE: N.T.S.	DATE: 2019
2020 Resurfacing Plans Bid Doc.dwg	Drawn by: CM Approved by: AK
SHEET 7 of 9	

**DESIGN NOTES**

1. CONCRETE -5000 PSI, 28 DAYS
2. REINFORCEMENT - ASTM A-615, GRADE 60
3. GALVANIZED FRAME & GRATE

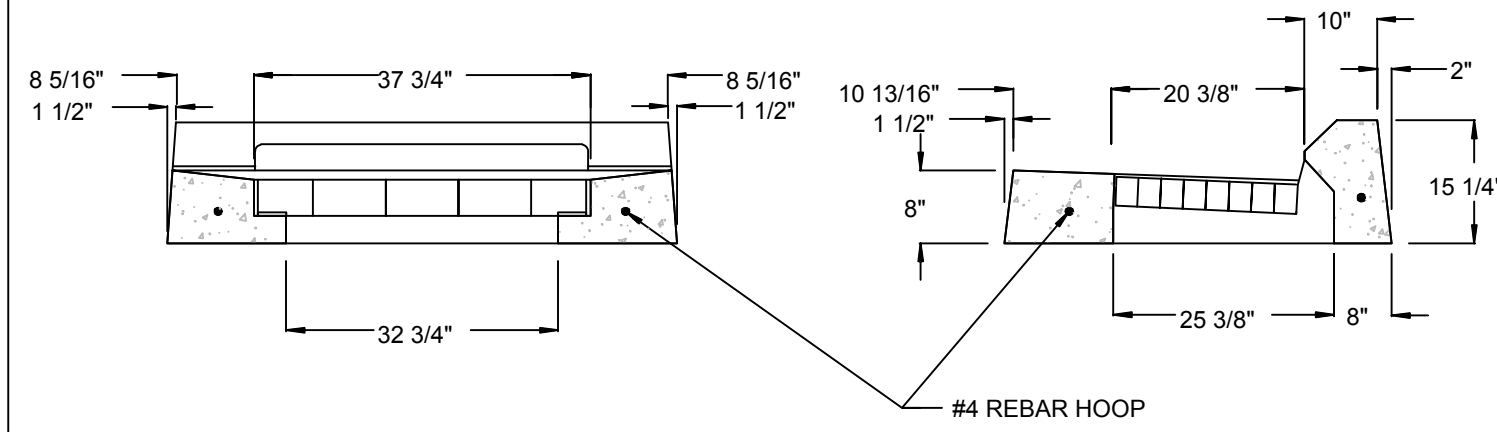
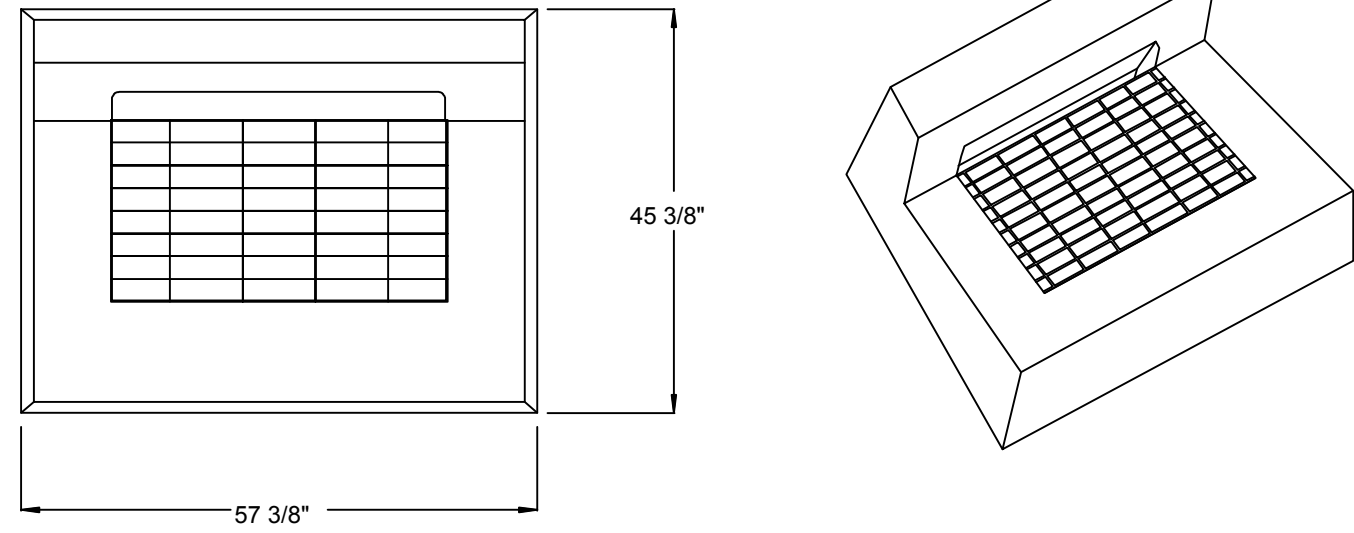

**TYPE "C" TOP SPECIAL (ITEM 222.1)**

N.T.S.

NOTE: ADJUSTMENT OF STRUCTURES TO LINE OR GRADE OR BOTH LINE AND GRADE WHEN THE CHANGE IS 6 INCHES OR LESS, WILL BE MEASURED IN PLACE BY THE UNIT EACH, COMPLETE AND APPROVED. NO ADDITIONAL COMPENSATION FOR ADJUSTMENT.

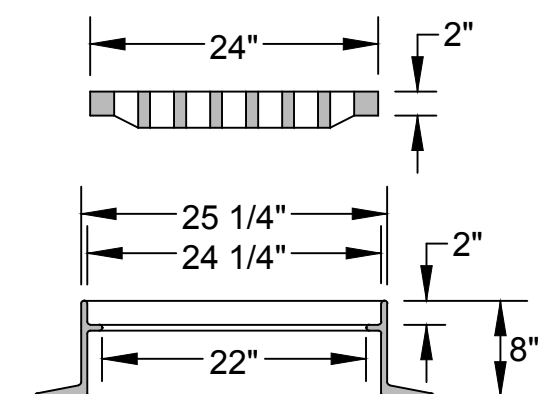
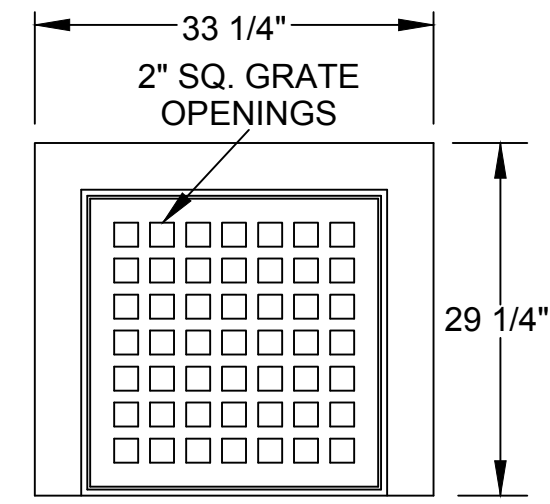

**HEAVY DUTY CATCH BASIN FRAME & COVER  
DETAIL, 24"X24", 8"  
FRAME, 3 FLANGE or 4  
FLANGE (ITEM 222)**

N.T.S.

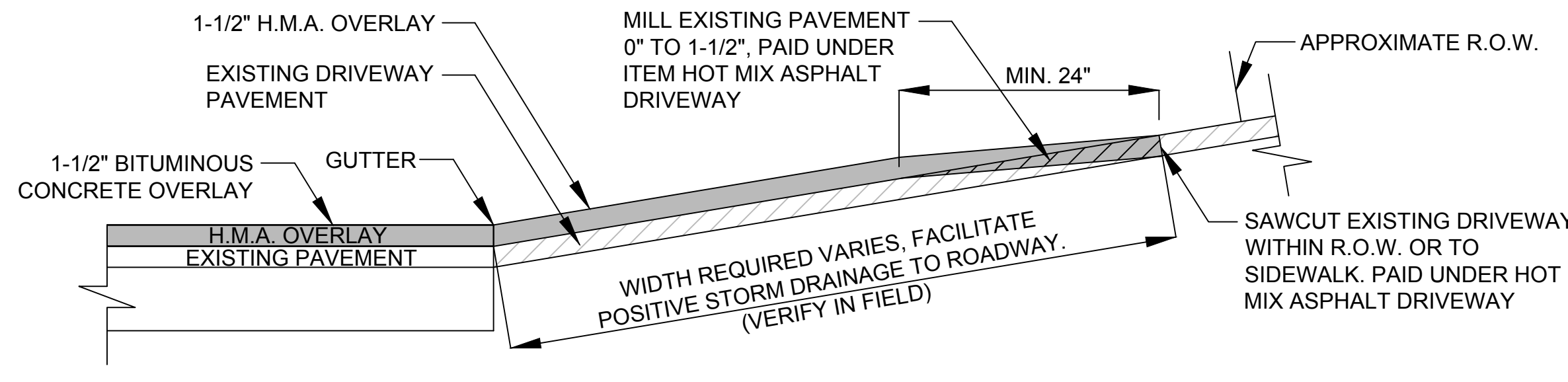

**BITUMINOUS CONCRETE DRIVEWAY**

N.T.S.

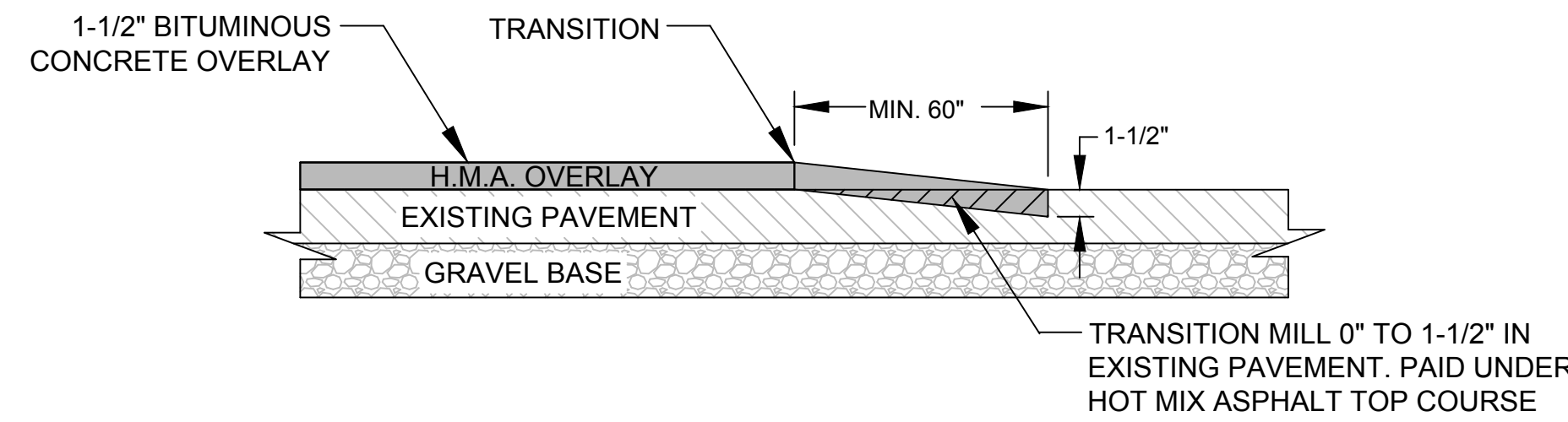

**TRANSITION AT END OF HOT MIX ASPHALT TOP COURSE**

N.T.S.

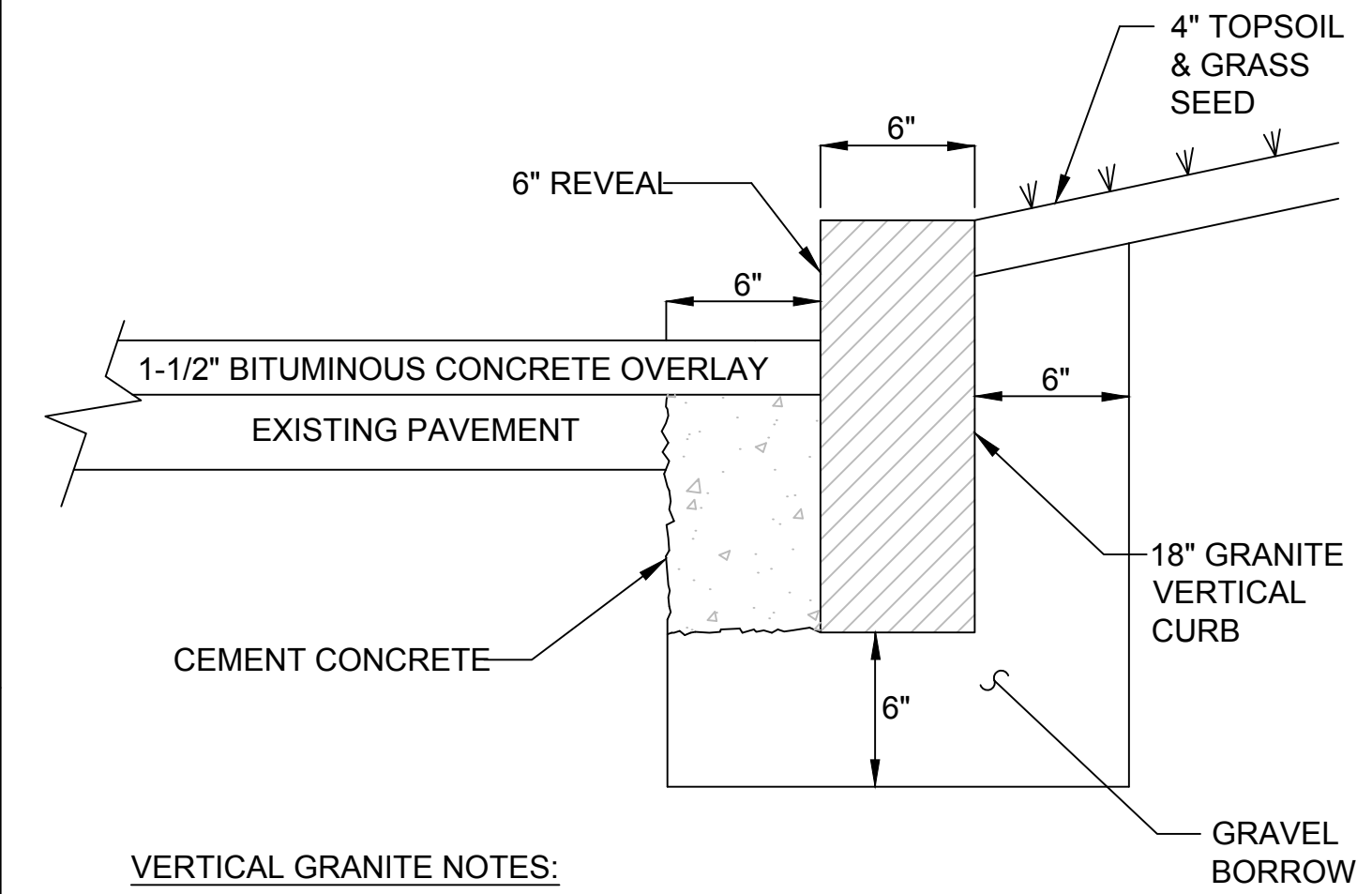

**VERTICAL GRANITE NOTES:**

1. CUT NEAT LINE 6" FROM CURB LINE AND REMOVE BINDER, BASE AND STONE REPLACE WITH CEMENT CONCRETE
2. PAYMENT FOR CEMENT CONCRETE WILL BE INCLUDED IN THE PRICE PER LINEAR FOOT OF CURBING.

**VERTICAL GRANITE EDGING**

N.T.S.

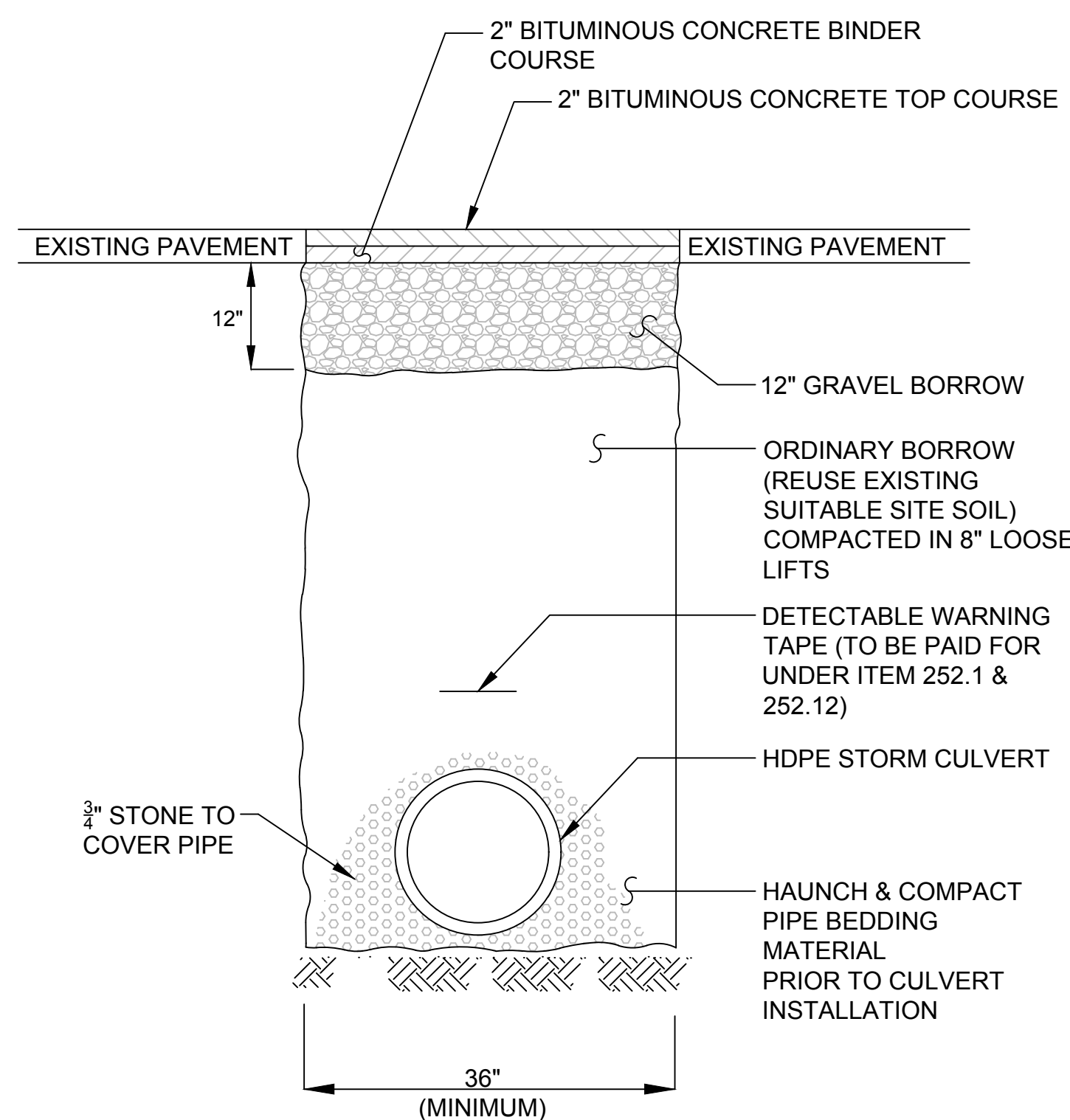

**STORM DRAIN TRENCH**

N.T.S.

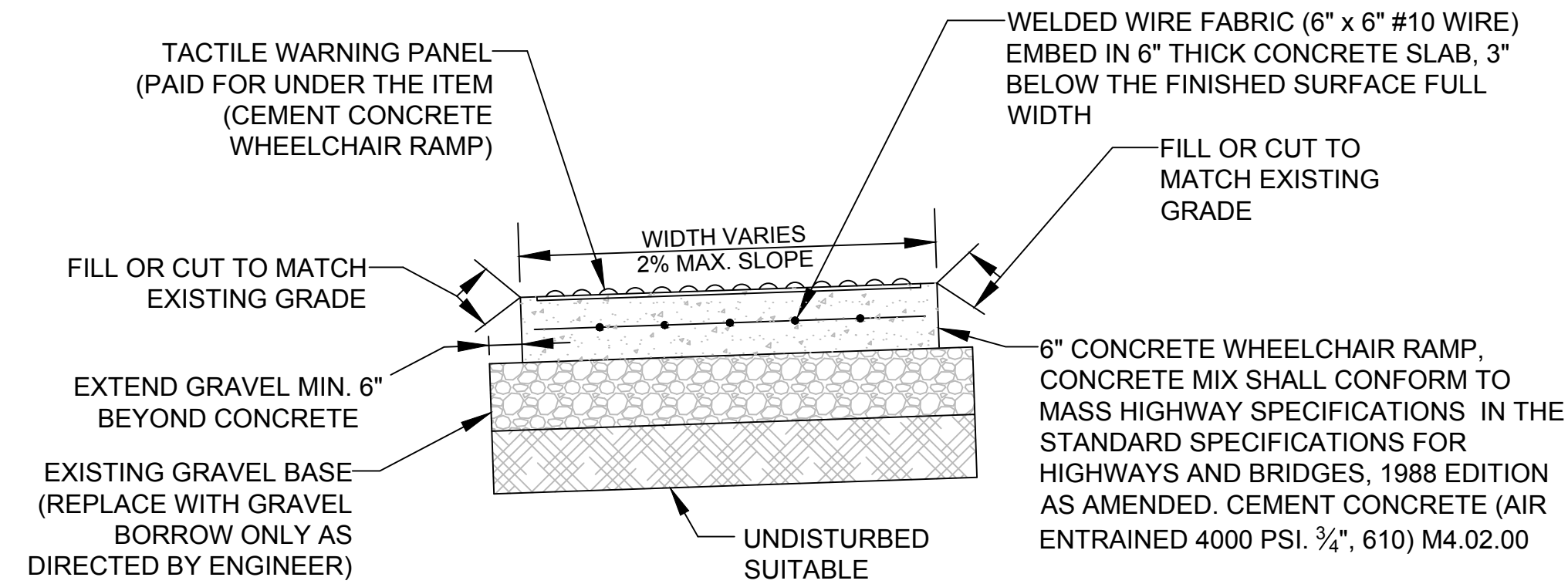

**SECTION**

N.T.S.

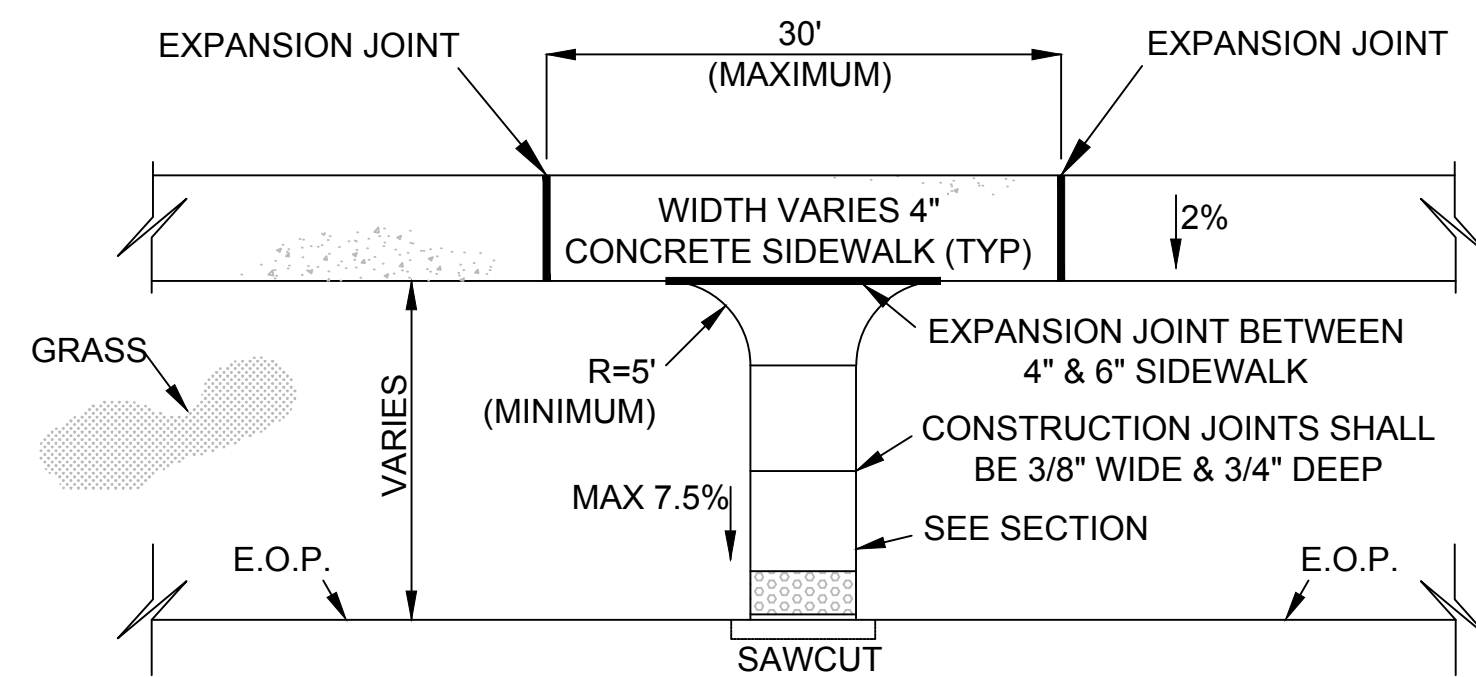

**NOTE:**

SIDEWALK RAMPS TO HAVE 5'X5' MINIMUM LEVEL LANDING WITH 1.5% MAXIMUM CROSS SLOPE (ALL DIRECTIONS) WITH 2' X 4' YELLOW R304 TACTILE WARNING PANEL (TYPICAL)

**CONCRETE SIDEWALK  
WHEELCHAIR RAMP**

N.T.S.

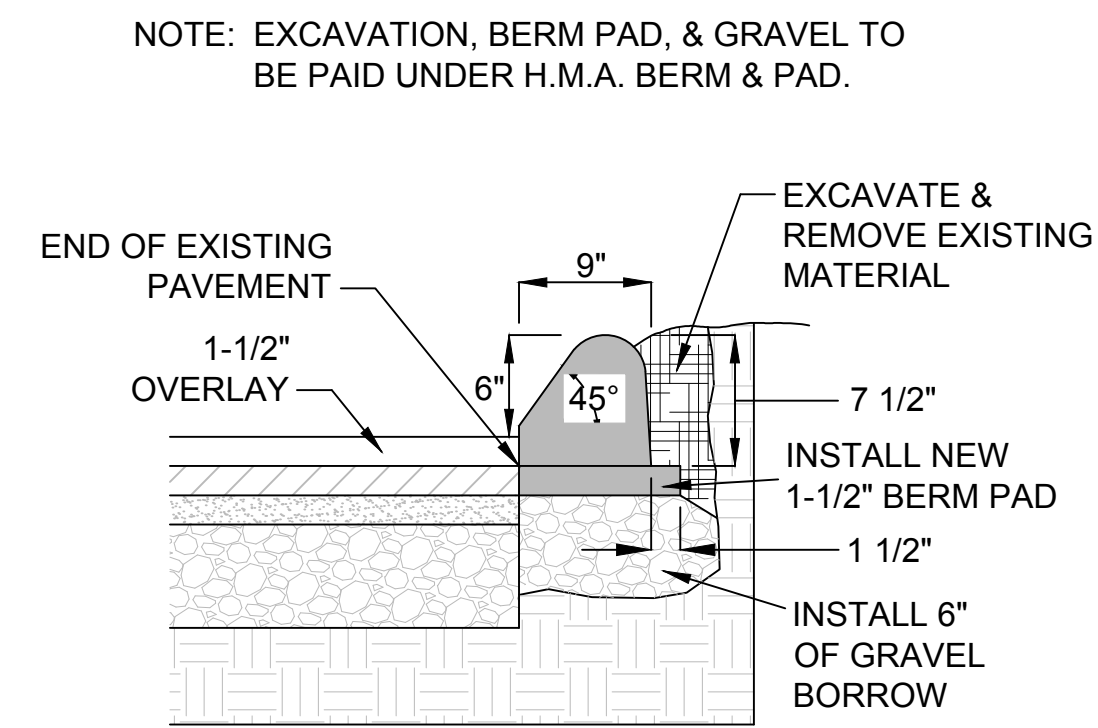

**H.M.A. BERM & PAD,  
TYPE 2**

N.T.S.

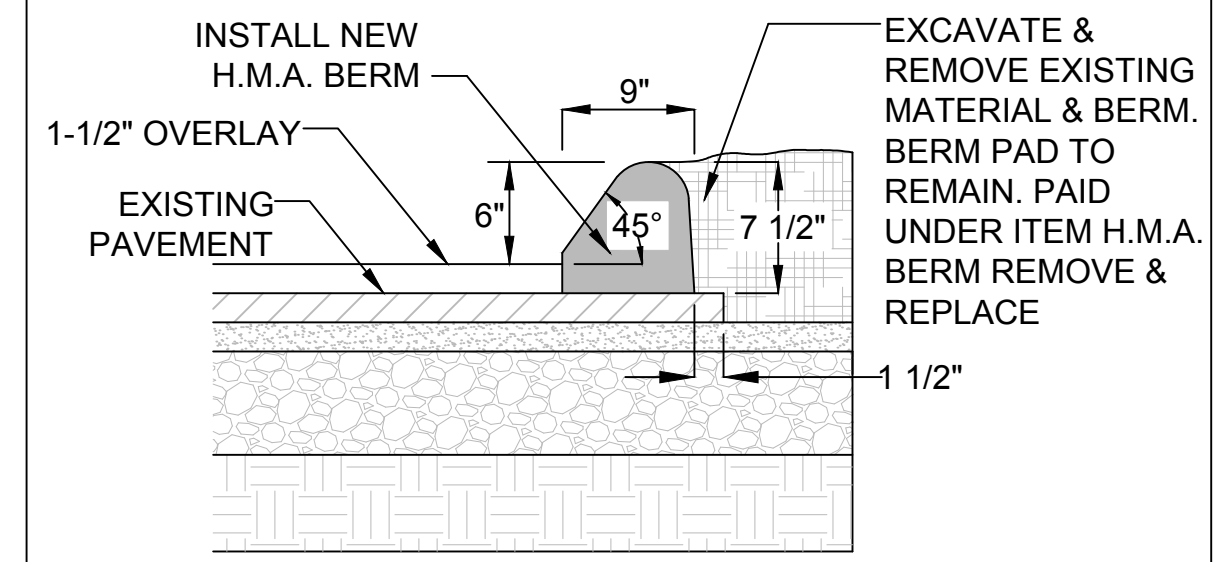

**H.M.A. BERM REMOVE &  
REPLACE, TYPE 2**

N.T.S.

NOTE: CONCRETE COLLAR TO BE PAD UNDER DRAIN STRUCTURE ADJUST, SANITARY STRUCTURE ADJUST, FRAME AND COVER NEW, FRAME AND GRATE NEW, FRAME AND GRATE PRECAST NEW,

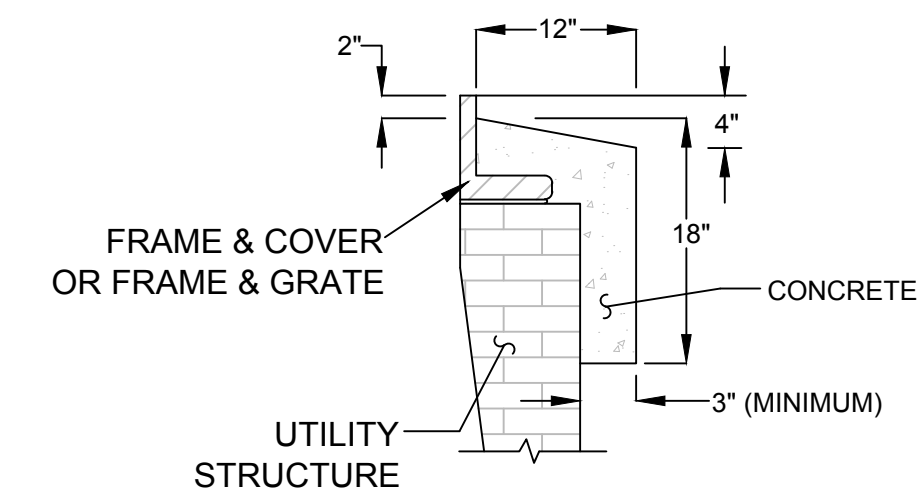

**CONCRETE COLLAR**

N.T.S.

TOWN of LONGMEADOW ENGINEERING DEPARTMENT  
F.Y. 2020 STREET RESURFACING PROJECT

**Longmeadow Paving Details**

SCALE: N.T.S.

DATE: 2019

2020 Resurfacing Plans Bid Doc.dwg Drawn by: CM Approved by: AK



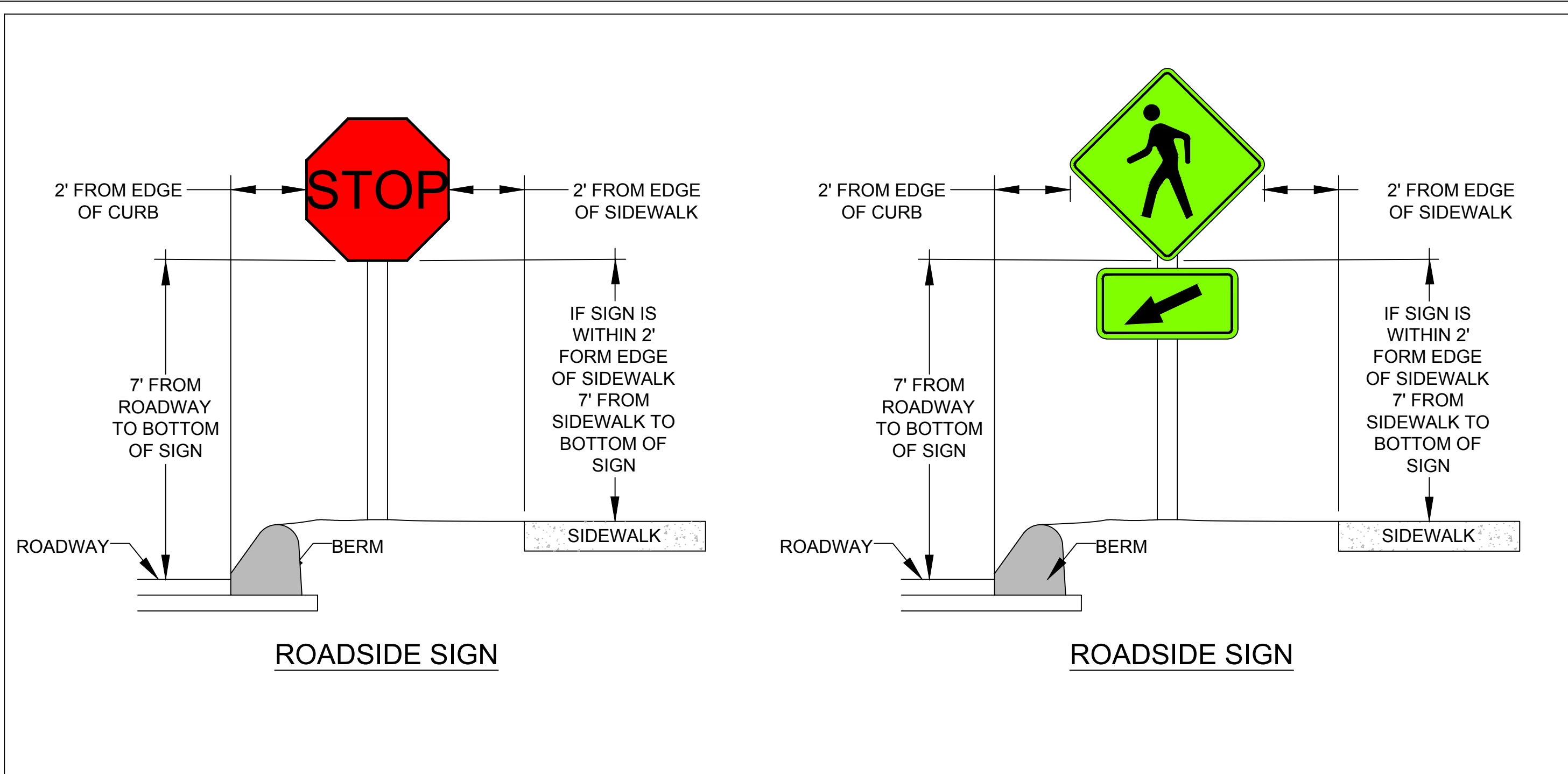

**189 Ardsley Road**

East of Catch Basin							
Location	B.S	F.S.	H.I.	Elev	Elev Prop.	Difference	Inches Cut
Hyd Spindle	2.01		102.01	100.00			
Catch Basin		5.75		96.26	96.00	0.26	3.12
East 5'		5.51		96.50	96.05	0.45	5.4
10		5.47		96.54	96.10	0.44	5.28
15		5.46		96.55	96.15	0.40	4.8
20		5.46		96.55	96.20	0.35	4.2
25		5.50		96.51	96.25	0.26	3.12
30		5.52		96.49	96.30	0.19	2.28
35		5.53		96.48	96.35	0.13	1.56
40		5.52		96.49	96.40	0.09	1.08
45		5.47		96.54	96.45	0.09	1.08
50		5.43		96.58	96.50	0.08	0.96
55		5.42		96.59	96.55	0.04	0.48
60		5.41		96.60			
West of Catch Basin							
Location	B.S	F.S.	H.I.	Elev	Elev Prop.	Difference	Inches Cut
Hyd Spindle	2.01		102.01	100.00			
Catch Basin		5.75		96.26	96.08	0.18	2.16
West 5'		5.58		96.43	96.13	0.30	3.6
10		5.50		96.51	96.18	0.33	3.96
15		5.51		96.50	96.23	0.27	3.24
20		5.51		96.50	96.28	0.22	2.64
25		5.51		96.50	96.33	0.17	2.04
30		5.57		96.44	96.38	0.06	0.72
35		5.54		96.47	96.43	0.10	1.2
40		5.48		96.53	96.48	0.05	0.6
45		5.48		96.53			

Variable Mill 189 Ardsley Road

IDENTIFICATION NUMBER	SIZE OF SIGN		TEXT
	WIDTH (IN)	HEIGHT (IN)	
R1-1	30	30	STOP
WW11-2L	30	30	PEDESTRIAN
WW11-2R	30	30	PEDESTRIAN
W16-7p(L)	24	12	LEFT TURN
W16-7p(R)	24	12	RIGHT TURN
W16-9p	24	12	AHEAD

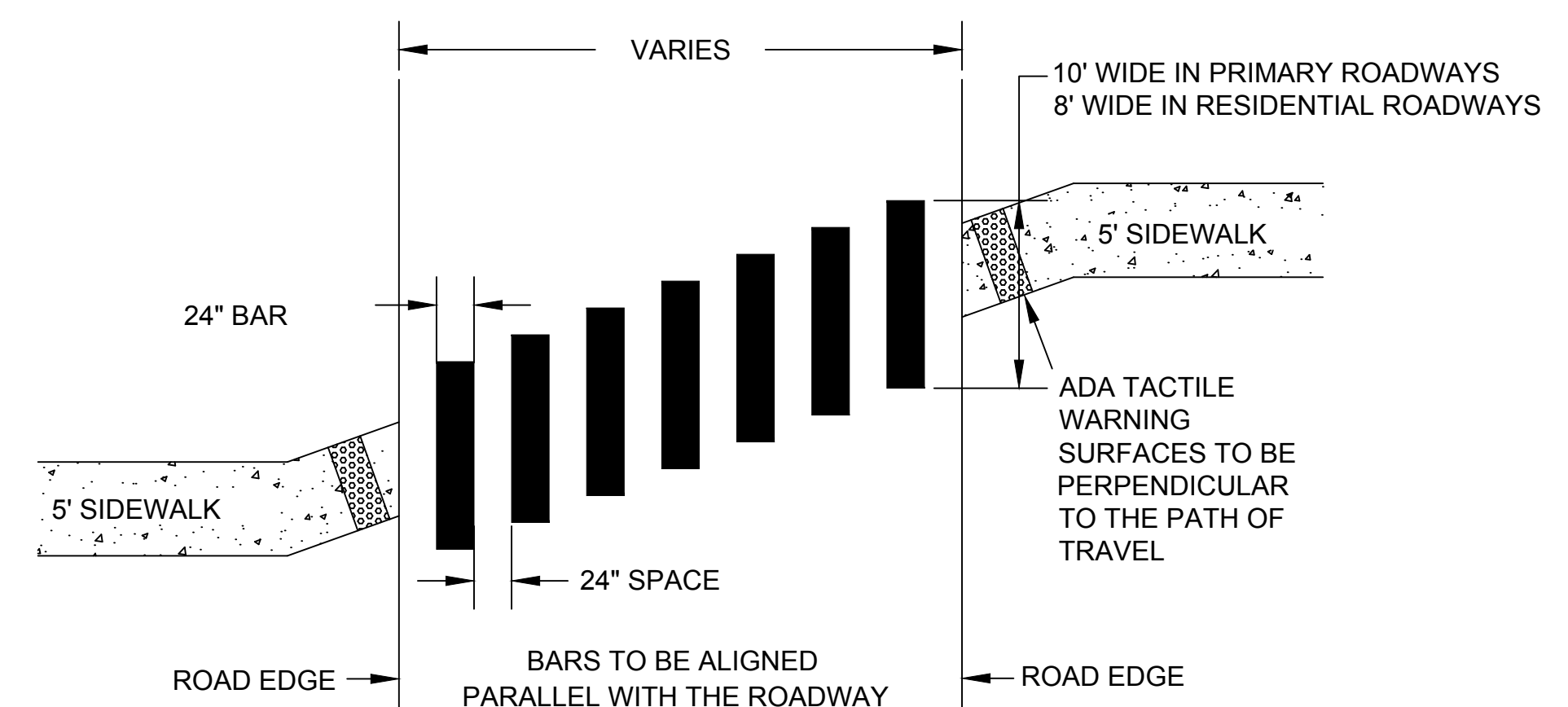
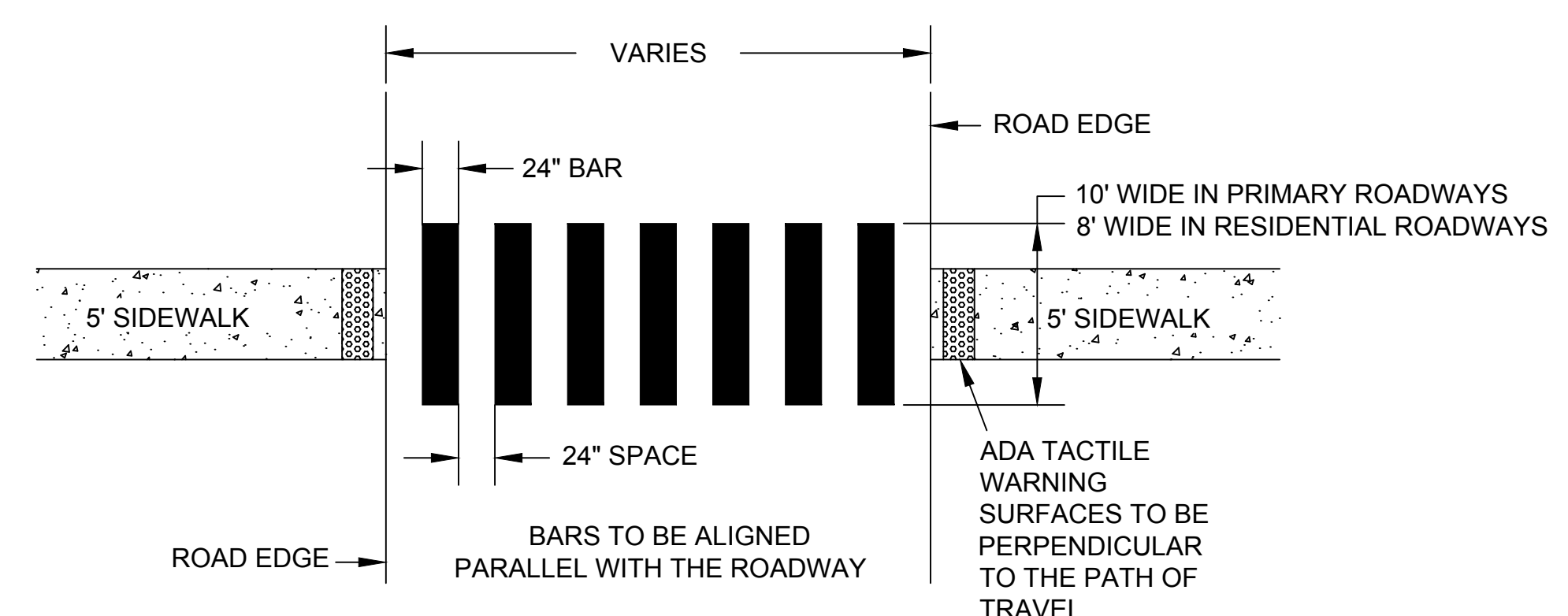

CROSSWALKS

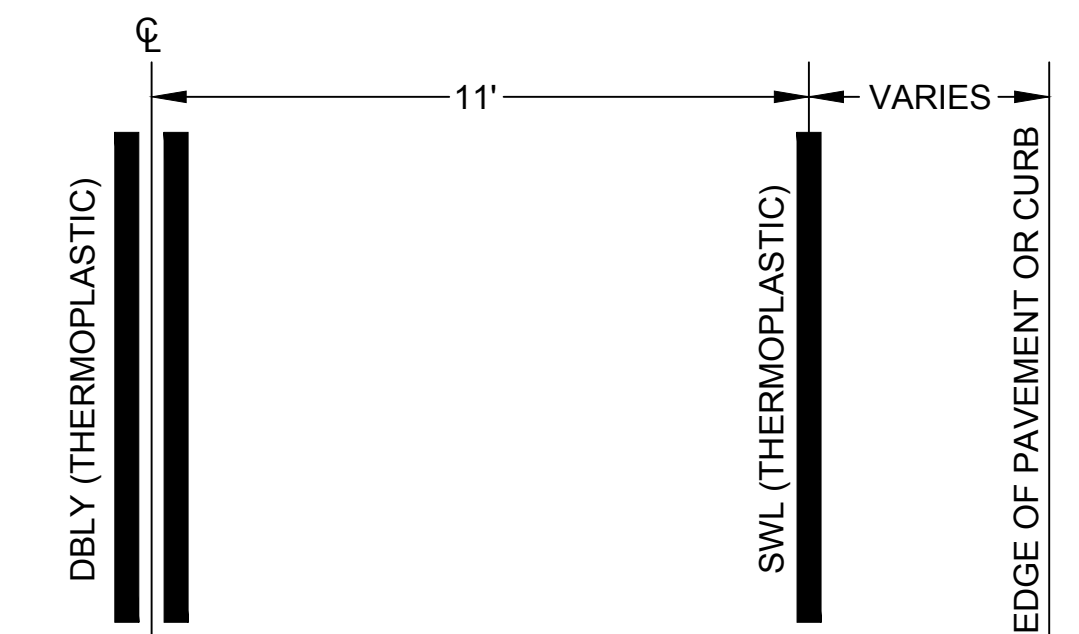

LINE STRIPING

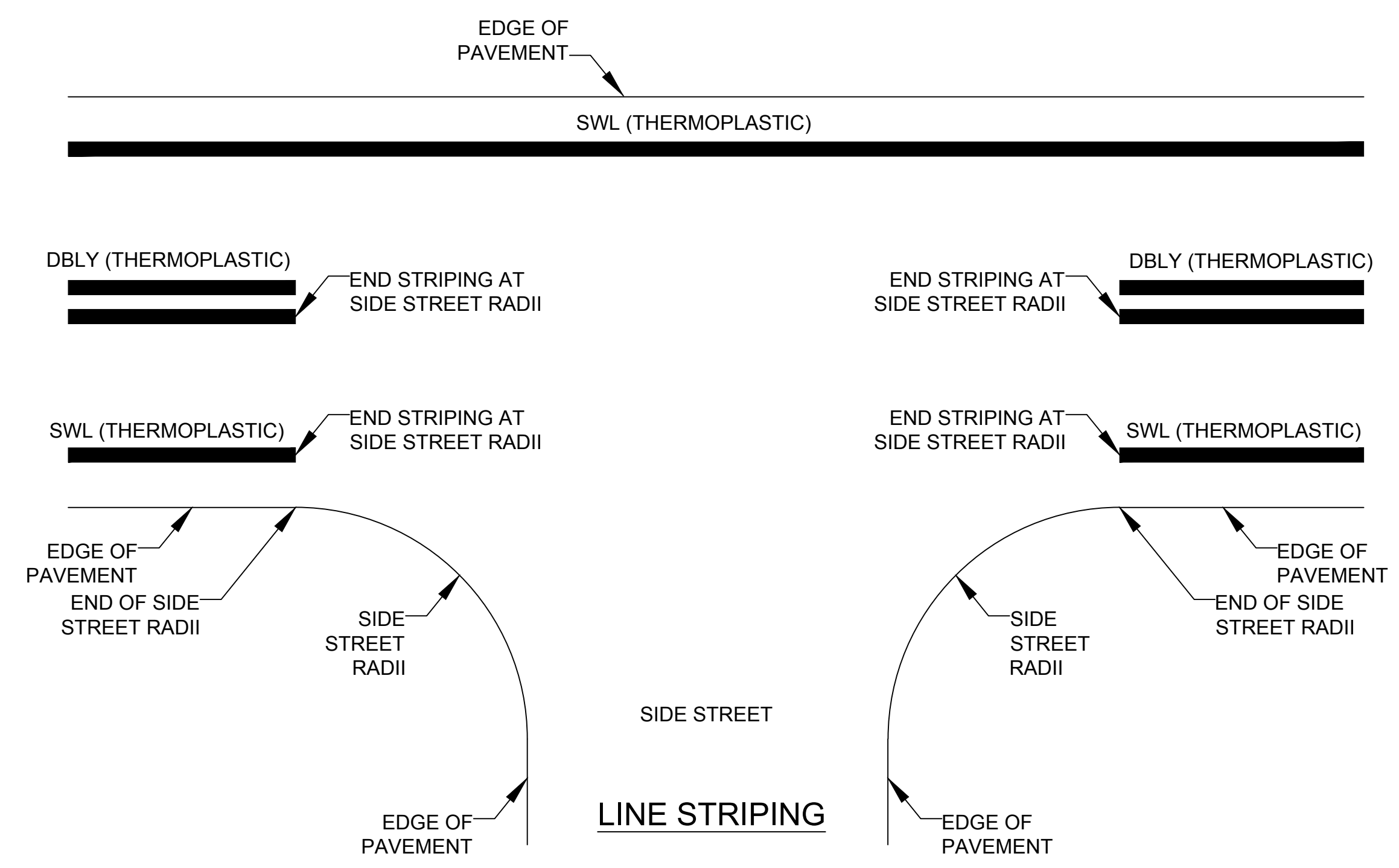

TOWN of LONGMEADOW ENGINEERING DEPARTMENT  
F.Y. 2020 STREET RESURFACING PROJECT

Longmeadow Paving Details

SCALE: N.T.S. DATE: 2019  
2020 Resurfacing Plans Bid Doc.dwg Drawn by: CM Approved by: AK