

**ADDENDUM No. 2
for
INVITATION FOR BID (IFB)**

WESTERN DRIVE SEWER IMPRVEMENT

**TOWN OF LONGMEADOW
MASSACHUSETTS**

October 9, 2019

This document serves as Addendum No.2 for the Invitation for Bid (IFB) for Western Drive Sewer Improvement. This Addendum forms part of the IFB and modifies the original document. **Acknowledge the receipt of all addenda numbers issued on the BID SUBMISSION FORM.** Failure to do so may subject the bidder to disqualification.

The following changes and/or additions are to be made to the original Invitation for Bid dated September 26, 2019; and Addendum No. 1 dated October 4, 2019:

1. REVISED BID DEADLINE

Delete reference to the bid deadline of Thursday, October 10, 2019 at 11:00am. In its place insert the **revised bid deadline of Thursday, October 17, 2019 at 11:00am.**

2. REVISED PLAN PAGES

Replace page 3 and 4 of the plan set with the two plan pages supplied with this addendum.

3. REVISED NOTICE TO PROCEED AND SUBSTANTIAL COMPLETION DATE

Delete reference in the original bid document to noted Notice to Proceed and Substantial Completion dates. In its place insert the revised Notice to Proceed date of April 1, 2020. For the Substantial Completion Date insert the revised substantial completion date of June 30, 2020. These date changes will also be reflected in the sample Contract terms and conditions supplied in the original bid document. This project will now be a Spring, 2020 project, instead of a fall 2019 project.

4. QUESTION AND RESPONSE:

QUESTION: Can clarification be provided on item 703.1?

The detail talks about a 2" mill & machine-paved overlay.

However, I don't see it again mentioned anywhere.

Will a 2" Mill and machine-paved overlay of the trench indeed be required?

RESPONSE: There is no mill required, two inches of base and two inches of top Hot Mix Asphalt. See Attached Revision of details.

QUESTION: On the plans it shows existing SMH 351 having an inlet from the South and West. From what I can tell the plans do not address the pipe from the West invert being tied into the new section of sewer main. Unless I am looking at it wrong.

RESPONSE: See Attached revision of plans for question on SMH 351.

QUESTION: I have a question regarding the Western Drive Project please. The advertisement states that final completion in ninety days from the notice of award. With

winter coming and the fact that the asphalt plants will be closing in November I am wondering whether the Town will be having the project begin this year with winter stoppage time to finish in the spring or is it the plan to start in the spring 2020?

RESPONSE: The timeline for this project has changed. Instead of this being a fall project it will now be a spring project. Delete reference to the conflicting Substantial Completion date following 60 and 90 days following the Notice to Proceed date. In its place insert that the Notice to Proceed date will be April 1, 2020 and the Substantial Completion Date will be June 30, 2020.

5. ADDITIONAL REGISTERED BID LIST:

A list of those that have currently requested to be added to the bid list not already listed in the Addendum No.1 bid list includes the following:

Ferguson Waterworks, Ludlow, MA; Crestview Construction, Southwick, MA ; Morais Concrete, Springfield, MA; Gagliarducci Construction, Springfield, MA; Caracas Construction Corporation, Ludlow, MA; Projectdog

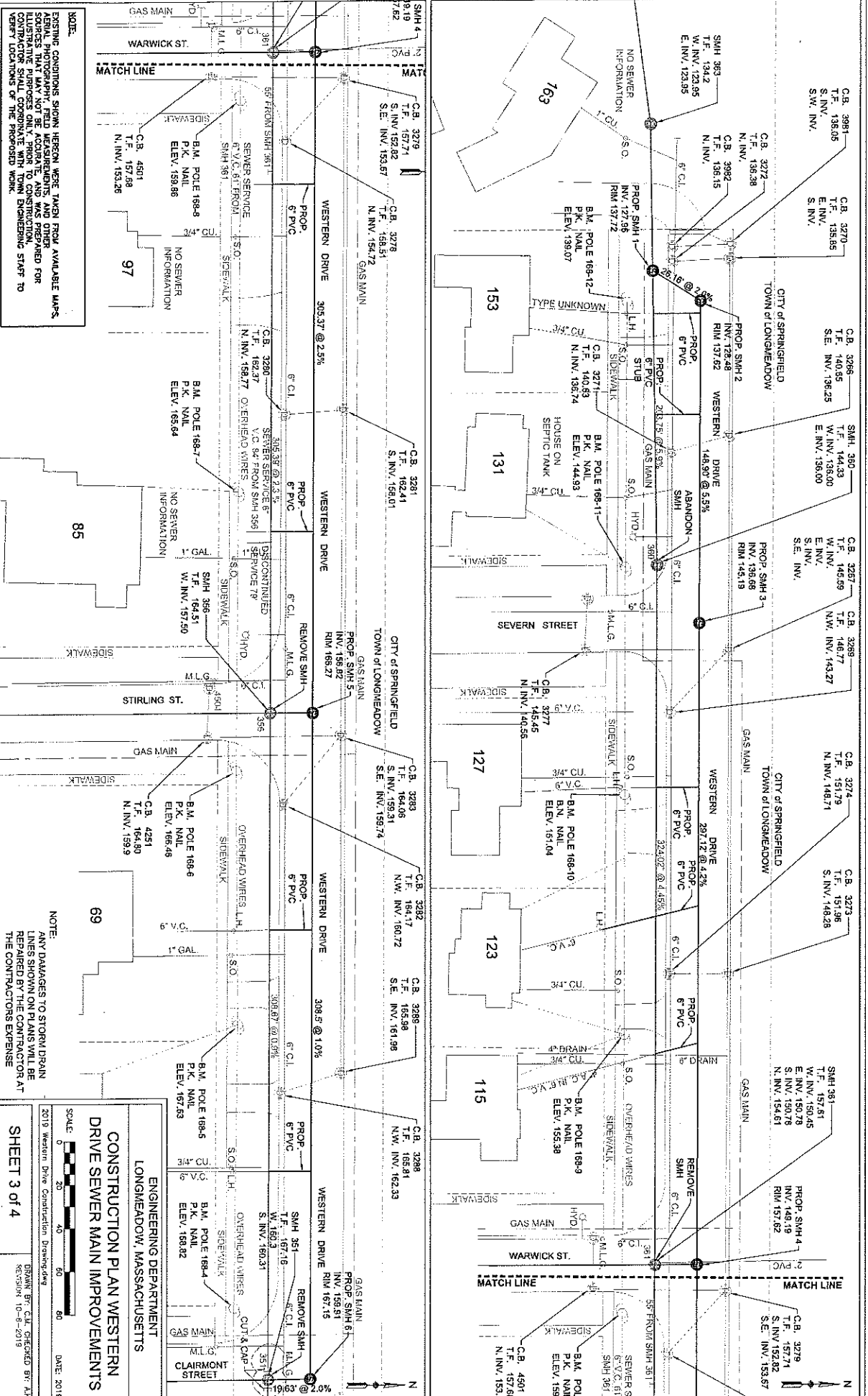

NOTE:
 EXISTING CONDITIONS SHOWN HEREON WERE TAKEN FROM AVAILABLE MAPS, AERIAL PHOTOGRAPHY, FIELD MEASUREMENTS AND OTHER INFORMATION. CONTRACTOR SHALL VERIFY LOCATIONS OF THE PROPOSED WORK.

NOTE:
 ANY DAMAGES TO STORM DRAIN LINES SHOWN ON PLANS WILL BE REPAIRED BY THE CONTRACTOR AT THE CONTRACTORS EXPENSE.

ENGINEERING DEPARTMENT
 LONGMEADOW, MASSACHUSETTS

CONSTRUCTION PLAN WESTERN
 DRIVE SEWER MAIN IMPROVEMENTS

SCALE: 1" = 20'

DATE: 2018

2019 Western Drive Construction Drawing.dwg

DESIGN BY: C.L. GREGG/ B.T. AZZ
 CHECKED BY: B.T. AZZ
 10-8-2019

SHEET 3 of 4

FINISHMENT TRENCH FACING 2" OR MORE
MIX ASPHALT TOP SHALL BE PAVED
WITH MECHANICAL PAVING.
SURFACE REPAIR WIDTH
(SEE TABLE A)

SEWER TRENCH SECTION IN ROAD WAY
NOT TO SCALE

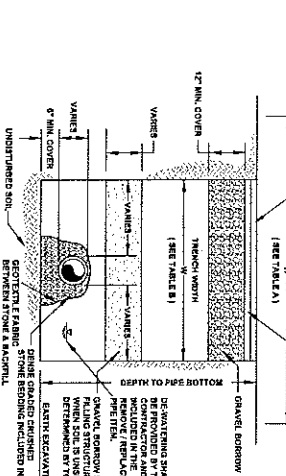

SEWER TRENCH SECTION IN TREE BELT
NOT TO SCALE

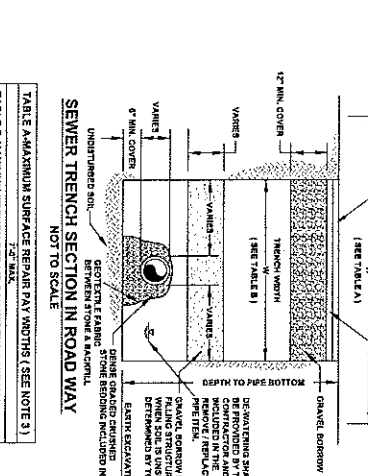

TABLE A-MAXIMUM SURFACE REPAIR PAY WIDTHS (SEE NOTE 3)

TABLE B-MAXIMUM TRENCH REPAIR PAY WIDTHS (SEE NOTE 3)

7-1/2" MAX. TEMP. P.C.P.	TEMP. P.C.P.
-----------------------------	--------------

- NOTES:**
1. INCLUDING TEMPORARY PAVEMENT PATCHES FOR SIDEWALKS AND DRIVEWAYS.
 2. MAXIMUM TRENCH REPAIR PAY WIDTHS SHALL BE AS SPECIFIED IN THE TABLES.
 3. THE PAY IS THE DIMENSION ALONG THE TRENCH SURFACE MEASURED FROM THE CENTERLINE TO THE ACTUAL SURFACE REPAIR PATCH BOUNDARIES. THE ACTUAL SURFACE REPAIR PATCH BOUNDARIES SHALL BE PAID FOR AT THE APPLICABLE UNIT PRICE. THE ACTUAL SURFACE REPAIR PATCH BOUNDARIES SHALL BE PAID FOR AT THE APPLICABLE UNIT PRICE.

TRENCH EXCAVATION AND SURFACE REPAIR PAYLINES

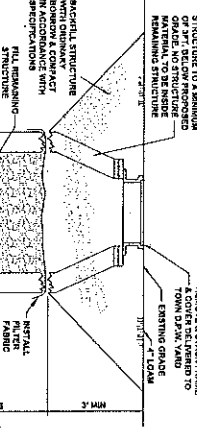

SANITARY MANHOLE ABANDONMENT
NOT TO SCALE

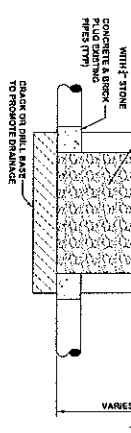

48" PRECAST SANITARY SEWER MANHOLE
NOT TO SCALE

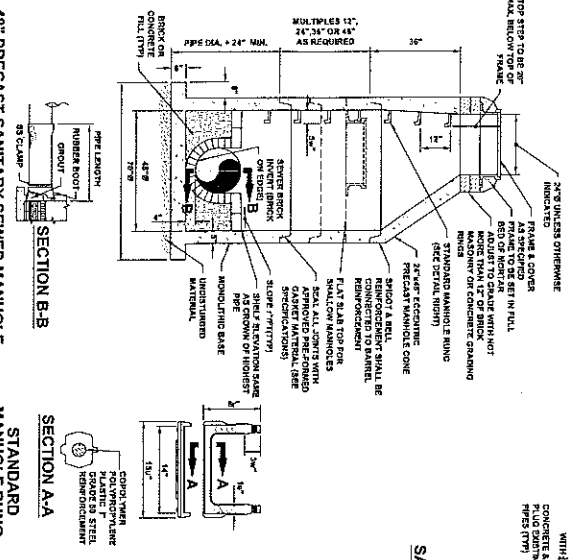

STANDARD MANHOLE RING
NOT TO SCALE

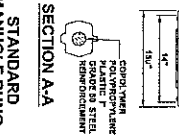

STANDARD MANHOLE COVER
NOT TO SCALE

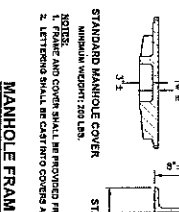

MANHOLE FRAME & COVER
NOT TO SCALE

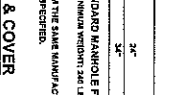

HOT MIX ASPHALT DRIVEWAY DETAIL
NOT TO SCALE



HOT MIX ASPHALT SIDEWALK DETAIL
NOT TO SCALE

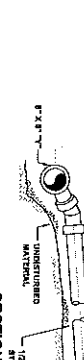

CONCRETE SIDEWALK DETAIL PLAN VIEW
(SCALE: N.T.S.)



TYPICAL BUILDING CONNECTION
NOT TO SCALE

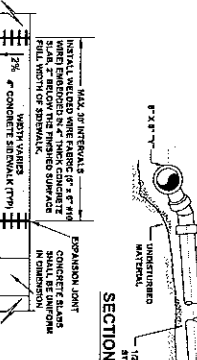

INTERIOR MANHOLE CHIMNEY
NOT TO SCALE

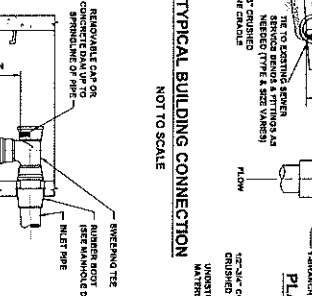

PIPE STRAP DETAIL

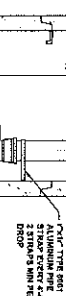

PROP. SMH INVERT
NOT TO SCALE

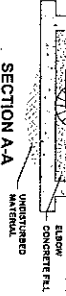

PROP. SMH INVERT
NOT TO SCALE

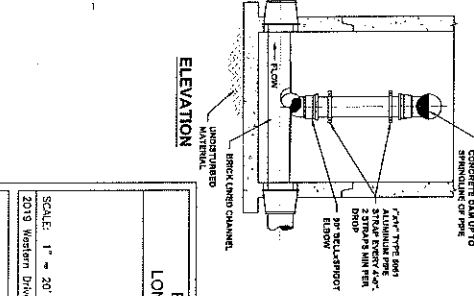

MISCELLANEOUS SEWER DETAILS

ENGINEERING DEPARTMENT
LONGMEADOW, MASSACHUSETTS

SCALE: 1" = 20'

DRAWN BY: C.K. CROCCO
CHECKED BY: A.K. HANSEN

DATE: 2019

2019 Western Drive Construction Drawing, Inc.

SHEET 4 OF 4

(End – Addendum No. 2)