

- CONTRACTOR NOTES:**
- CONTRACTOR SHALL PROVIDE CLEARING AND GRUBBING, STUMP REMOVAL, AND DEBRIS REMOVAL WITHIN THE PROJECT LIMITS SHOWN. NOTE TREES, BRUSH AND AND DEBRIS ARE NOT SHOWN.
 - CONTRACTOR SHALL PROVIDE CONTINUAL ACCESS TO THE PROJECT SITE AND PROTECT ALL SITE AND PROPERTY COMPONENTS FROM DAMAGE. THE CONTRACTOR SHALL BE AWARE THAT THE EXISTING SITE IS AN ACTIVE RESIDENTIAL NEIGHBORHOOD WHICH REQUIRES ROUTINE ACCESS BY THE OWNER FOR OPERATIONS AND MAINTENANCE PURPOSES AND LOCAL RESIDENCES FOR EGRESS.
 - CONTRACTOR SHALL PROVIDE CONTINUAL FLOW CONVEYANCE FOR THE "DINGLE" AND THE PERENNIAL STREAM. THE PERENNIAL STREAM FLOWS CONTINUOUSLY THROUGHOUT THE YEAR THROUGH THE PROJECT SITE.
 - CONTRACTOR SHALL ADJUST PROPOSED GRADING AS NECESSARY TO PROVIDE SHEET FLOW ACROSS PAVED AND CROSS COUNTRY AREAS AS INDICATED.
 - CONTRACTOR SHALL PROVIDE TEMPORARY SITE FENCING AND ROAD/SITE BARRICADES AS NECESSARY.
 - REPAIR ALL AREAS OF DISTURBED PAVEMENT/DRIVEWAYS/CURBING IN ACCORDANCE WITH THE DETAILS AND CONTRACT DOCUMENTS.
 - REPAIR ALL DISTURBED CROSS COUNTRY AREAS IN ACCORDANCE WITH THE DETAILS AND CONTRACT DOCUMENTS.
 - BURIED UTILITIES AND UTILITY SERVICES ARE SHOWN TO THE EXTENT AVAILABLE AND ARE APPROXIMATE. CONTRACTOR SHALL CONDUCT TEST PITS AS REQUIRED TO LOCATE ALL UTILITIES AND UTILITY SERVICES. TEST PITS SHALL BE CONSIDERED INCIDENTAL TO CONSTRUCTION.
 - CONTRACTOR TO RE-USE EXISTING SOIL MATERIALS TO BACKFILL AND GRADE THE PROJECT AREA. FILL MATERIALS AND LOOM TO BE PROVIDED BY THE CONTRACTOR. EXCESS SOIL MATERIALS TO BE DISPOSED OF BY THE CONTRACTOR.

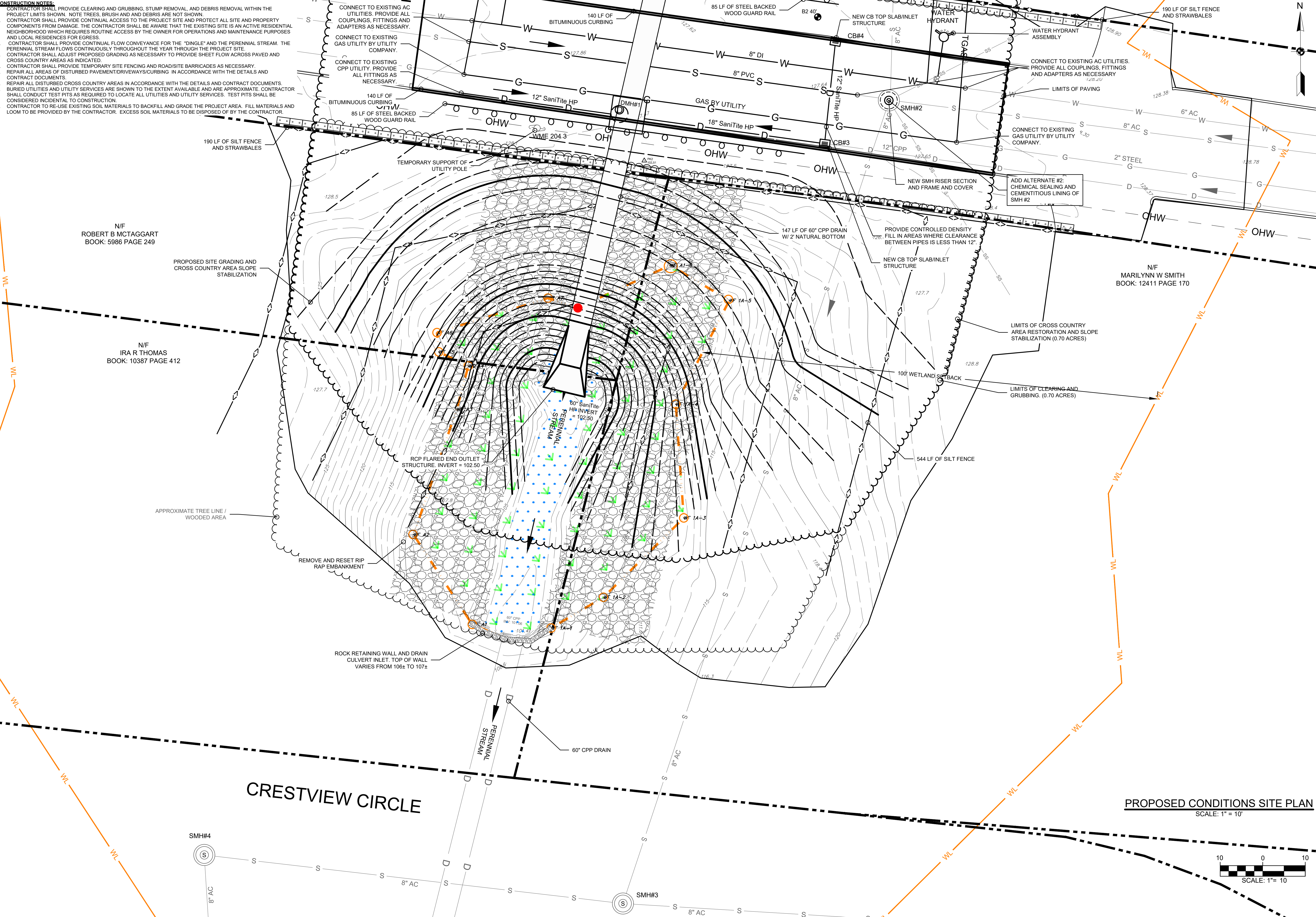

N/F
ROBERT B MCTAGGART
BOOK: 5986 PAGE 249

N/F
IRA R THOMAS
BOOK: 10387 PAGE 412

N/F
MARILYNN W SMITH
BOOK: 12411 PAGE 170

CRESTVIEW CIRCLE

PROPOSED CONDITIONS SITE PLAN
SCALE: 1" = 10'



DPC ENGINEERING, LLC
22 Northfield Road
Longmeadow, MA 01106
(413) 567-5310
(413) 567-1030
DPCENGINEERING.COM

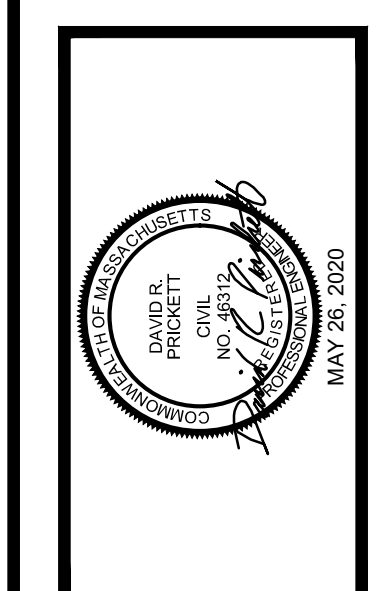
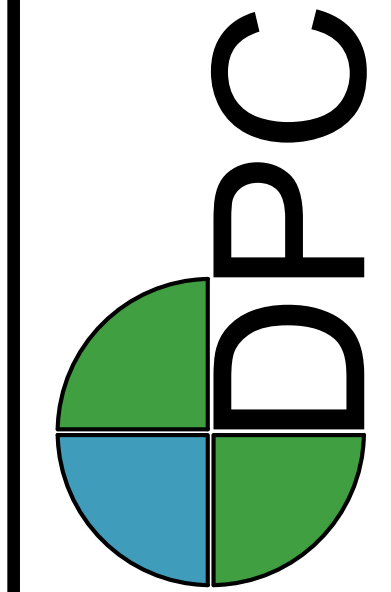

DATE:	DESCRIPTION:	AMID REV:	ISSUED FOR:
5/26/2020	ISSUED FOR BIDDING	1	
		2	
		3	
		4	
		5	
		6	
		7	

CHANNEL GRADING AND ESTABLISHMENT AT CRESTVIEW CULVERT

MORNINGSIDE DRIVE CULVERT REPLACEMENT PROJECT
DEPARTMENT OF PUBLIC WORKS
LONGMEADOW, MASSACHUSETTS

SCALE: AS NOTED
SCALE SHEET SIZE: 22X34
JOB NO.:
DATE: JUNE 2020
SHEET: 5 OF 8
C-3

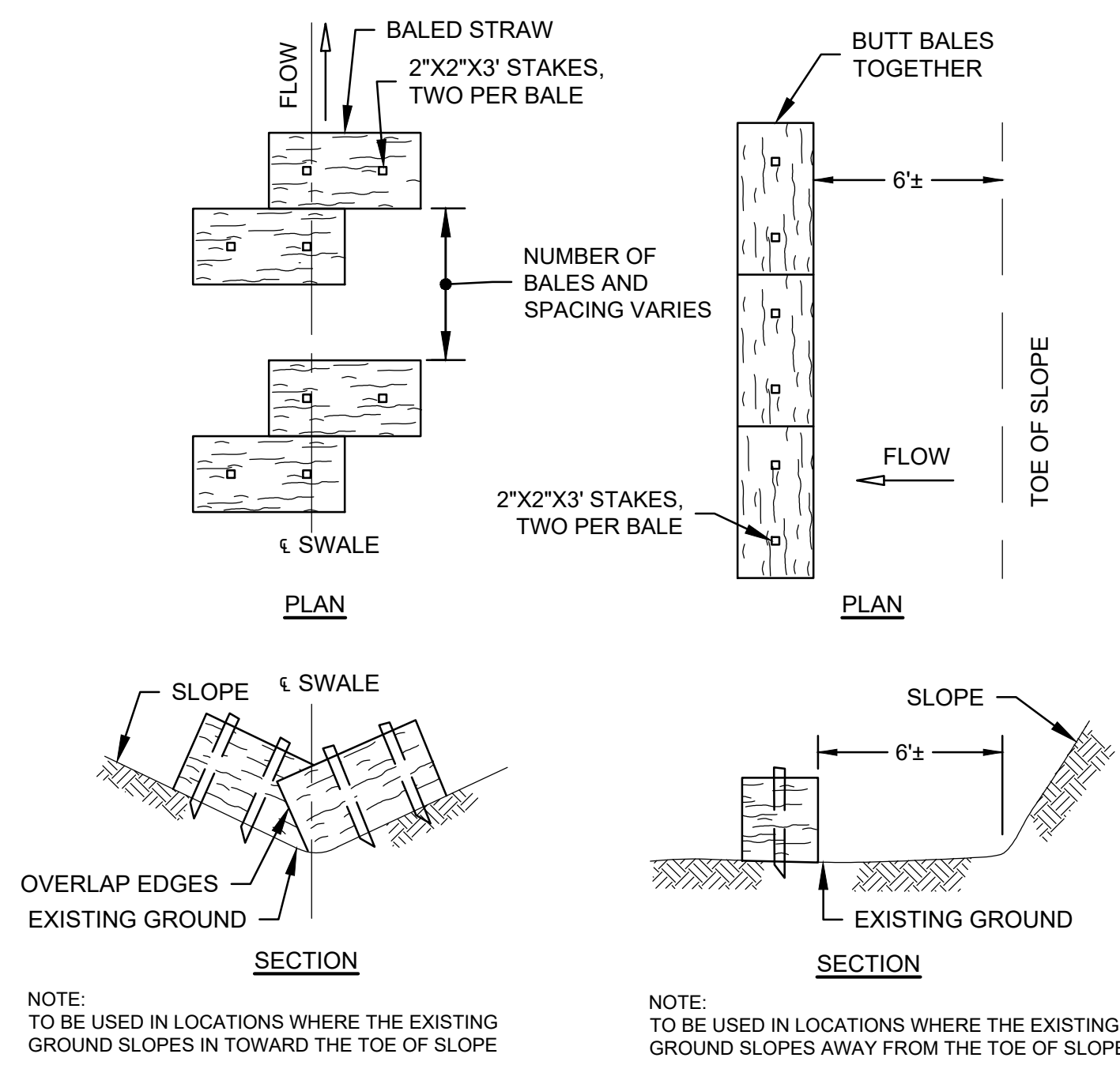

STRAW BALES DETAIL
N.T.S.

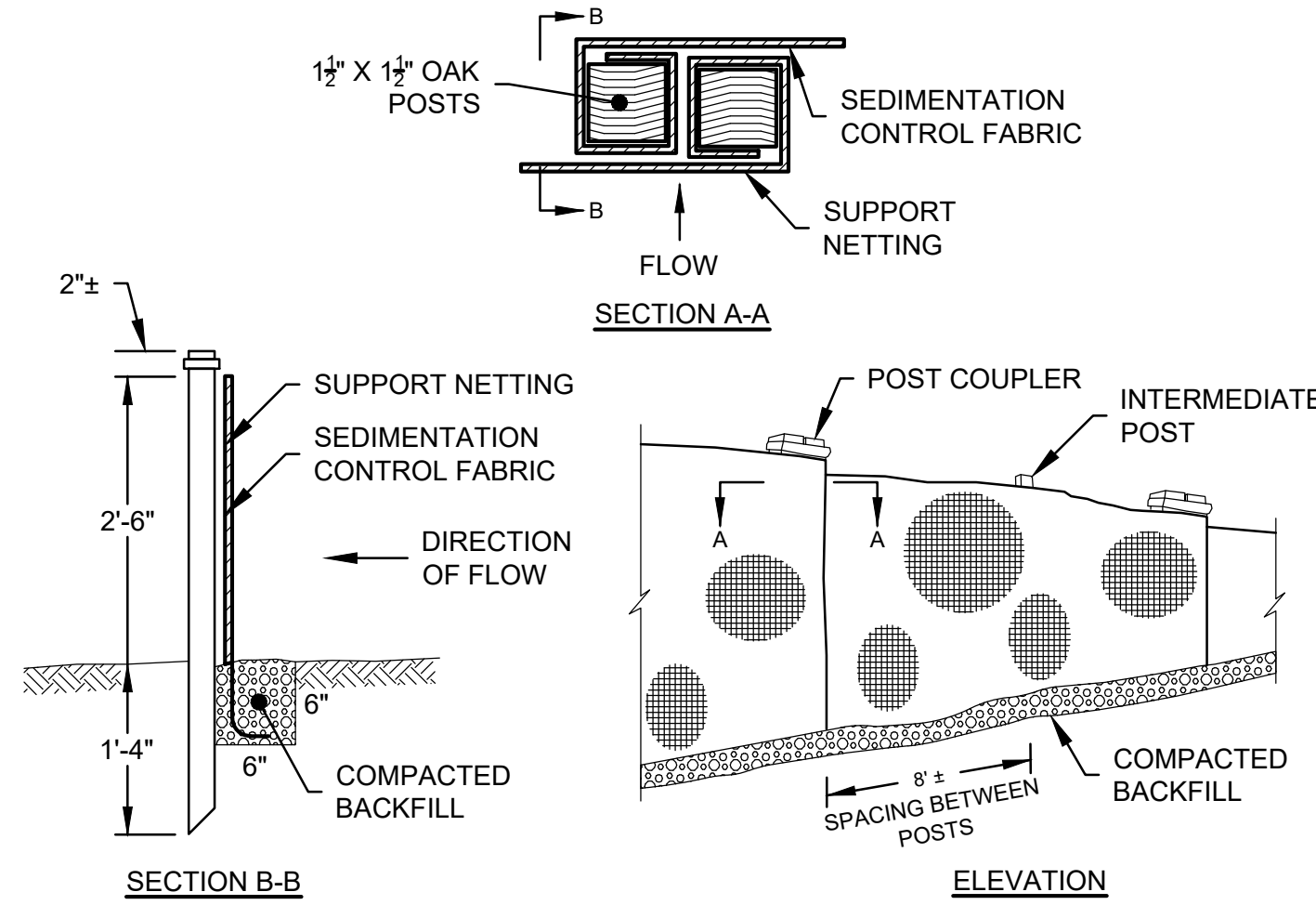

SILT FENCE DETAIL
N.T.S.

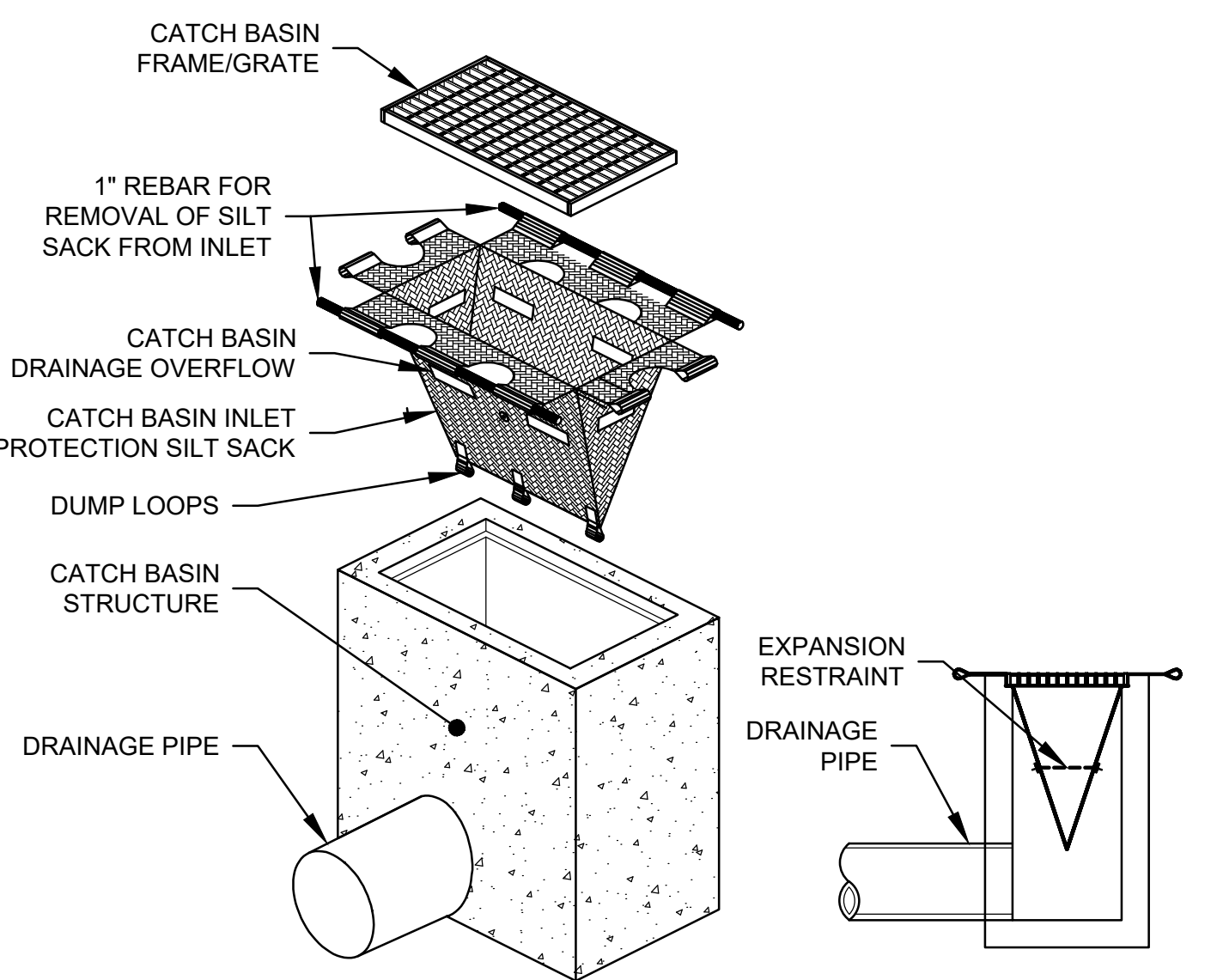

CATCH BASIN INLET PROTECTION
N.T.S.

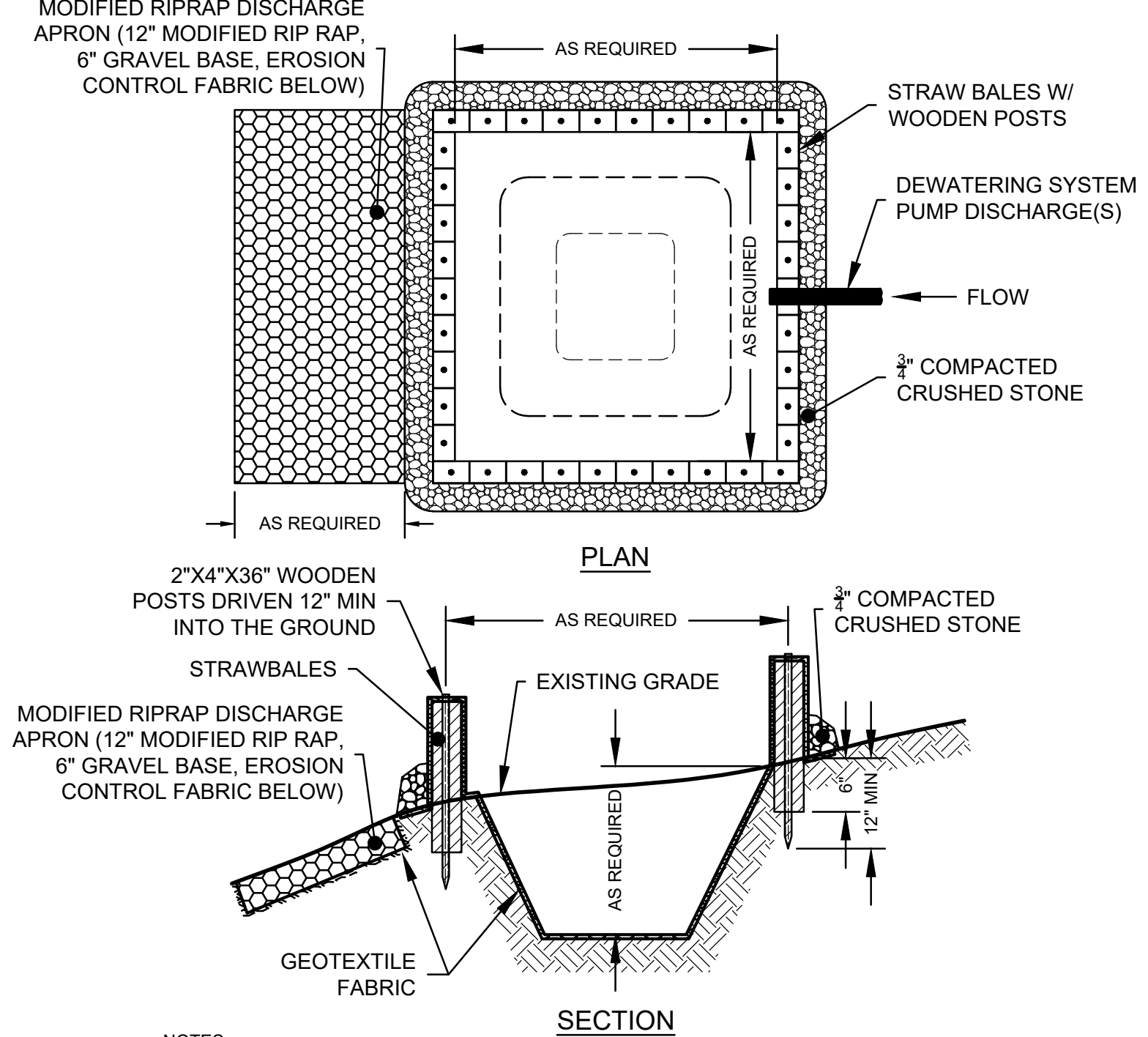

- NOTES:**
1. THE CONTRACTOR SHALL SIZE BASIN BASED ON THE SELECTED PUMP DISCHARGE FLOWS, AND ENLARGE AS NECESSARY AT NO ADDITIONAL COST TO THE OWNER, TO ALLOW FOR PROPER FUNCTION OF THE BASIN.
 2. ALTERNATE SEDIMENTATION BASINS MAY BE USED WITH PRIOR APPROVAL OF THE ENGINEER.
 3. BASIN LOCATION(S) SHALL BE APPROVED BY THE ENGINEER PRIOR TO CONSTRUCTION.

TYPICAL SEDIMENTATION BASIN
N.T.S.

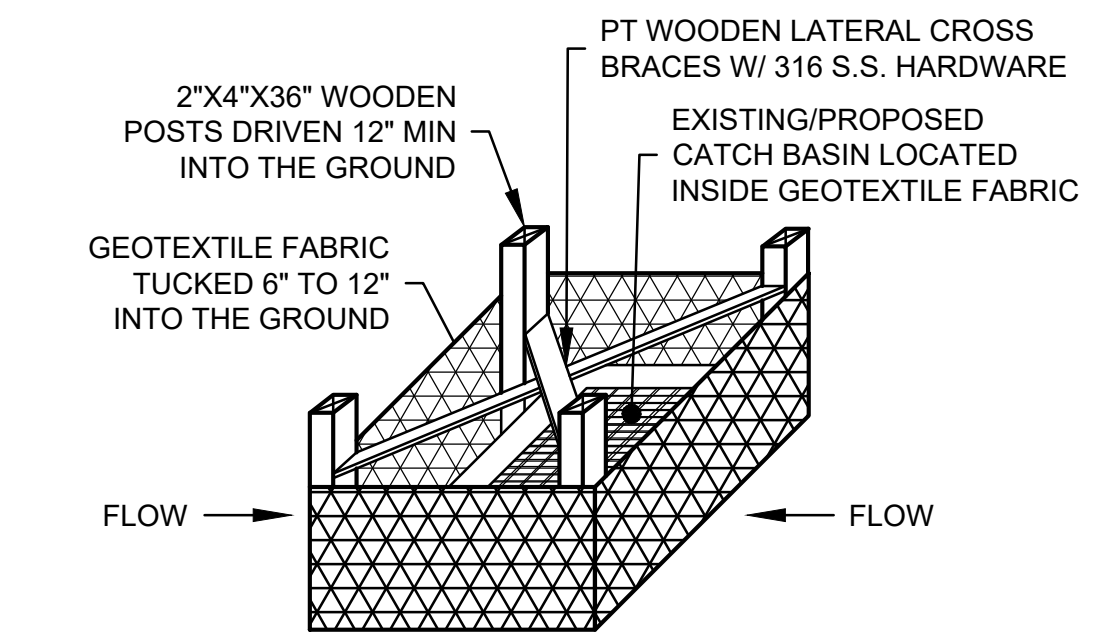

GEOTEXTILE FABRIC INSTALLATION AT CATCH BASINS AND EXFILTRATION TRENCHES
N.T.S.

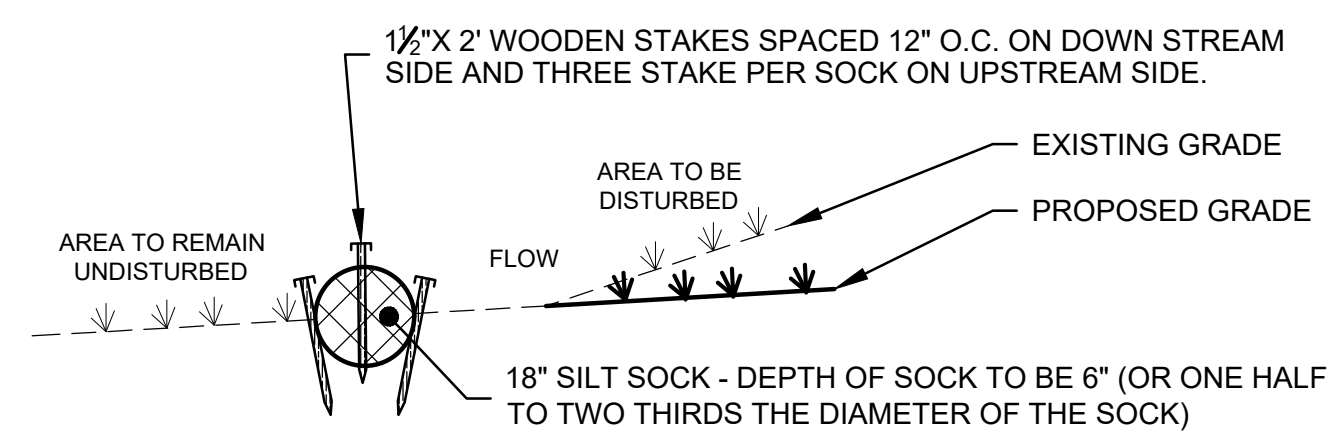

SILT SOCK EROSION CONTROL DETAIL
N.T.S.

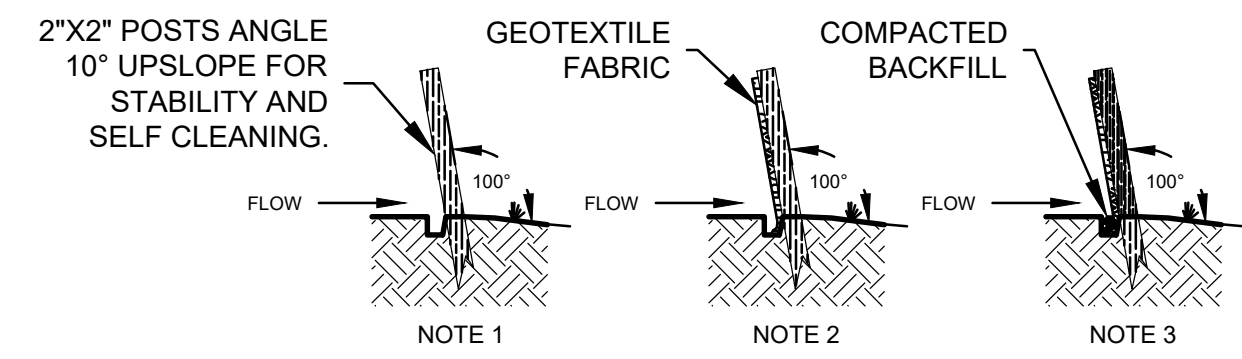

- NOTES:**
1. SET POSTS AND EXCAVATE A 6"X6" TRENCH. SET POSTS DOWNSLOPE.
 2. ATTACH GEOTEXTILE TO THE POSTS AND EXTEND IT TO THE TRENCH. MINIMUM LENGTH OF GEOTEXTILE IS 15'. MINIMUM SPACING OF POSTS IS 10'. JOINTS ONLY SUPPORT POSTS WITH A MINIMUM 6" OVERLAP.
 3. BACKFILL THE TRENCH AND COMPACT THE EXCAVATED SOIL.

SEDIMENTATION CONTROL SYSTEM INSTALLATION
N.T.S.

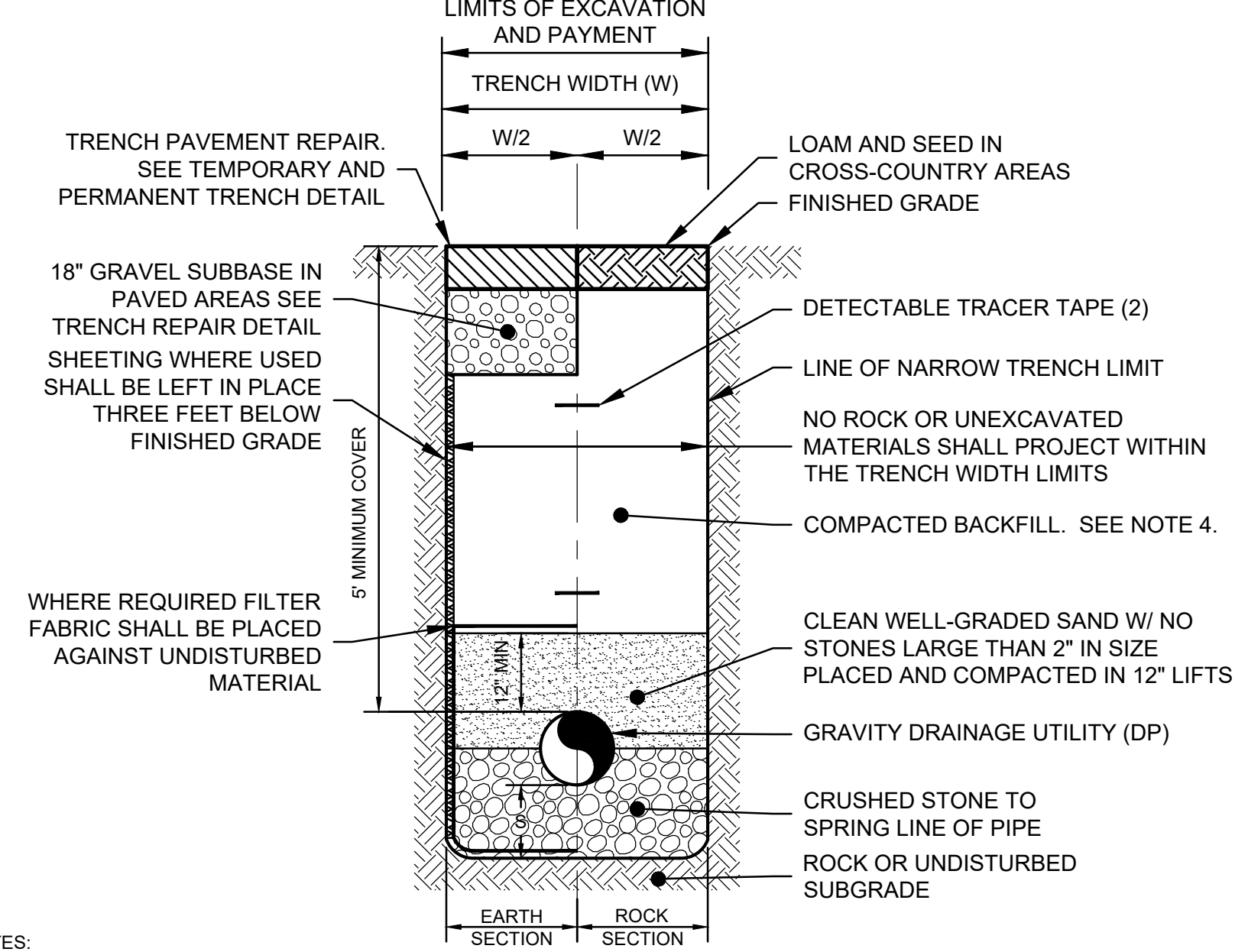

- NOTES:**
1. SEE PLANS FOR SEWER AND OR DRAIN SIZE AND TYPE.
 2. SEE PLANS AND SPECIFICATION FOR RESTORATION LOCATIONS AND DETAILS.
 3. DRAIN TRENCHES MAY BE EXCAVATED WIDER THAN THE 'LIMIT OF EXCAVATION AND PAYMENT' ABOVE THE 'LINE OF NARROW TRENCH LIMIT.' ANY SUCH ADDITIONAL EXCAVATION SHALL BE AT THE CONTRACTOR'S EXPENSE AND SHALL NOT BE MEASURED FOR PAYMENT.
 4. BACKFILL W/ SUITABLE EXCAVATED MATERIAL OR SUBSTITUTE SUITABLE HAULED BACKFILL. REMOVE ALL STONES GREATER THAN 6" IN SIZE. USE PLATE COMPACTOR FOR COMPACTION IN LIFTS NO GREATER THAN 24". COMPACTED BACKFILL SHALL BE COMPACTED TO A MINIMUM 95% MAX DENSITY.
 5. SEE TABLE A FOR W, DP AND S DIMENSIONS.

GRAVITY DRAIN TRENCH DETAIL
N.T.S.

DEPTH TO PIPE INVERT	DIAMETER OF PIPE (DP)	MAXIMUM TRENCH WIDTH BELOW LINE OF NARROW TRENCH LIMIT (SHEETED OR UNSHEETED) (W)	MINIMUM CLEARANCE (S)
0-12'	TO 18"	5'	6"
0-12'	21"-24"	5'	12"
OVER 12'	TO 18"	7'	12"
OVER 12'	21"-24"	7'	18"

TYPICAL UTILITY TRENCH INFORMATION
TABLE A

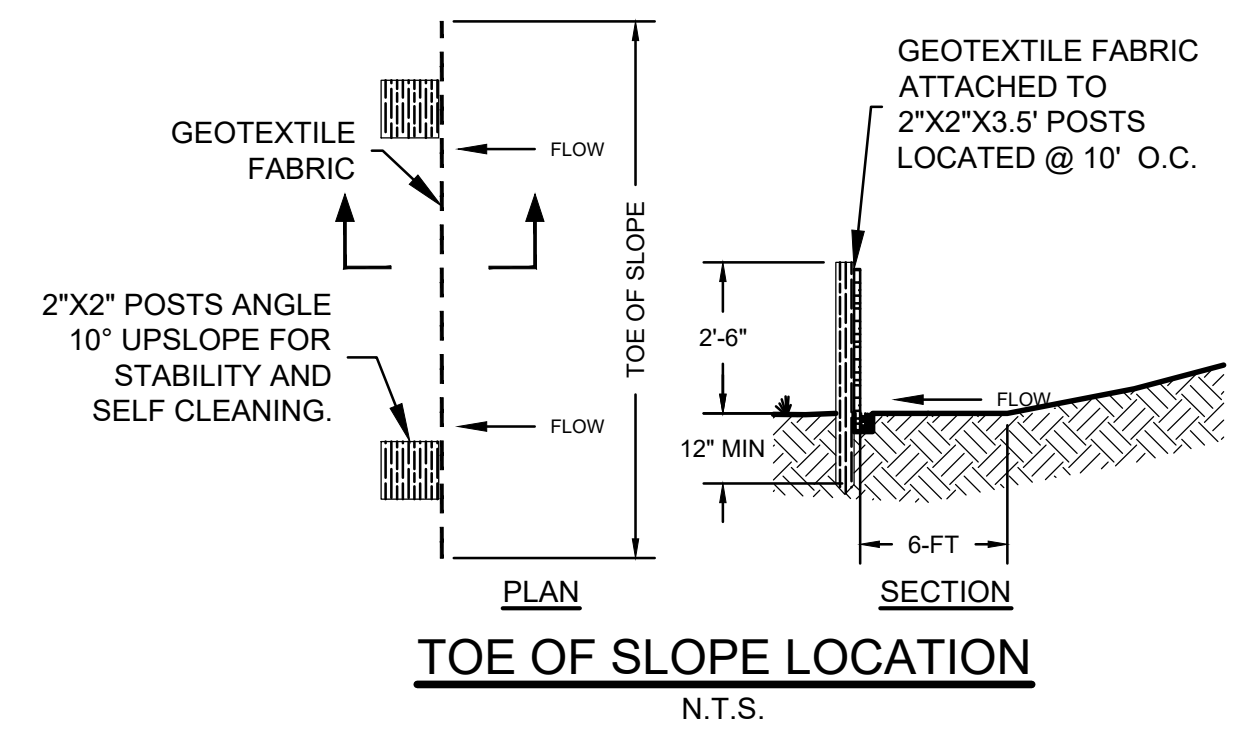

TOE OF SLOPE LOCATION
N.T.S.

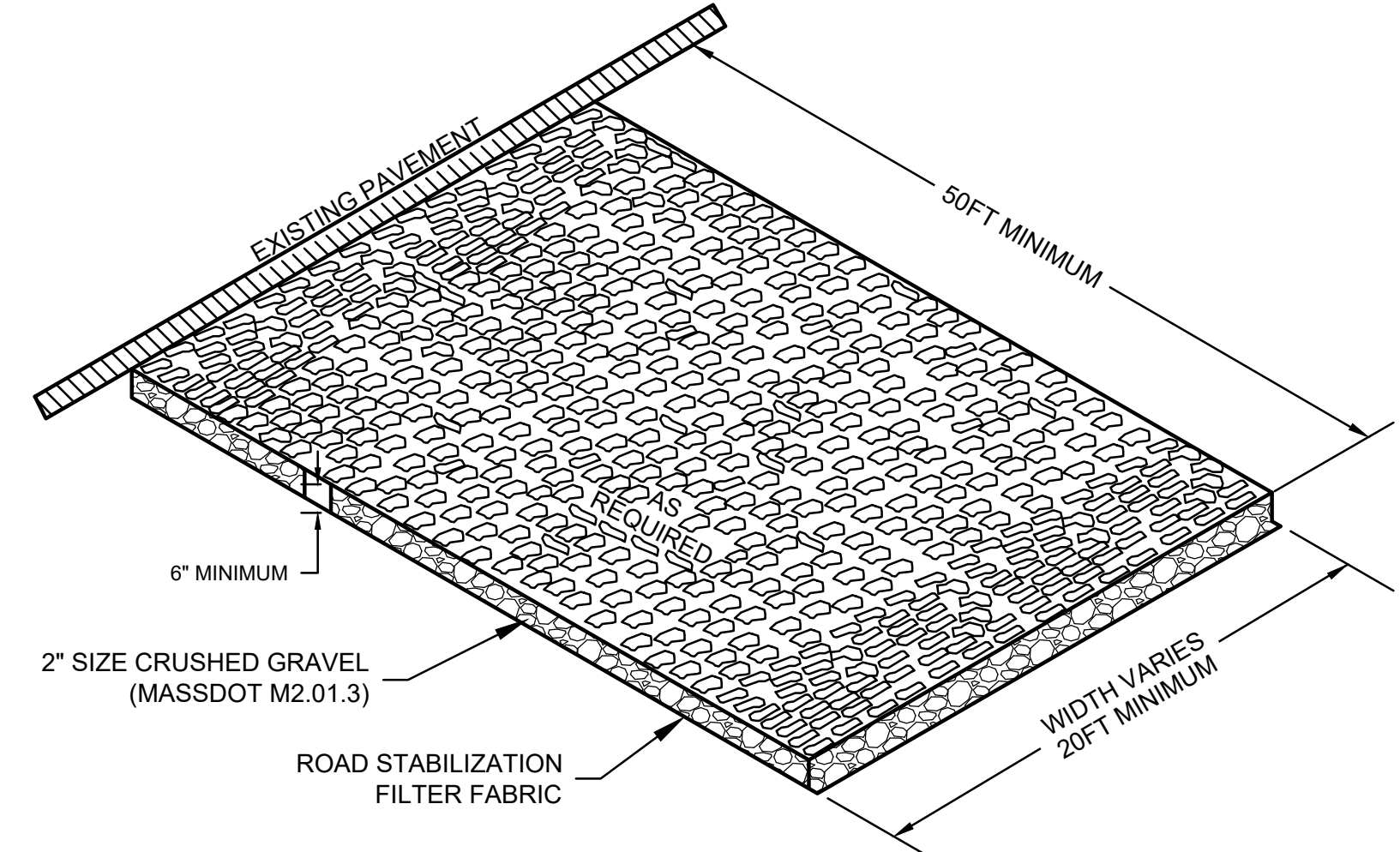

ANTI-TRACKING PAD
N.T.S.

DPC ENGINEERING, LLC
22 Northfield Road
Longmeadow, MA 01106
(413) 567-5310
(413) 567-1030
DPCENGINEERING.COM

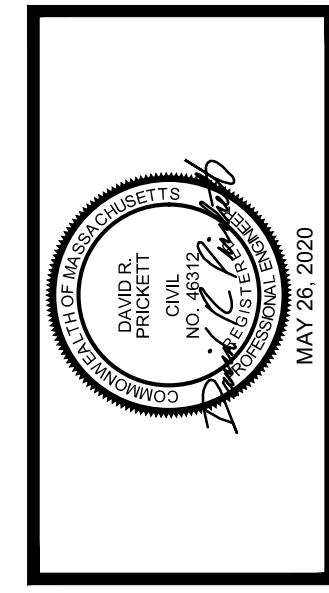
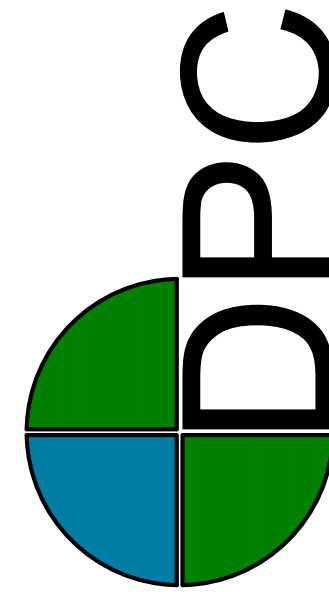

DATE:	5/26/2020
DESCRIPTION:	ISSUED FOR BIDDING
AMID REV:	1
DRAWN BY:	DRP
CHECKED BY:	DRP
APPROVED BY:	DRP
ISSUED FOR:	1 2 3 4 5 6 7

CIVIL DETAILS SHEET 1

MORNINGSIDE DRIVE
CULVERT REPLACEMENT
PROJECT

DEPARTMENT OF PUBLIC WORKS
LONGMEADOW, MASSACHUSETTS

SCALE: AS NOTED
SCALE SHEET SIZE: 22X34
JOB NO.:
DATE: JUNE 2020
SHEET: 6 OF 8
CD-01

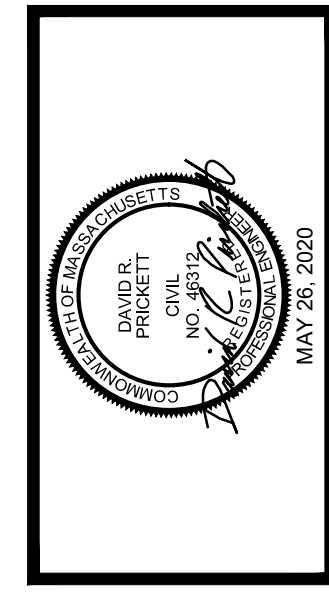
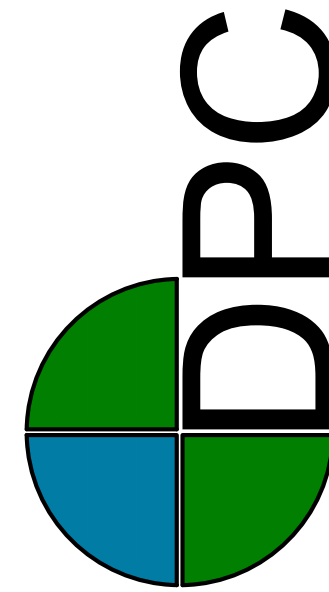

DATE:	5/26/2020
DESCRIPTION:	ISSUED FOR BIDDING
AMID REV:	1 2 3 4 5 6 7
DRAWN BY:	
DESIGNED BY:	
CHECKED BY:	
APPROVED BY:	
ISSUED FOR:	

CIVIL DETAILS SHEET 2

MORNINGSIDE DRIVE
 CULVERT REPLACEMENT
 PROJECT
 DEPARTMENT OF PUBLIC WORKS
 LONGMEADOW, MASSACHUSETTS

SCALE: AS NOTED
 SCALE SHEET SIZE: 22X34
 JOB NO.:
 DATE: JUNE 2020
 SHEET: 7 OF 8

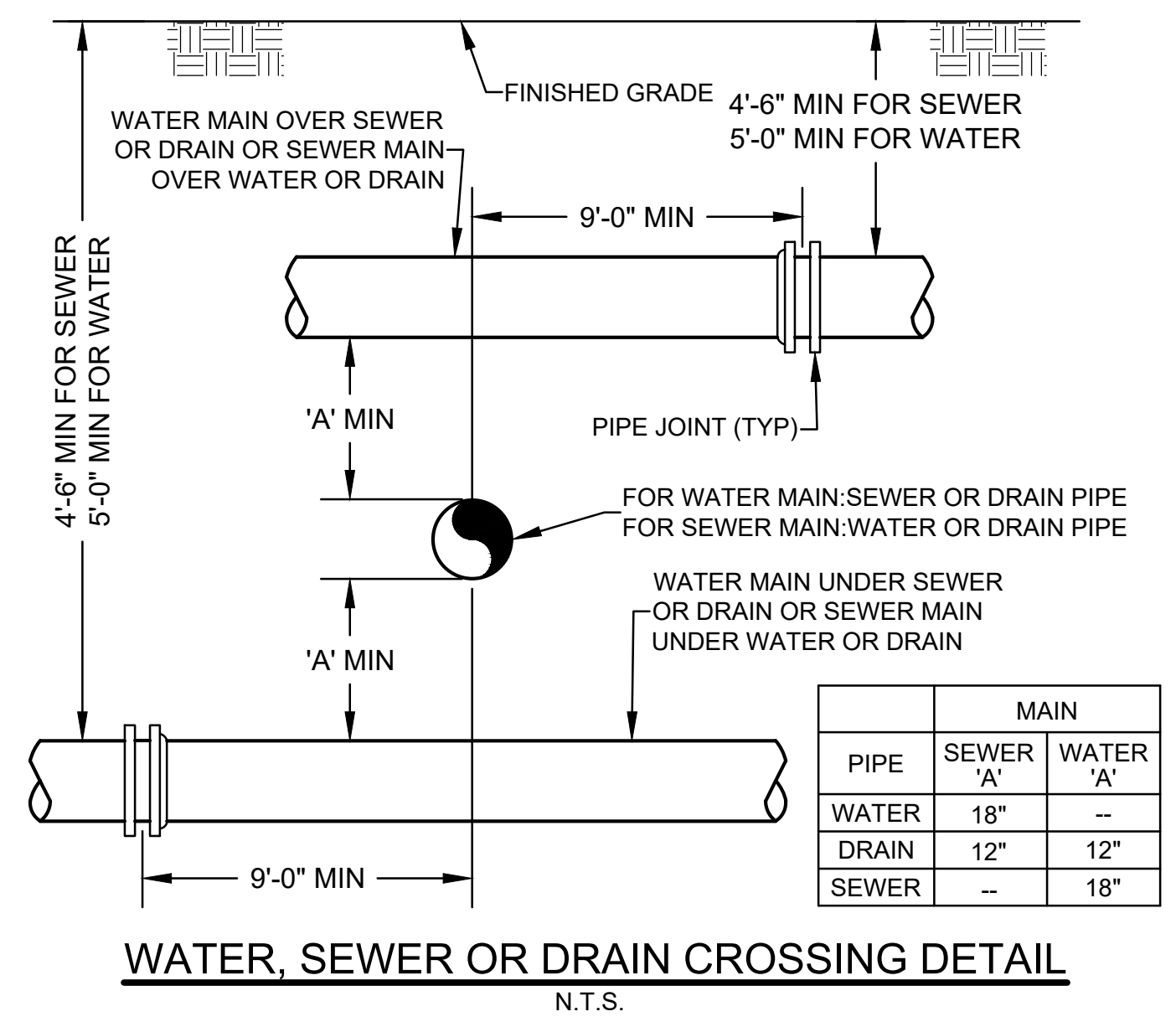
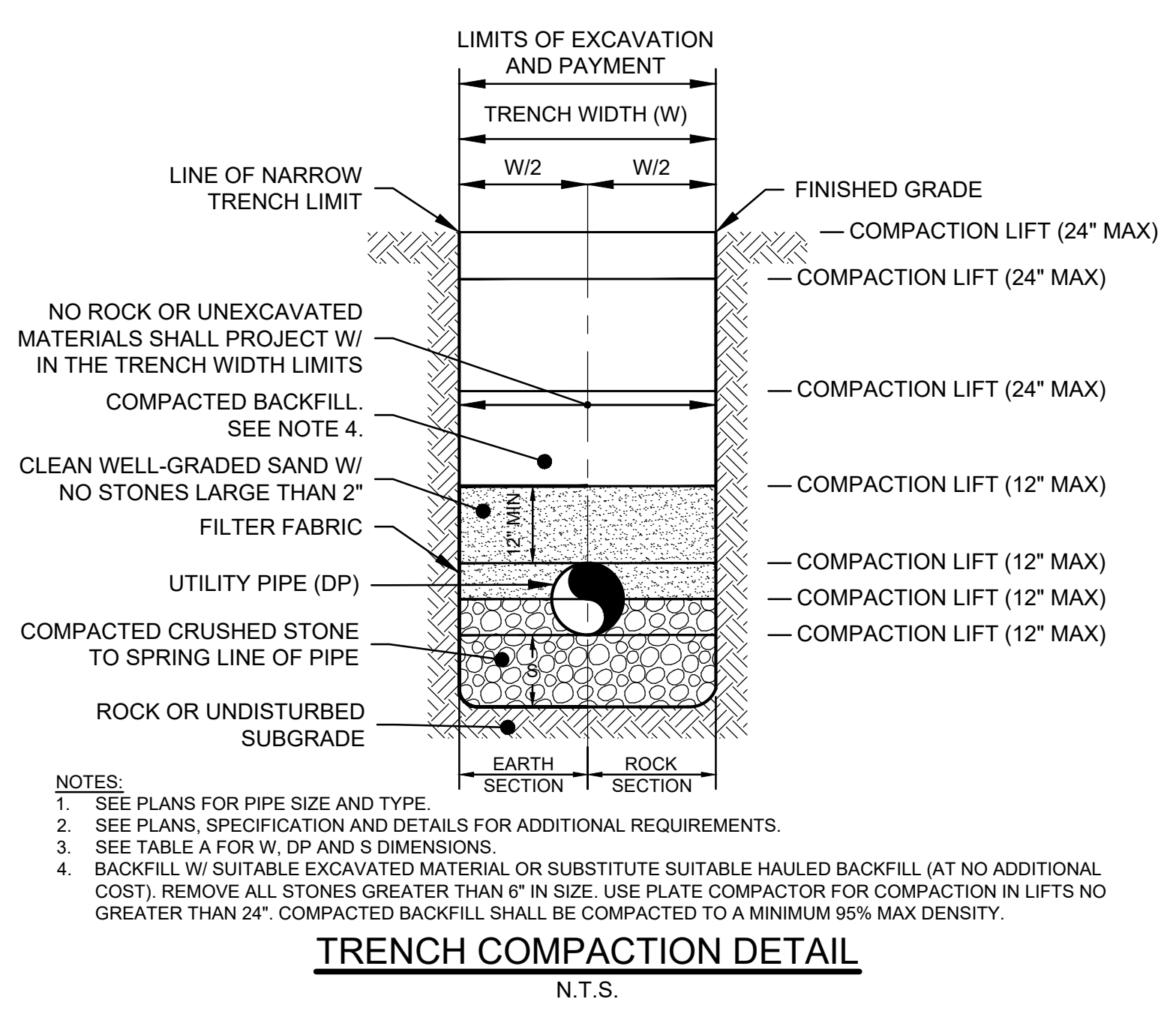
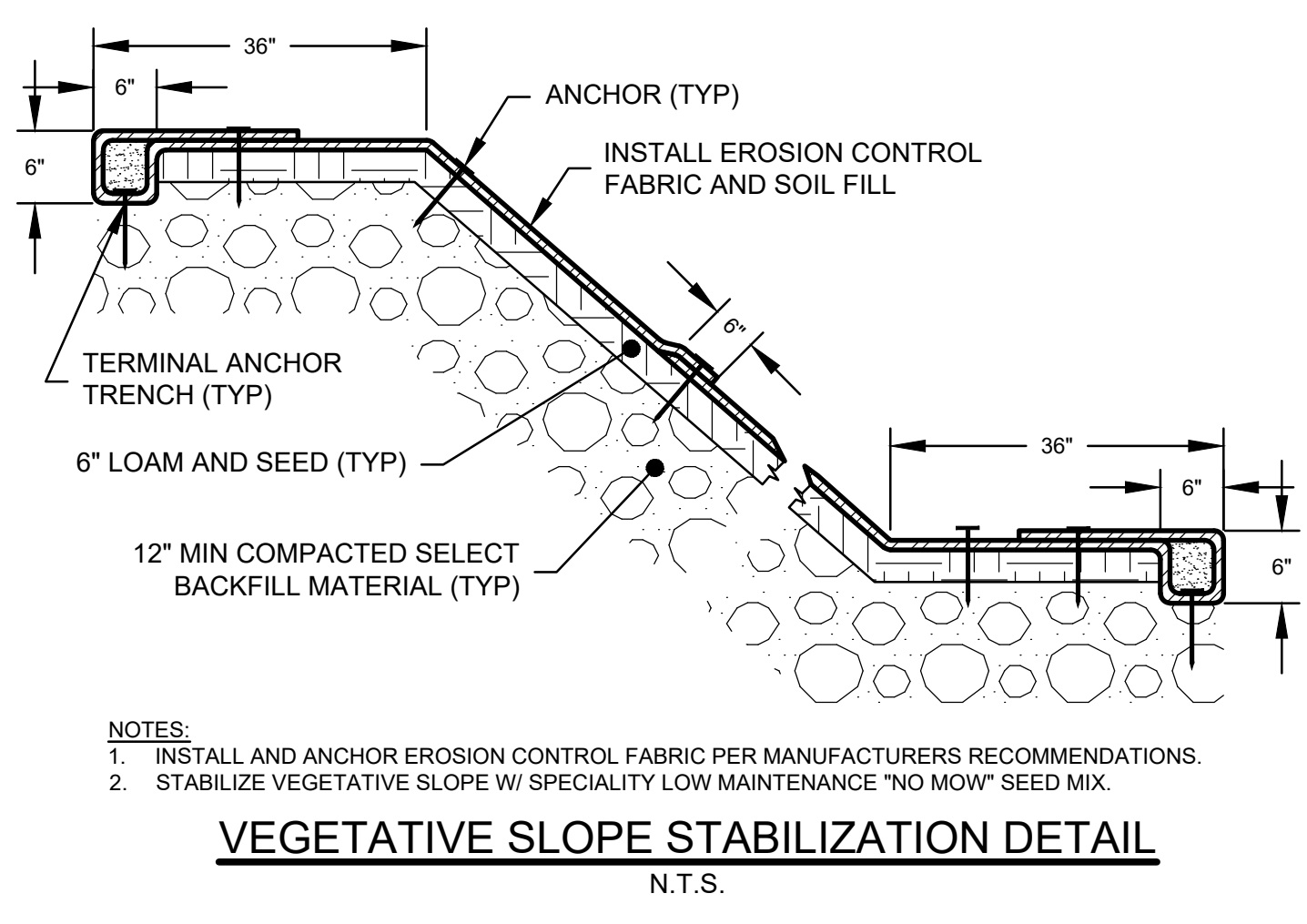
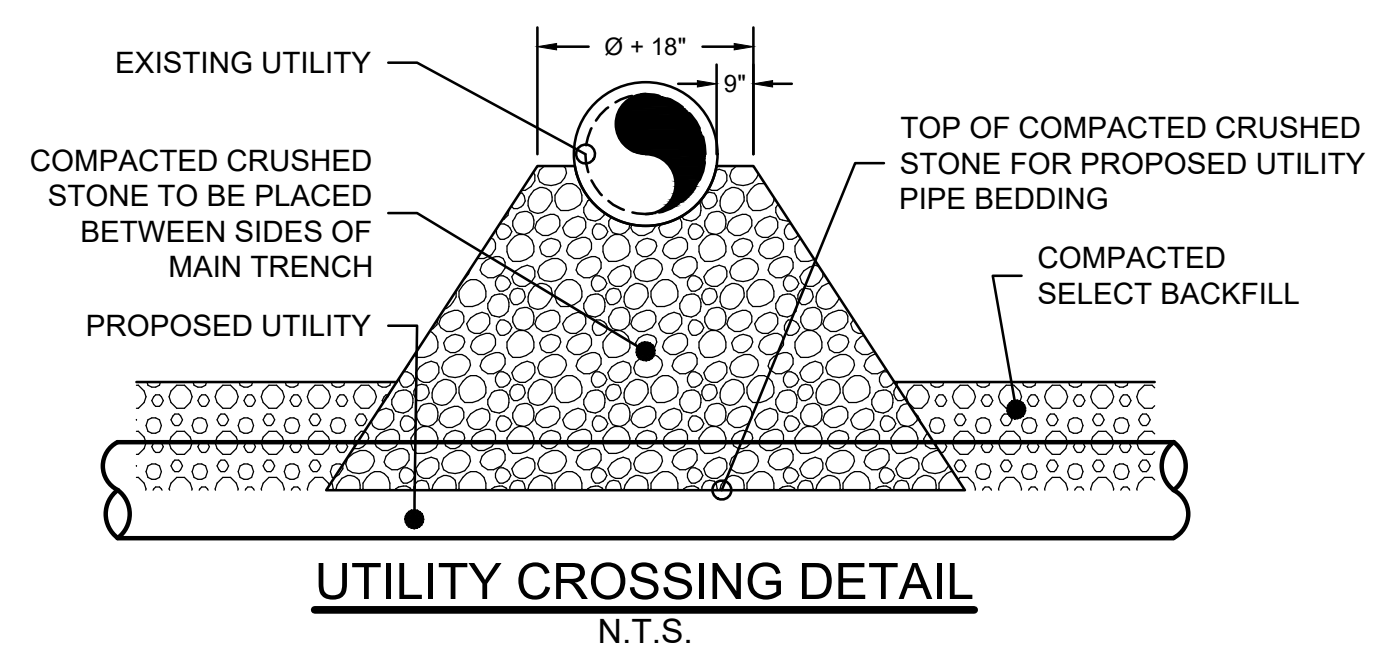
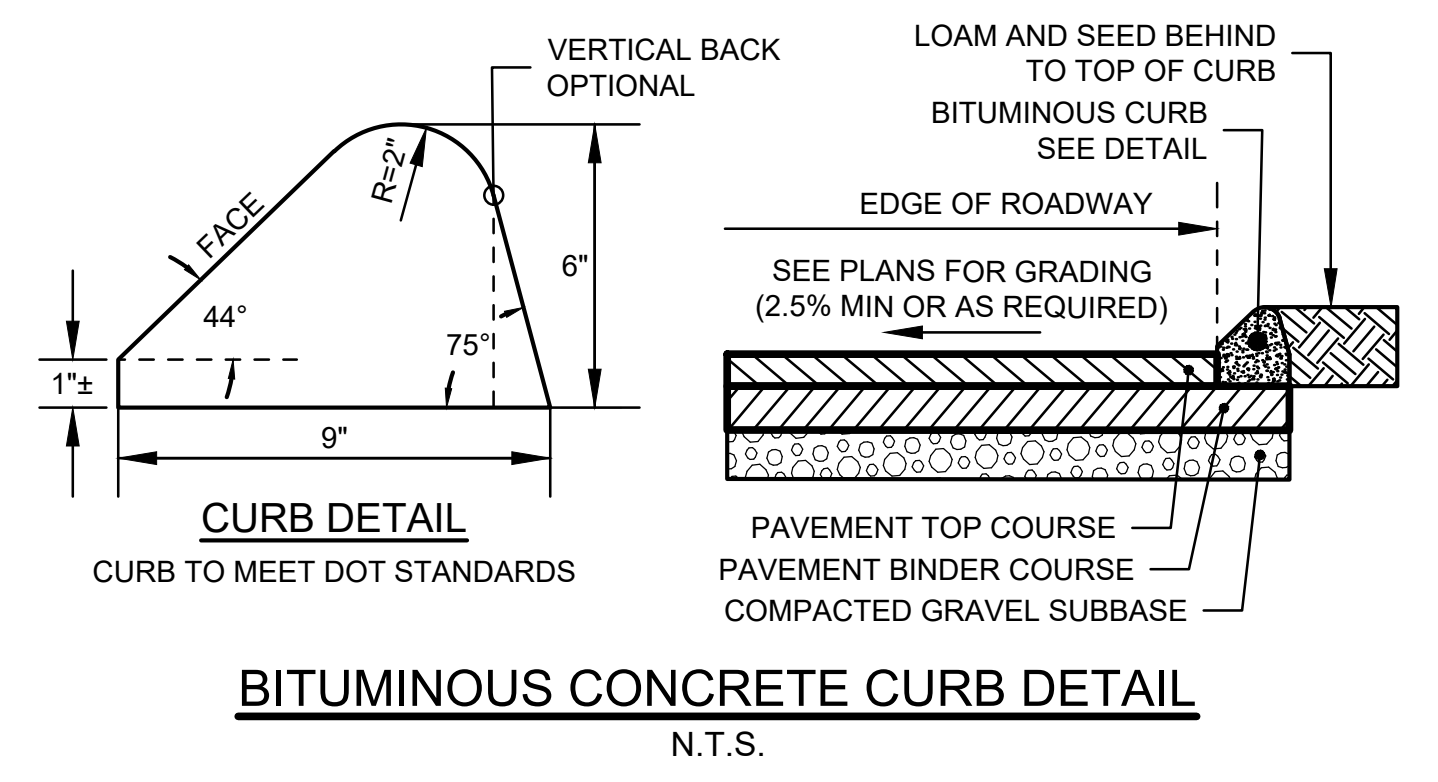
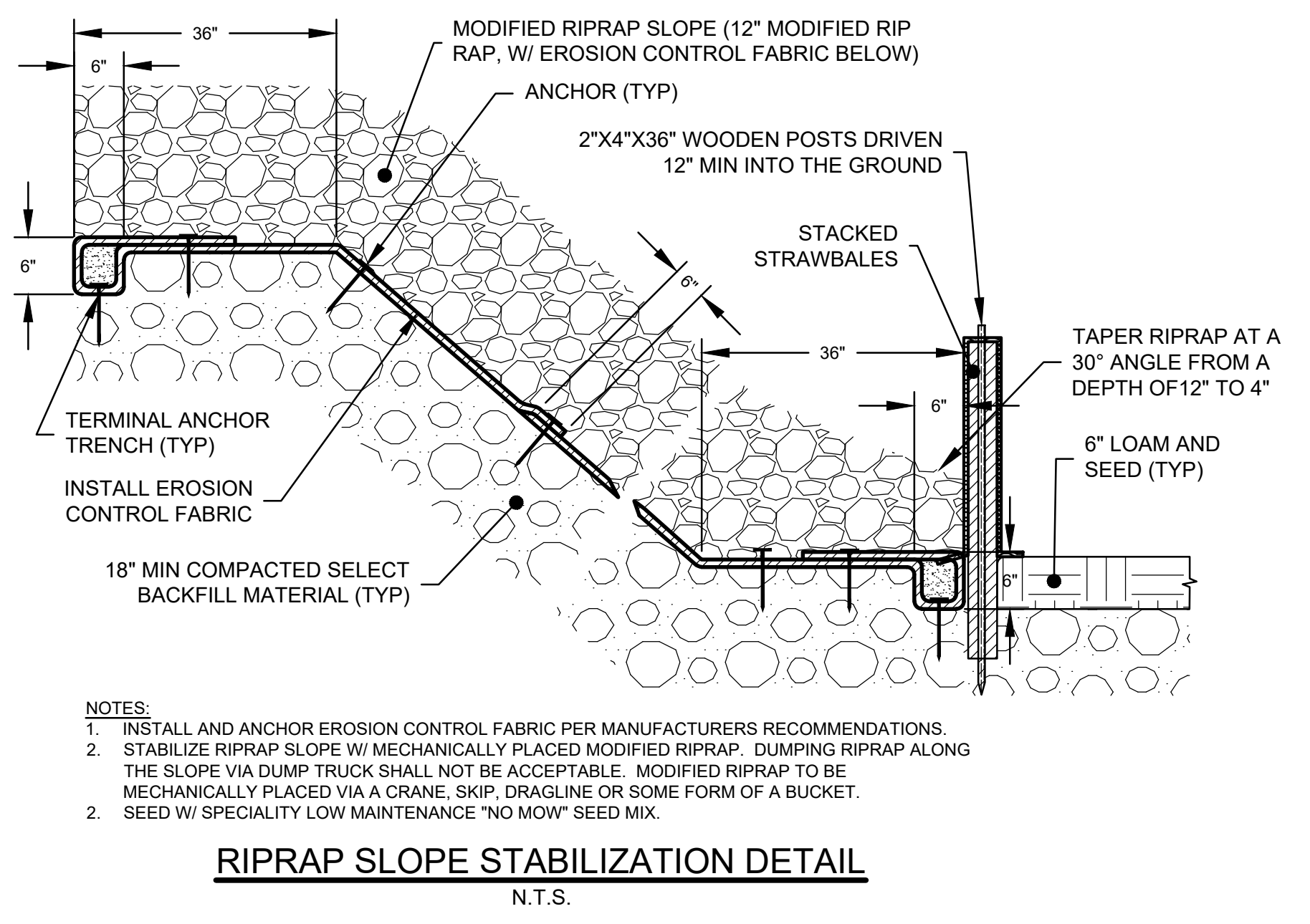
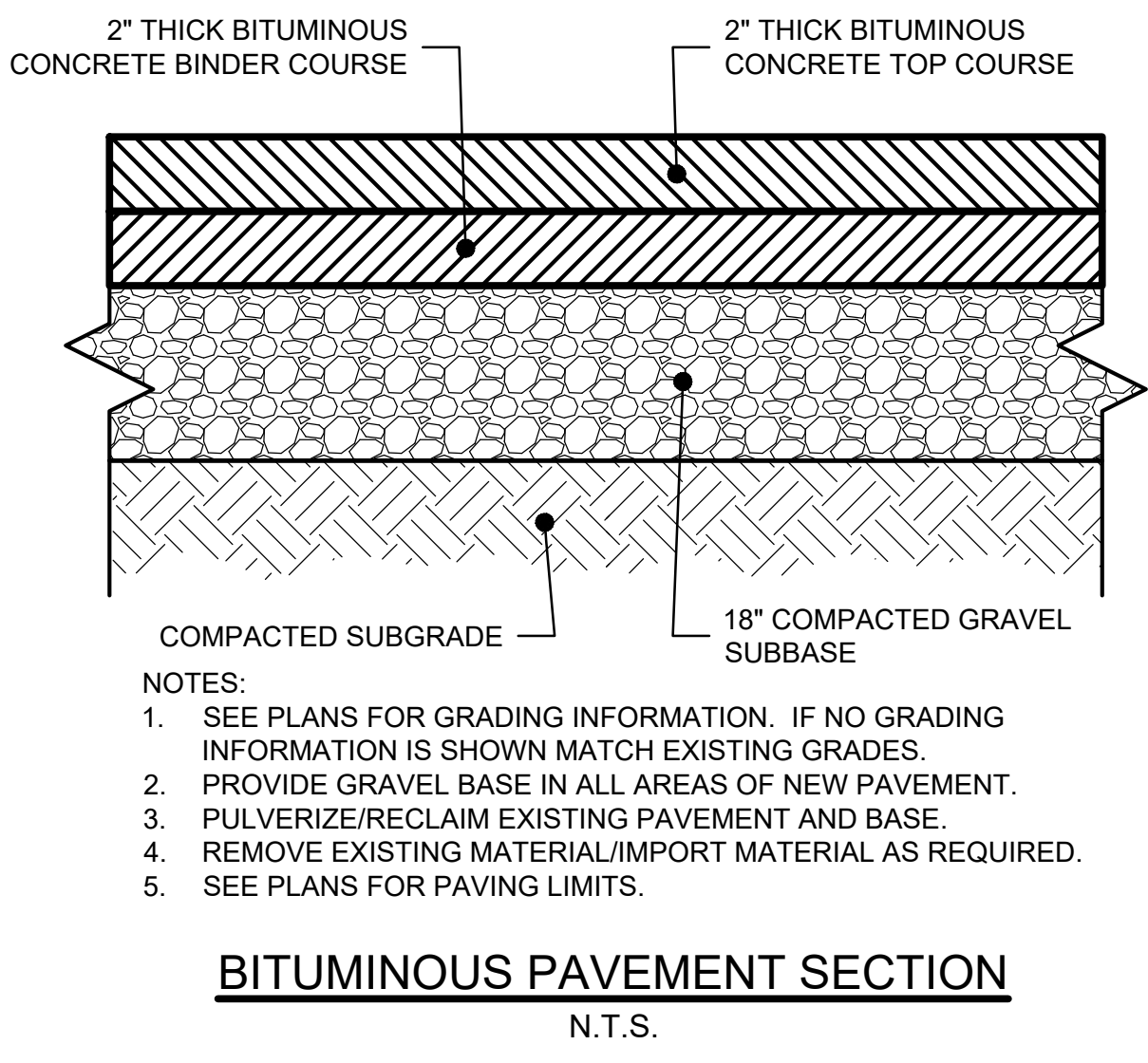
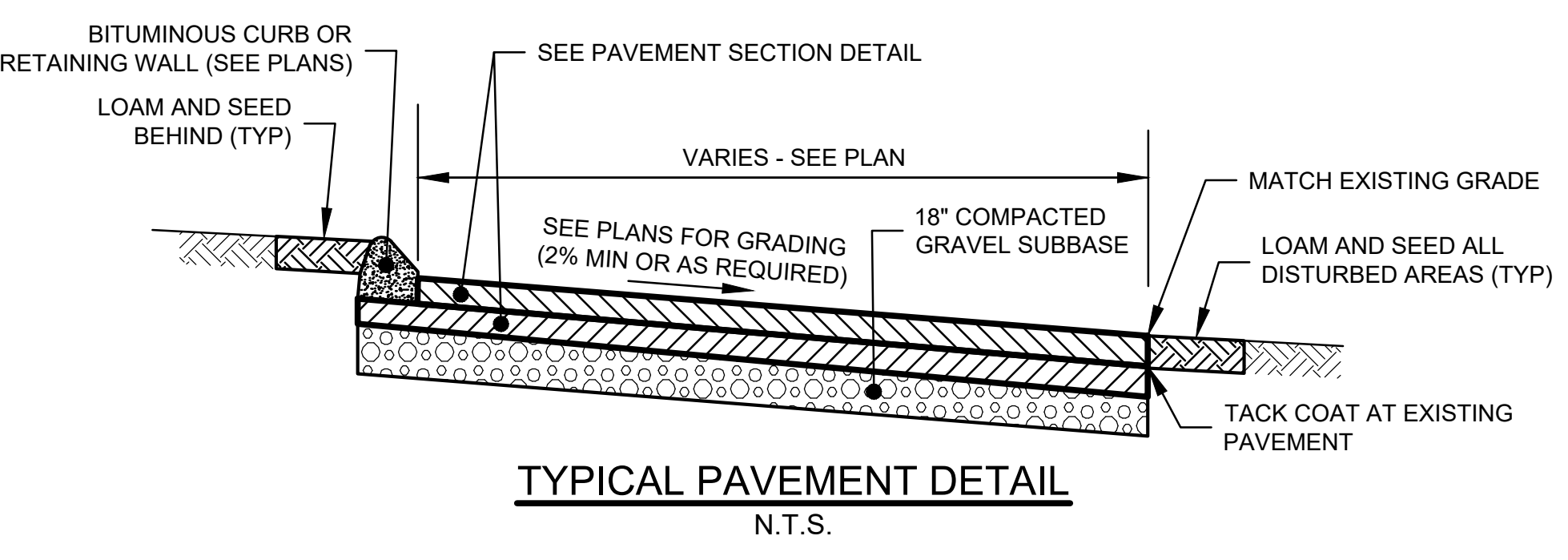

PIPE	MAIN	
	SEWER 'A'	WATER 'A'
WATER	18"	--
DRAIN	12"	12"
SEWER	--	18"

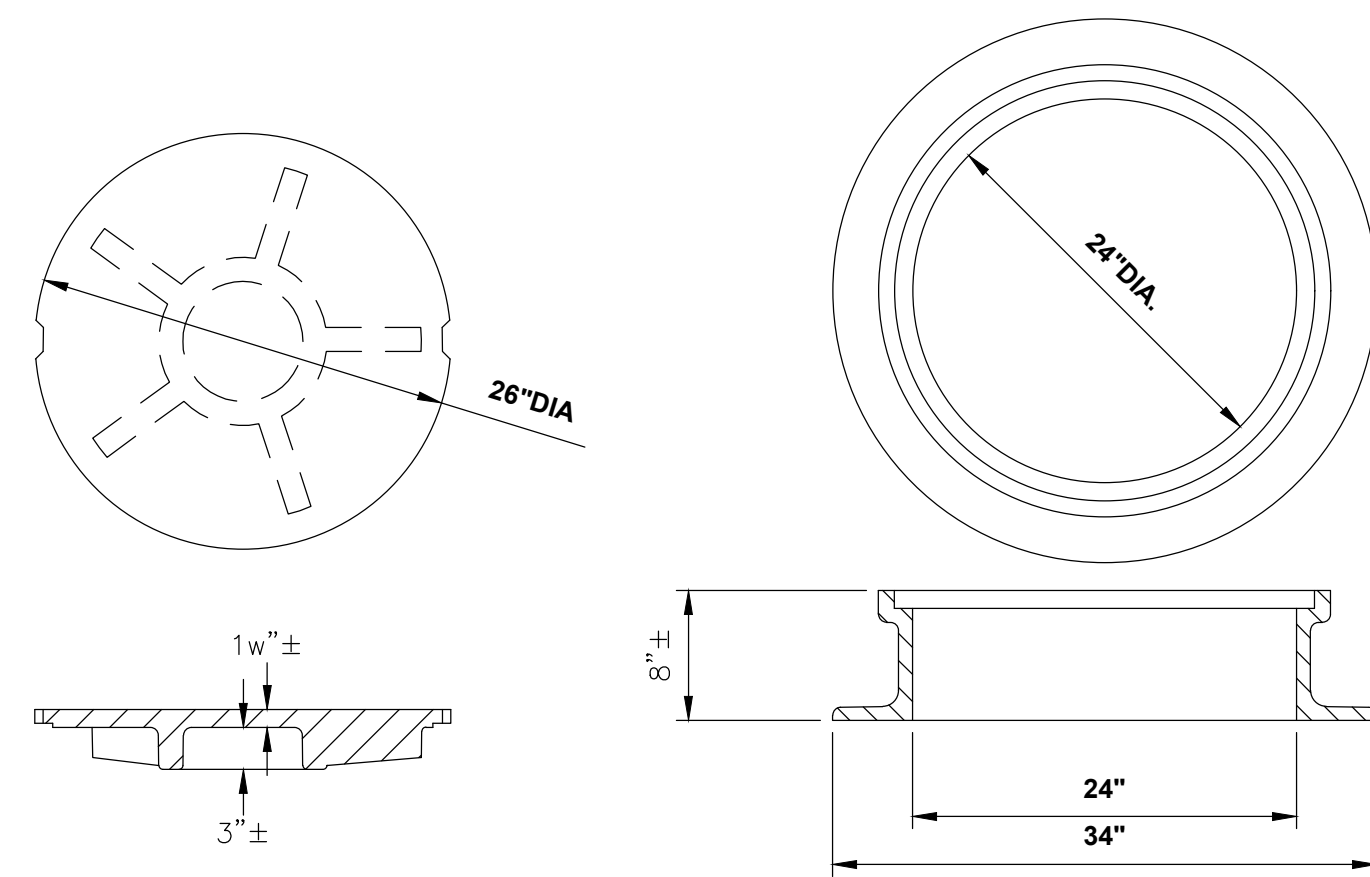

STANDARD MANHOLE COVER
MINIMUM WEIGHT: 200 LBS.

STANDARD MANHOLE FRAME
MINIMUM WEIGHT: 240 LBS.

- NOTES:**
1. FRAME AND COVER SHALL BE PROVIDED FROM THE SAME MANUFACTURER.
 2. LETTERING SHALL BE CAST INTO COVERS AS SPECIFIED.

MANHOLE FRAME & COVER
N.T.S.

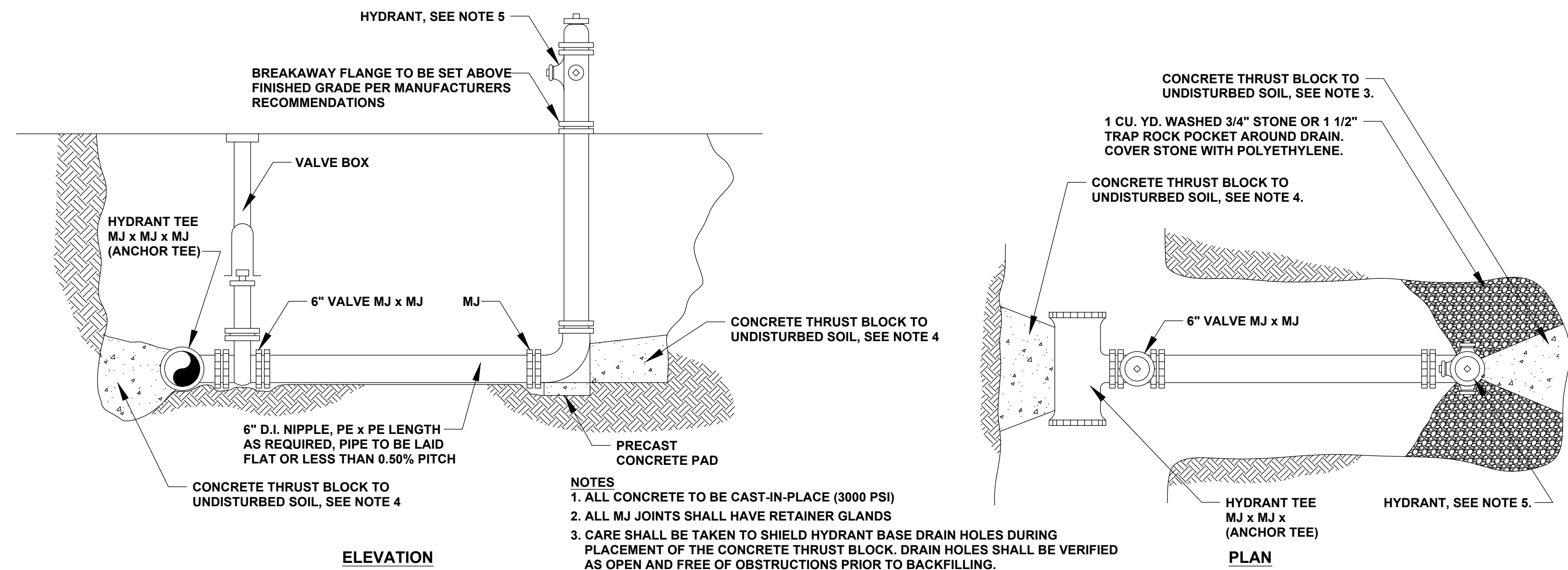

- NOTES**
1. ALL CONCRETE TO BE CAST-IN-PLACE (3000 PSI)
 2. ALL MJ JOINTS SHALL HAVE RETAINER GLANDS
 3. CARE SHALL BE TAKEN TO SHIELD HYDRANT BASE DRAIN HOLES DURING PLACEMENT OF THE CONCRETE THRUST BLOCK. DRAIN HOLES SHALL BE VERIFIED AS OPEN AND FREE OF OBSTRUCTIONS PRIOR TO BACKFILLING.
 4. CARE SHALL BE TAKEN TO SHIELD ALL MECHANICAL JOINT GLANDS AND BOLTS DURING PLACEMENT OF CONCRETE THRUST BLOCK. ALL BOLTS AND GLANDS SHALL BE FREE AND UNOBSTRUCTED BEFORE BACKFILLING.
 5. HYDRANT SHALL BE SET PLUMB. VERTICAL HYDRANT EXTENSIONS SHALL BE USED AS NECESSARY TO PROPERLY LOCATE THE BREAKAWAY FLANGE PER MANUFACTURERS RECOMMENDATIONS.
 6. POLYETHYLENE SHEETING SHALL BE PLACED OVER THE FITTING AND/OR HYDRANT BASE TO PREVENT DIRECT CONTACT OF CONCRETE WITH THE FITTING.
 7. HYDRANTS TO BE DARLING B-84-B OR MUELLER CENTURION.

HYDRANT INSTALLATION
N.T.S.

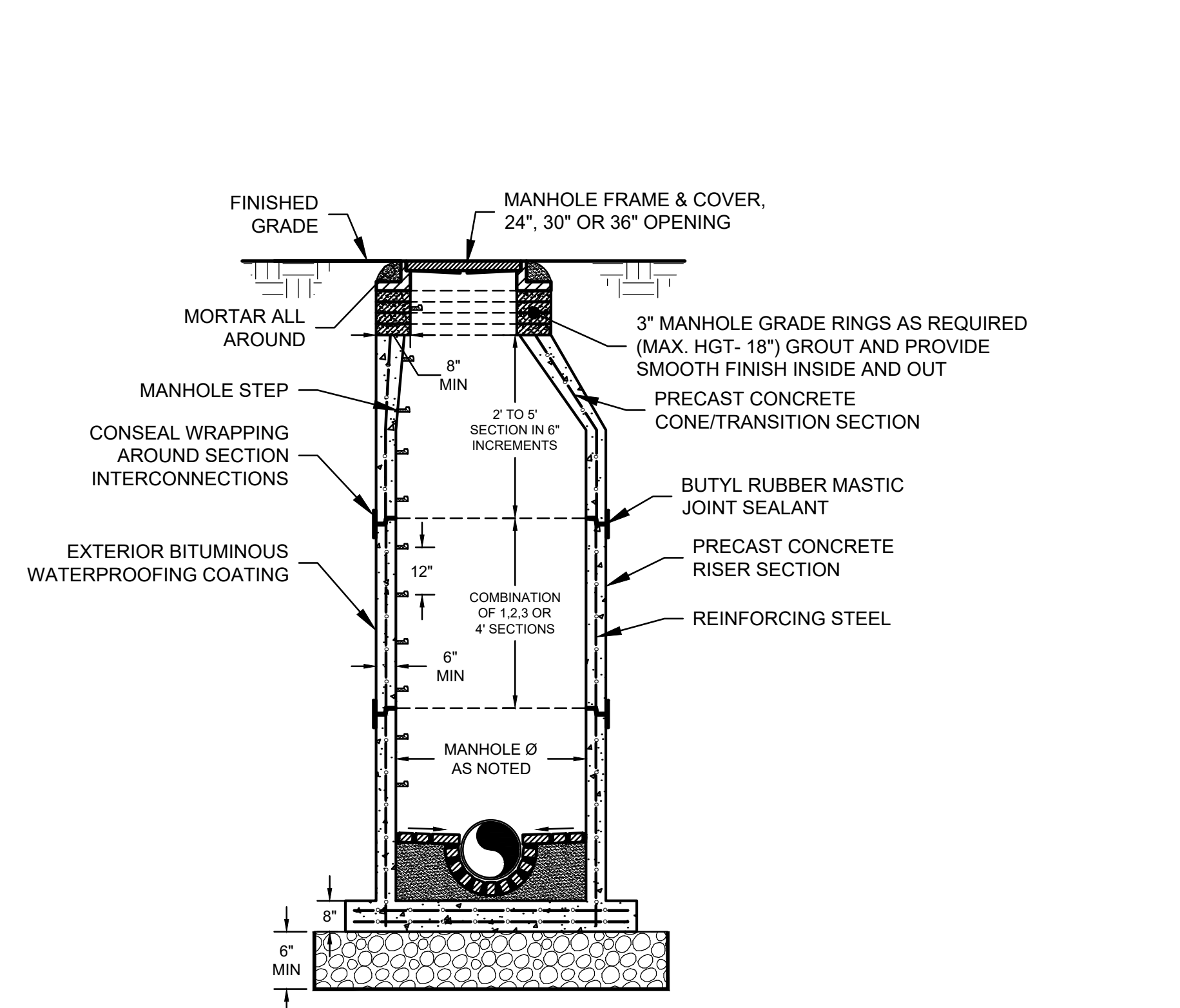

- NOTES:**
1. MINIMUM MANHOLE DIAMETER IS 4FT. DETAIL APPLIES TO 4' AND 5' Ø MANHOLES.
 2. MANHOLE SHALL CONFORM TO LATEST ASTM DESIGNATION C478. CONCRETE COMPRESSIVE STRENGTH-5,000 PSI MINIMUM AT 28 DAYS.
 3. ALL PIPE CONNECTIONS TO MH WALLS SHALL BE CAST-IN FLEXIBLE WATERTIGHT CONNECTORS MANUFACTURED BY PRESS-SEAL GASKET CORPORATION OR APPROVED EQUAL.
 4. MANHOLE STEPS SHALL MEET LATEST OSHA REGULATION 29 CFR 1910.27, SECTION 16 OF ASTM SPECIFICATION C478 AND SECTION 10 ASTM SPECIFICATION C497.
 5. MH BRICK (ASTM C32) SHALL BE GRADE MS OR MM.
 6. ADJUST MANHOLE FRAME AND COVER TO REQUIRED GRADE WITH A MIN OF ONE COURSE AND A MAX OF FIVE COURSES OF REINFORCED CONC. GRADING RINGS.
 7. REINFORCING STEEL WELDED WIRE FABRIC CONFORMS TO LATEST ASTM SPECIFICATION A185.
 8. REINFORCING STEEL DEFORMED BARS CONFORM TO LATEST ASTM SPECIFICATION A615.
 9. DISTANCE FROM TOP OF MANHOLE COVER TO FIRST STEP SHALL BE BETWEEN 12 AND 16".

PRECAST MANHOLE DETAIL
N.T.S.

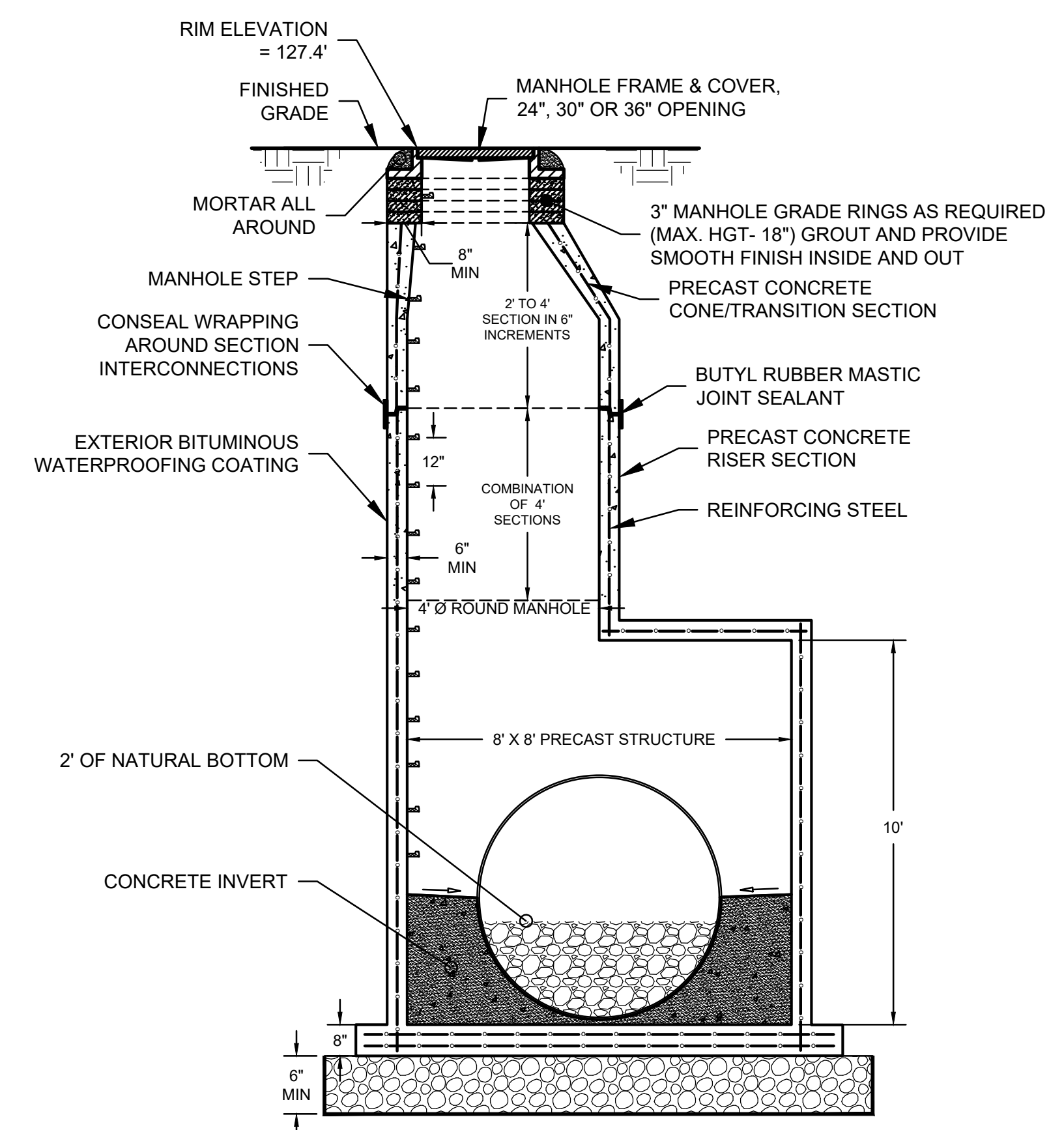

- NOTES:**
1. MANHOLE SHALL CONFORM TO LATEST ASTM DESIGNATION C478. CONCRETE COMPRESSIVE STRENGTH-5,000 PSI MINIMUM AT 28 DAYS.
 2. ALL PIPE CONNECTIONS TO MH WALLS SHALL BE CAST-IN FLEXIBLE WATERTIGHT CONNECTORS MANUFACTURED BY PRESS-SEAL GASKET CORPORATION OR APPROVED EQUAL.
 3. MANHOLE STEPS SHALL MEET LATEST OSHA REGULATION 29 CFR 1910.27, SECTION 16 OF ASTM SPECIFICATION C478 AND SECTION 10 ASTM SPECIFICATION C497.
 4. ADJUST MANHOLE FRAME AND COVER TO REQUIRED GRADE WITH A MIN OF ONE COURSE AND A MAX OF FIVE COURSES OF REINFORCED CONC. GRADING RINGS.
 5. REINFORCING STEEL WELDED WIRE FABRIC CONFORMS TO LATEST ASTM SPECIFICATION A185.
 6. REINFORCING STEEL DEFORMED BARS CONFORM TO LATEST ASTM SPECIFICATION A615.
 7. DISTANCE FROM TOP OF MANHOLE COVER TO FIRST STEP SHALL BE BETWEEN 12 AND 16".

DMH #1 DETAIL - PROFILE
N.T.S.

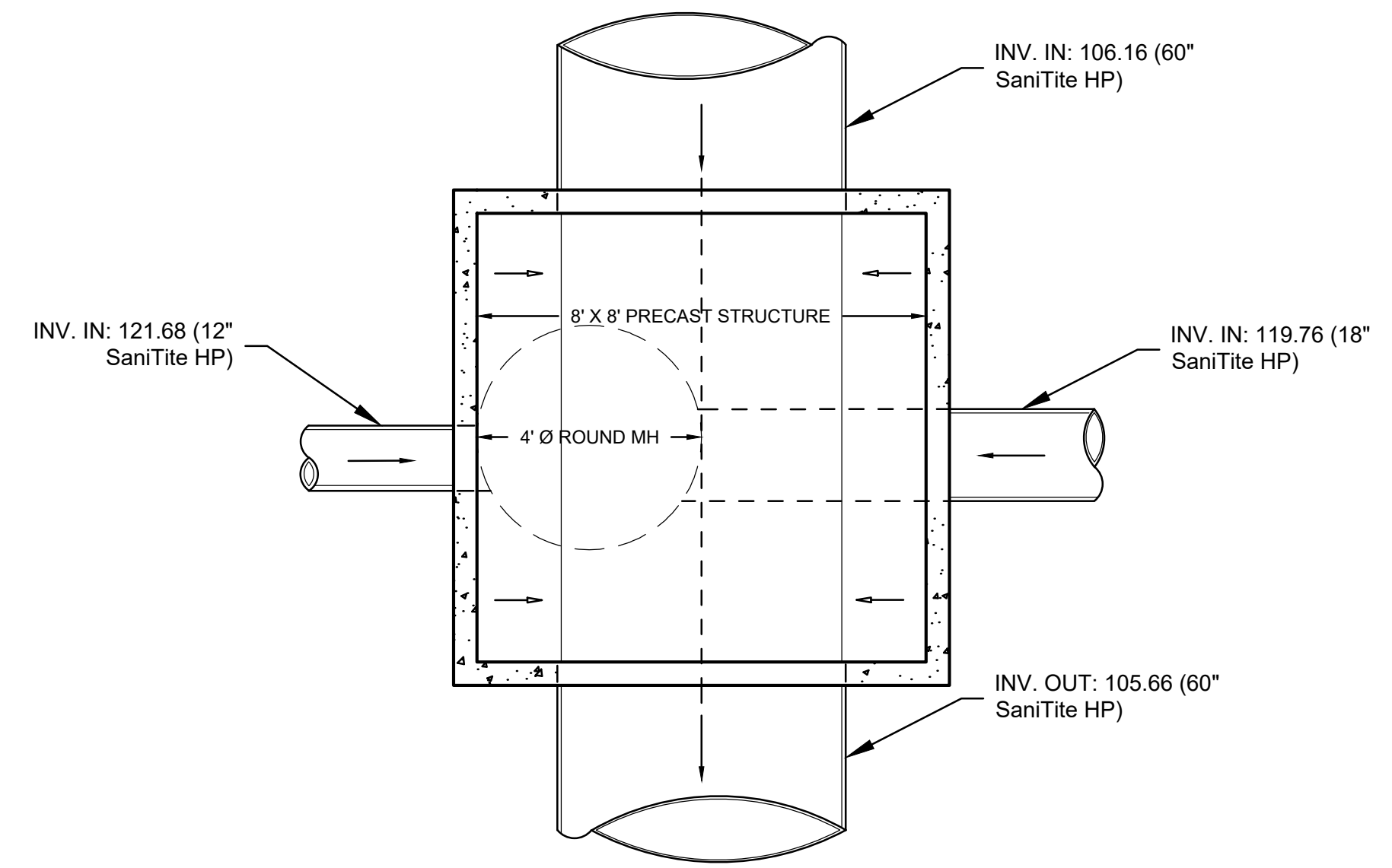

- NOTES:**
1. MANHOLE SHALL CONFORM TO LATEST ASTM DESIGNATION C478. CONCRETE COMPRESSIVE STRENGTH-5,000 PSI MINIMUM AT 28 DAYS.
 2. ALL PIPE CONNECTIONS TO MH WALLS SHALL BE CAST-IN FLEXIBLE WATERTIGHT CONNECTORS MANUFACTURED BY PRESS-SEAL GASKET CORPORATION OR APPROVED EQUAL.
 3. REINFORCING STEEL WELDED WIRE FABRIC CONFORMS TO LATEST ASTM SPECIFICATION A185.
 4. REINFORCING STEEL DEFORMED BARS CONFORM TO LATEST ASTM SPECIFICATION A615.

DMH #1 DETAIL - PLAN
N.T.S.

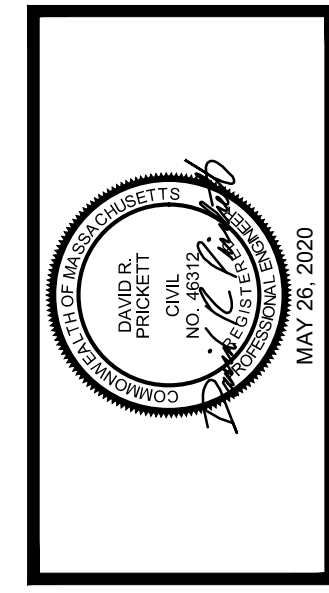
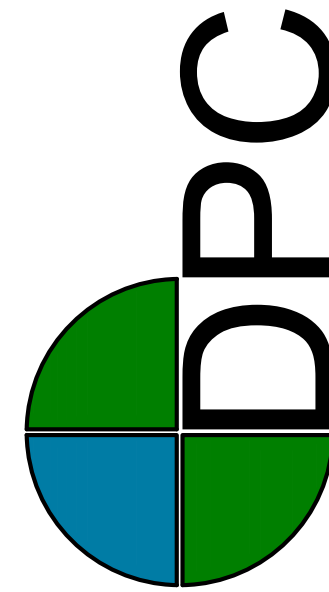

DATE:	5/26/2020
DESCRIPTION:	ISSUED FOR BIDDING
AMID REV:	1
DESIGNED BY:	DRP
CHECKED BY:	DRP
APPROVED BY:	DRP
ISSUED FOR:	1
	2
	3
	4
	5
	6
	7

CIVIL DETAILS SHEET 3
FILE

**MORNINGSIDE DRIVE
CULVERT REPLACEMENT
PROJECT**
DEPARTMENT OF PUBLIC WORKS
LONGMEADOW, MASSACHUSETTS

SCALE:	AS NOTED
SCALE SHEET SIZE:	22X34
JOB NO.:	
DATE:	JUNE 2020
SHEET:	8 OF 8