

INVITATION TO BID
CITY OF LINCOLN PARK, WAYNE COUNTY, MICHIGAN
TREE PURCHASE AND PLANTING

The City of Lincoln Park is accepting sealed bids for the purchase and planting of trees in newly constructed Lion's Park. This project is made possible by the United States Housing and Urban Development Community Development Block Grant (CDBG) funds. The actual amount of award will be determined on a unit cost basis not to exceed the project budget and the final quantity of trees may be reduced or increased upon examination of the bids by the City.

Sealed bids enclosed in envelopes clearly marked "Lion's Park Trees" will be received until 3:00 p.m. (local time), April 29, 2011, by:

Donna Breeding, City Clerk

Sealed Bid -- "Lion's Park Trees"

City of Lincoln Park

1355 Southfield Road

Lincoln Park, Michigan 48146

Bids shall be publicly opened and read at the regularly scheduled City Council meeting at:

7:30 p.m. (local time), May 2, 2011 at the address above.

The City of Lincoln Park reserved that right to waive any irregularity, accept or reject any or all bids, and to accept the proposals that in the City's opinion, are in the best interest of and to the advantage of the City of Lincoln Park. No bidder may withdraw his bid within 90 days after the date of bid opening.

This Project is funded by CDBG and subject to all federal regulations.

TREE PURCHASE AND PLANTING SPECIFICATIONS

Examination of Plans, Specifications and Sites

Trees shall be planted at Lion's Park located between the Ecorse Creek and River Drive at the foot of LeBlanc Street in Lincoln Park. See Park diagram indicating plant locations. Bidders may examine all plans, specifications and sites. No deviation from specifications will be allowed without written consent from the City prior to award of contract. Failure to fully examine project site and work requirements will not relieve bidder from performing work as per plan and specifications.

Insurance and Worker's Compensation

The Contractor shall furnish evidence of Worker's Compensation, public liability and property damage insurance. Limits of insurance shall be as follows: Minimum amounts of \$1,000,000 bodily injury and \$500,000 property damage including both injury and property damage caused by vehicles and machinery. A certificate of insurance shall be filed with the Parks and Recreation Department.

Inspection and Payment

The Purchaser shall inspect work periodically to insure that all specifications are adhered to. In no case shall the final payment be made until the Contractor has complied with all requirements set forth and the Purchaser has made final inspection of the entire work and is satisfied that the entire work is properly and satisfactorily complete per plans, specifications, and ready for Purchaser acceptance.

Completion

All work shall be completed by May 20, 2011, unless otherwise approved as noted in project specifications. Trees shall be planted at Lion's Park located between the Ecorse Creek and River Drive at the foot of LeBlanc Street in Lincoln Park. See Park diagram indicating plant locations.

Guarantee

All work and materials shall be guaranteed in writing as specified in Section 12.

Questions

All questions regarding these specifications shall be directed to Donald T. Cook, Director of Parks and Recreation at (313) 386-1817.

1. Scope

- A. These specifications, including drawings and plant material lists, apply to those items necessary for and incidental to the execution and completion of planting as indicated herein.
- B. All labor, supervision, equipment, materials, and supplies necessary for the execution of the work shall be provided for by the Contractor at no additional cost to the Purchaser.
- C. Reasonable care shall be exercised during excavation, planting, filling, grading, and cleanup, to protect from damage all existing trees, shrubs, and other specified vegetation, and other site features, improvements, structures, and utilities.

2. Applicable Specifications and Standards

- A. **American Standard for Nursery Stock, ANSI Z60.1.** current edition. American Nursery and Landscape Association, 1000 Vermont Ave. NW, Suite 300, Washington, D.C. 20005
- B. **Index of Garden Plants: The New Royal Horticultural Society Dictionary.** By Mark Griffiths. 1994. Timber Press, Inc. Portland OR.
- C. **American National Standard for Tree Care Operations, ANSI A300** –most current edition. International Society of Arboriculture, PO Box 3129, Champaign IL 61826-3129.

3. Materials

- A. A complete list of plants, including a schedule of quantities, sizes, and other requirements is included. In the event that discrepancies occur between quantities of plants indicated in the Plant List, and as indicated on the Drawings, the plant quantities indicated on the List shall govern.

All plant material shall conform to **American Standard for Nursery Stock**. Plants shall be true to species and variety specified and nursery grown in accordance with good horticultural practices under climatic conditions similar to those in the locality of the project for at least 2 years. They shall have been freshly dug (during the most recent favorable harvest season). Plants shall be so trained in development and appearance as to be unquestionably superior in form, compactness, and symmetry. They shall be sound, healthy, vigorous, well branched and densely foliated when in leaf, and free of disease and insect adult eggs, pupae or larvae. They shall have healthy, well-developed root systems and shall be free from physical damage or other conditions that would prevent thriving growth.

Trees with multiple leaders, unless specified, will be rejected. Trees with a damaged, cut, or crooked leader, included bar, abrasion of bark, sunscald, disfiguring knots, insect damage, mold, prematurely opened buds, or cuts of limbs over ¼ inch (2cm) diameter that are not completely callused are cause for rejection.

Balled and burlapped plants shall be dug with solid balls of standard size, the balls securely wrapped with non-synthetic, untreated, biodegradable burlap, and tightly bound with non-synthetic, biodegradable rope or twine. Alternatively they may be placed in wire basket lined with non-synthetic, untreated, biodegradable burlap and tightly bound with non-synthetic, biodegradable rope or twine. Root collar shall be apparent at surface of ball. Bare root plants shall have a healthy, well branched root system characteristic of the species and with adequate spread.

Caliper measurements shall be taken on the trunk 6 inches above the root collar. Plants that meet measurements but do not possess a normal balance between height and spread shall be rejected.

Substitutions of plant materials will not be permitted unless authorized in writing by the Purchaser. If proof is submitted, substantiated in writing, that a plant specified is not obtainable, consideration will be given to the nearest available size or similar variety, with a corresponding adjustment of the contract price.

- B. All plants shall be labeled by size and scientific plant name as listed in the current edition of **Index of Garden Plants**. Labels shall be attached securely to all plants when delivered. Plant labels shall be durable and legible, with information given in weather-resistant ink or embossed process lettering.
- C. Mulching material shall consist of aged or composted wood chips or shredded bark and shall be free of material injurious to plant growth. Wood chips shall be 1/8 inch nominal thickness with at least 50 percent having an area of not less than 1 square inch and no piece having an area of more than 6 square inches.

- D. Water shall be provided by the Contractor and suitable for irrigation and free from ingredients harmful to plant life.

4. Certification

- A. All plant materials, shipments, and deliveries shall comply with state and federal laws and regulations governing the inspection, shipping, selling, and handling of plant stock. A certificate of inspection, or a copy thereof, for injurious insects, plant diseases, and other plant pests shall accompany each shipment or delivery of plant material. The certificate shall bear the name and address of the source of the stock.

5. Selection and Tagging

- A. Plants shall be inspected upon delivery, and the Purchaser reserves the right to reject any plants that do not meet the standards or that have been damaged during shipment. Such approval shall not impair the right of inspection and rejection during progress of the work.
- B. A Contractor's representative shall be present at all inspections.
- C. The Purchaser shall be the sole judge of acceptability of stock at any time during the course of this contract.

6. Digging and Handling Plant Materials

- A. Plants to be balled-and-burlapped shall be dug with firm, natural balls of earth of diameter not less than that recommended in the current edition of *American Standard for Nursery Stock*, and of sufficient depth to include fibrous and feeding roots. The root collar shall be within the top 2" of the soil ball. Balled and burlapped plants with manufactured balls or balls that are dry, cracked, or broken before or during planting operation will not be accepted.

7. Transportation and Storage of Plant Material

- A. Fresh dug material is given preference over plant material held in storage. Plant material held in storage will be rejected if excessive growth or dieback of branches has occurred in storage.
- B. Branches shall be tied with rope or twine only, and in such a manner that no damage will occur to the bark or branches.
- C. During transportation of plant material, the Contractor shall exercise care to prevent injury and drying out of the trees. Should the roots be dried out, large branches broken, balls of earth broken or loosened, or areas of bark torn, the City Representative may reject the injured tree(s) and order them replaced at no additional cost to the Purchaser.
- D. Plants must be protected at all times from sun or drying winds; Those that cannot be planted immediately on delivery shall be kept in the shade, well protected with soil covered with wood chips or other acceptable material, and kept well watered. Plants shall not remain unplanted any longer than 3 days after delivery without permission from the Purchaser. Plants shall not be bound with wire or rope at any time so as to damage the bark or break branches. Plants shall be lifted and handled with suitable support of the soil ball to avoid damaging it.

8. Excavation of Planting Areas

- A. Note: Lion's Park has been capped with 24" of clay to contain possible contaminants. Contractor shall take due care to capture all excavated soil beyond this depth. Contractor shall deposit these soils on site at a predetermined location and cover with 24" of clay.
- B. The Purchaser will mark with paint each tree location. The Contractor will notify Digger's Hotline to verify location of underground utilities before excavation begins. The Contractor shall be responsible for assuring

- that utility marking is complete before excavation begins. The Contractor shall be responsible for all damage resulting from neglect or failure to comply with this requirement.
- C. The Contractor shall excavate planting areas as shown on the drawings. Excavation may be done by shovel or backhoe, but a soil auger may not be used. The planting hole shall be 2 times the diameter of the soil ball. The soil pad on which the soil ball or root ball will be placed shall be of undisturbed soil. The depth of the pad shall correspond to the distance from the bottom of the soil ball to the root collar, or slightly less.
- D. Excavated planting holes that will be left open when work is not in progress or pose an immediate and considerable hazard to pedestrians or vehicles shall be adequately barricaded with appropriate warning devices.
- E. The Contractor shall notify the Purchaser, in writing, of soil conditions or other obstructions the Contractor considers detrimental to tree growth. Such conditions shall be described, as well as suggestions for correcting them. Proper water drainage must be assured.
- F. Where soil conditions or below ground obstructions which cannot be remedied are encountered, the Purchaser shall designate alternate planting locations. The Purchaser shall bear any costs associated with such relocation.

9. Planting Operations

- A. Plants must be protected from excessive vibrations. Plants shall not be thrown or bounced off a truck or loader to the ground. Plants shall not be dragged, lifted, or pulled by the trunk or foliage parts in a manner that will loosen the roots in the ball.
- B. Plants shall be set with the top of the root collar at or slightly above finished grade. Plants must be centered in the hole and set plumb. Plants shall be set so that they will be at the same depth 1 year after planting.
- C. Removal of ropes, strings, wire baskets, burlap, and other wrappings from B&B plants: After the plant has been set and one half of the backfilling completed to support the ball, ropes, strings, wire baskets, burlap, and other wrappings shall be removed from the top one-half of the ball. The balance of the wrappings may be left intact around the bottom half of the ball. If the root collar is deep in the ball, remove excess soil away from the trunk using hands, not tools.
- D. Planting holes shall be backfilled with excavated soil. When holes are approximately two-thirds full, they shall be thoroughly watered to eliminate air pockets. After this initial watering, excavated soil shall be installed to the top of the hole and watered. Prevent puddled soil conditions by avoiding compaction once the soil is wet.
- E. Planting areas shall be finish-graded to conform to drawings after full settlement has occurred.
- F. All plants shall be mulched over the root system with a 3-4 inch layer of aged wood chips or bark immediately after planting. Mulching material shall be pulled back no less than 3" and no more than 6" from the trunk.
- G. Plants shall be thoroughly watered immediately after planting.
- H. All twine, rope, transit guards or wrappings, and plant labels secured around the trunk or branches shall be removed after planting is completed.

10. Cleanup

- A. Soil, branches, binding and wrapping material, rejected plants, or other debris resulting from any tree planting shall be promptly cleaned up and removed. The work area shall be kept safe and neat at all times until the cleanup operation is completed. Under no condition shall the accumulation of soil, branches, or other debris be allowed upon a public property in such a manner as to result in a public hazard.

11. Acceptance

- A. The Purchaser shall perform an inspection with the Contractor of all plant material after the original planting to note and correct any discrepancies.
- B. Acceptance of plant material by the Purchaser shall be for general conformity to specified size, character, and quality and shall not relieve the Contractor of responsibility for full conformity to the contract documents, including correct species.
- C. Upon completion and re-inspection of all repairs or renewals necessary in the judgment of the Purchaser, the Purchaser shall certify in writing that the work has been accepted.

12. Guarantee Period and Replacement

- A. The Contractor shall guarantee all plants to be healthy and in flourishing condition for one year from the date of acceptance.
- B. The Contractor shall remove and replace, without cost, and as soon as weather conditions permit, and within a specified planting period, all plants not in a healthy and flourishing condition as determined by the Purchaser any time during the guarantee period. Replacements shall be subject to all requirements stated in this specification.

TREES - PURCHASE AND PLANTING - ITEMIZED BID SHEET

Quotes below are for:

Trees balled in burlap, minimum 2" in diameter measured 6" above the root collar, planted using best practices standards, mulched over the root system, fertilized and watered.

All trees shall be guaranteed for one year after the date of planting.

DESCRIPTION	ESTIMATED AMOUNT	UNIT	UNIT PRICE IN FIGURES	UNIT PRICE IN WORDS	AMOUNT
Kousa Dogwood "Cornus Kousa"	1	EA			
Commemoration Sugar Maple "Acer Saccharum"	2	EA			
Saucer Magnolia (Magnolia x Soulangiana) "Alexandria"	1	EA			
Prairiefire Crabapple "Malus x Prairiefire"	4	EA			
Centurion Crab apple "Malus x Centurion"	4	EA			
Aristocrat Pear (Pyrus Calleryana "Aristocrat")	8	EA			
Silver Shadow Linden (Tilia Tomentosa "Sashuzam")	4	EA			

Total Bid in Words: _____

Total Bid in Figure: \$ _____

Insurance Requirements

The successful bidder must provide the City of Lincoln Park with appropriate insurance documentation.

Bidders Qualifications

All bidders must supply the City of Lincoln Park with satisfactory evidence that they have been regularly engaged in this type of work and they are prepared with the necessary labor, materials and equipment to execute work to the satisfaction of the Purchaser. This evidence includes a reference list including name, address, phone number and description and dates of completed projects located within a 20 mile radius of Lincoln Park.

COMPANY NAME: _____ **Phone:** _____

ADDRESS: _____ **Fax:** _____ **Email:** _____

BIDDER'S REPRESENTATIVE: _____

SIGNATURE: _____ **DATE:** _____

DM - Dogwood

M - Magnolia

L - Linden

SM - Sugar Maple

P - Pear

C - Crab apple

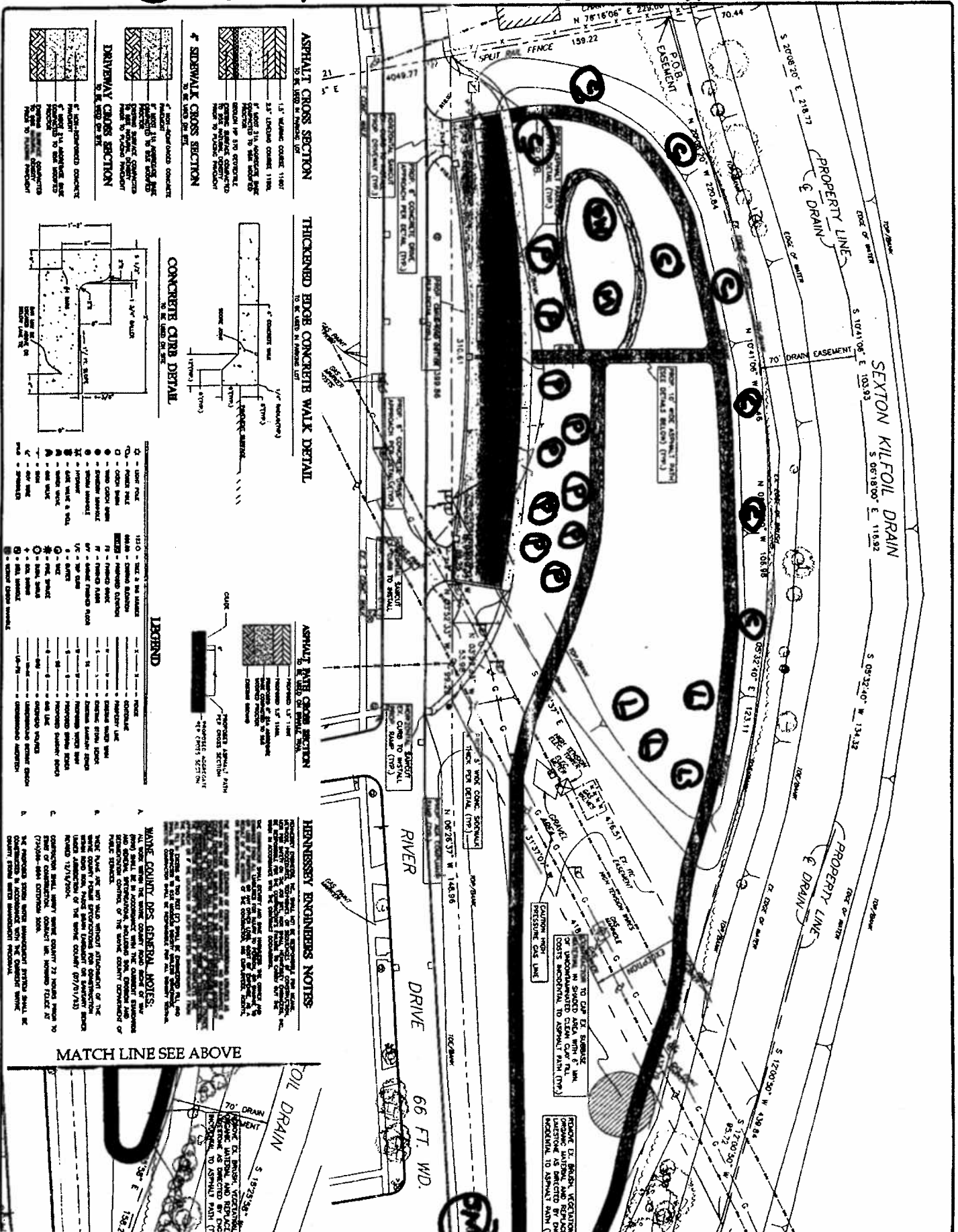

MATCH LINE SEE ABOVE

66 FT. WD.

HENNESSY ENGINEERS NOTES

1. THE DRIVEWAY SHALL BE CONSTRUCTED IN ACCORDANCE WITH THE SPECIFICATIONS OF THE STATE OF MISSISSIPPI, LATEST EDITION.

2. THE DRIVEWAY SHALL BE CONSTRUCTED WITH A 1.5" THICK CONCRETE BASE AND A 2.5" THICK ASPHALT SURFACE.

3. THE DRIVEWAY SHALL BE CONSTRUCTED WITH A 4" THICK CONCRETE CURB.

4. THE DRIVEWAY SHALL BE CONSTRUCTED WITH A 4" THICK CONCRETE CURB.

5. THE DRIVEWAY SHALL BE CONSTRUCTED WITH A 4" THICK CONCRETE CURB.

6. THE DRIVEWAY SHALL BE CONSTRUCTED WITH A 4" THICK CONCRETE CURB.

7. THE DRIVEWAY SHALL BE CONSTRUCTED WITH A 4" THICK CONCRETE CURB.

8. THE DRIVEWAY SHALL BE CONSTRUCTED WITH A 4" THICK CONCRETE CURB.

9. THE DRIVEWAY SHALL BE CONSTRUCTED WITH A 4" THICK CONCRETE CURB.

10. THE DRIVEWAY SHALL BE CONSTRUCTED WITH A 4" THICK CONCRETE CURB.

11. THE DRIVEWAY SHALL BE CONSTRUCTED WITH A 4" THICK CONCRETE CURB.

12. THE DRIVEWAY SHALL BE CONSTRUCTED WITH A 4" THICK CONCRETE CURB.

13. THE DRIVEWAY SHALL BE CONSTRUCTED WITH A 4" THICK CONCRETE CURB.

14. THE DRIVEWAY SHALL BE CONSTRUCTED WITH A 4" THICK CONCRETE CURB.

15. THE DRIVEWAY SHALL BE CONSTRUCTED WITH A 4" THICK CONCRETE CURB.

16. THE DRIVEWAY SHALL BE CONSTRUCTED WITH A 4" THICK CONCRETE CURB.

17. THE DRIVEWAY SHALL BE CONSTRUCTED WITH A 4" THICK CONCRETE CURB.

18. THE DRIVEWAY SHALL BE CONSTRUCTED WITH A 4" THICK CONCRETE CURB.

19. THE DRIVEWAY SHALL BE CONSTRUCTED WITH A 4" THICK CONCRETE CURB.

20. THE DRIVEWAY SHALL BE CONSTRUCTED WITH A 4" THICK CONCRETE CURB.

WAIVE COUNTY DEPT. GENERAL NOTES

1. THE DRIVEWAY SHALL BE CONSTRUCTED IN ACCORDANCE WITH THE SPECIFICATIONS OF THE STATE OF MISSISSIPPI, LATEST EDITION.

2. THE DRIVEWAY SHALL BE CONSTRUCTED WITH A 1.5" THICK CONCRETE BASE AND A 2.5" THICK ASPHALT SURFACE.

3. THE DRIVEWAY SHALL BE CONSTRUCTED WITH A 4" THICK CONCRETE CURB.

4. THE DRIVEWAY SHALL BE CONSTRUCTED WITH A 4" THICK CONCRETE CURB.

5. THE DRIVEWAY SHALL BE CONSTRUCTED WITH A 4" THICK CONCRETE CURB.

6. THE DRIVEWAY SHALL BE CONSTRUCTED WITH A 4" THICK CONCRETE CURB.

7. THE DRIVEWAY SHALL BE CONSTRUCTED WITH A 4" THICK CONCRETE CURB.

8. THE DRIVEWAY SHALL BE CONSTRUCTED WITH A 4" THICK CONCRETE CURB.

9. THE DRIVEWAY SHALL BE CONSTRUCTED WITH A 4" THICK CONCRETE CURB.

10. THE DRIVEWAY SHALL BE CONSTRUCTED WITH A 4" THICK CONCRETE CURB.

11. THE DRIVEWAY SHALL BE CONSTRUCTED WITH A 4" THICK CONCRETE CURB.

12. THE DRIVEWAY SHALL BE CONSTRUCTED WITH A 4" THICK CONCRETE CURB.

13. THE DRIVEWAY SHALL BE CONSTRUCTED WITH A 4" THICK CONCRETE CURB.

14. THE DRIVEWAY SHALL BE CONSTRUCTED WITH A 4" THICK CONCRETE CURB.

15. THE DRIVEWAY SHALL BE CONSTRUCTED WITH A 4" THICK CONCRETE CURB.

16. THE DRIVEWAY SHALL BE CONSTRUCTED WITH A 4" THICK CONCRETE CURB.

17. THE DRIVEWAY SHALL BE CONSTRUCTED WITH A 4" THICK CONCRETE CURB.

18. THE DRIVEWAY SHALL BE CONSTRUCTED WITH A 4" THICK CONCRETE CURB.

19. THE DRIVEWAY SHALL BE CONSTRUCTED WITH A 4" THICK CONCRETE CURB.

20. THE DRIVEWAY SHALL BE CONSTRUCTED WITH A 4" THICK CONCRETE CURB.

